

calendar: lost wed 9-0-07 (3 yrs old)

Augmented  
FOURTH

- Bulky Code Manual (stop to close books) 001, 116.
- 006 Quarry Tripdoor 1-T-05
- 001 Notion Construction Office: 1-N-05 (Plaque Fund; Mulloy)
- 002 Wheelbarrow 1-P-05
- 003 Quarry Rock Elevator: 1-Q-05
- 004 Bed: 1-R-05 (Papoozen) — made from granite
- 005 Ladder: 1-S-05 (for access to surface)
- 007 Bed: 1-U-05 (made from timber)
- 008 Locker Key: 1-Y-05
- 009 Plaque molds: 1-W-05
- 010 Metal Chain: 1-X-05 (for door)
- 011 Armadillo Trap: 1-Y-05
- 012 Rain Gadge: 1-Z-05 (for Leonine)
- 013 Umbrella: 2-A-05 (for Finney)
- 014 Midway Drain: 2-B-05 (toffee?)
- 015 Midway Drain Grate: 2-D-05 (prevent armadillos from clogging waterways)
- 016 Quarry Wall: 2-E-05
- 114 Granite Crate: 9-S-07 (lost ring near granite)

cashier in lab → voice say: "The secrets to fame + beyond for those who will glock at the pond"  
 glock at pond → The guard of the gate meets the trooper at band.  
 When the guard is gone, a prize you'll have, if at the gate you abdicate.

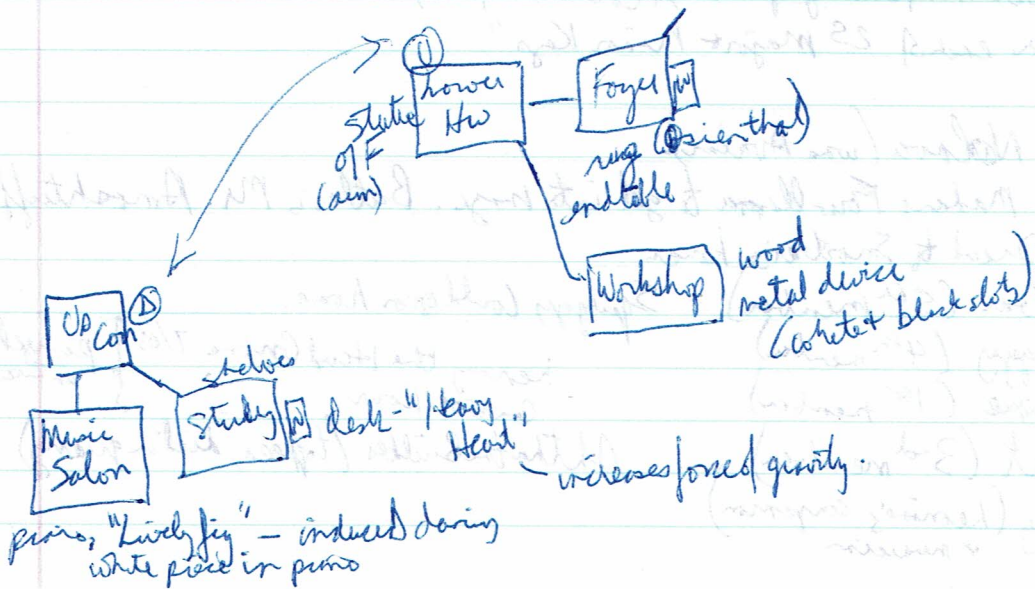

prize, "Lively jig" — induced during white piece in prison

increases force of gravity.

Mulloy



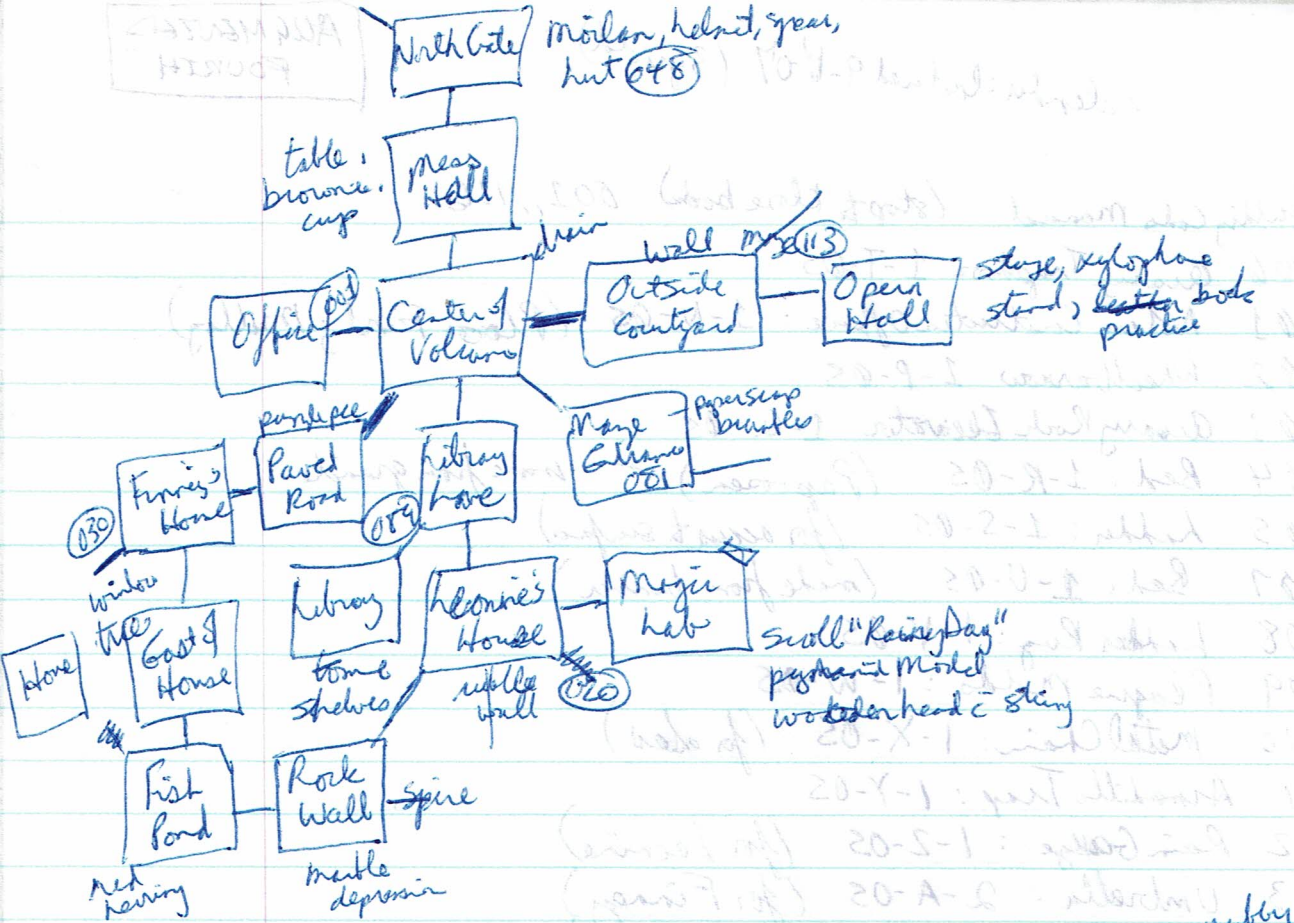

XXXXX  
 XXXXX  
 \*XXXXX  
 XXXXX  
 \*XXXXX

flyer on shelf  
 in library

put black piece in rubble  
 shoot slingshot at window  
 (use rubble)  
 device → jigsaw (pull handles)

white duck - catch fish  
 yellow duck - want nets  
 Fort Jahnson  
 partonime  
 - grunged "security"  
 on F's base (no objects)  
 in or out!

- need note from Squiggly or Poont to get thru gate
- Madame Fou-llana on other side of 113 Maze
- "The Well-Tempered Xylophone - A Collection of 12,274 Studies in each of 25 Major + Minor Keys"

home - Nalava (was Avalar)  
 Spell Madame Fou-llana to get into maze. Butler is Mr. Amoshtuff.  
 Maze of Dead to Snobar's house  
 Snobar (5th member) - Squiggly could open home.  
 Squiggly (4th member)  
 Leonie (1st member)  
 Poont (3rd member)  
 Finney (Leonie's companion + musician)  
 Henry the Head Grove 7/05 } pencil  
 Central Room } entries  
 Althath Builders (toffee, died in quarry)



//wondervoices.or.ca  
 //members.ad.com/iffant/

cadence: chords which outline final resting pt in song  
 embouchure: stronger lips → play trumpet longer  
 key: tonal level, 12 from A to G, Finney prefers Ab minor & D major  
 overtones: natural tones, unique per instrument  
 transposition: rewrite a song from, say G major to C# major  
 tritone (aka: augmented ~~fourth~~ fourth or diminished fifth)  
 - interval of notes is exact 1/2 of octave  
 eg: C to F# (aug 4th) or C to Gb (dim 5th)

Piddle Ball

POU-LLAMA  
 AMOSHTUFF

S	A	M	G
L	E	S	O
L	T	H	O
O	U	I	N
A	P	F	E

Impulse block  
 butter  
 "Spring the Love"  
 body heat  
 (diary)

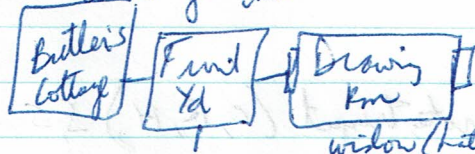

junked granite (Statue Pieces, Rig)  
 in weeks

widow (hits brown)  
 knick-knacks  
 fern/soil  
 novel

Plooy Fund  
 toffee  
 red-wank bit  
 Grudnik porno  
 Steber

fill up i must  
 give it to molian: [+2]

too many more?

Xyzzz  
 odyseus  
 hello, sailor

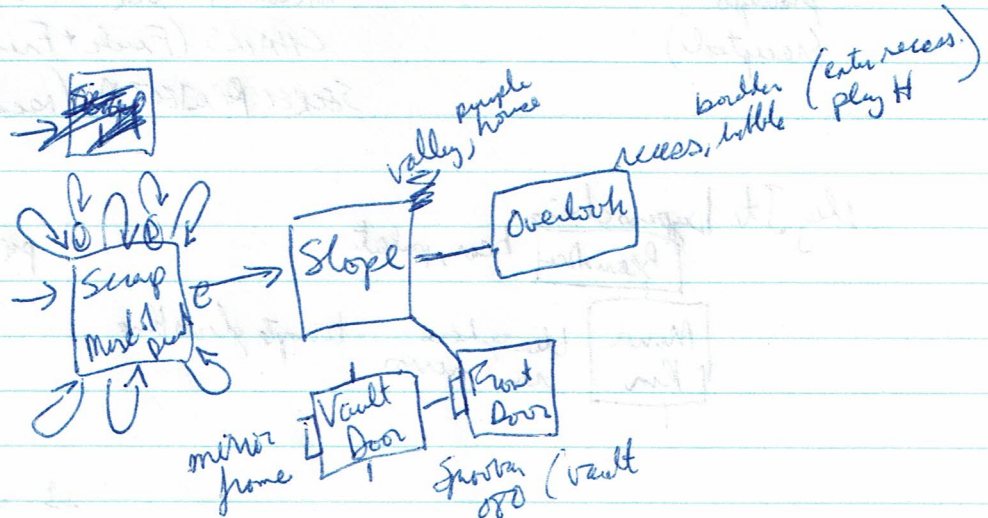

valley, purple  
 houses

border (enter recess)  
 recess, bubble  
 play H

mirror  
 frame  
 800 (vault)

calculate → "The answers to your life & fate, if in the vault you nietitate!"

zoning analogy

- Leonine can congue fudge

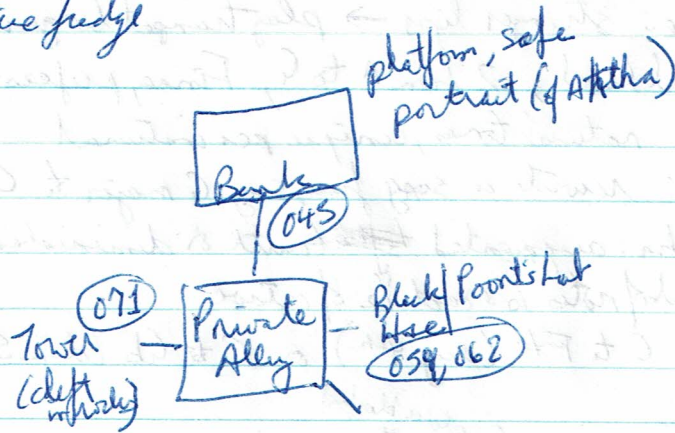

put up on platform. playtpt (H) +2 pts (now 24pts)

Cup, pamphlet, manual, note, trumpet (O, R, H) 5, 5

make L dense → key

key → open safe → instructions (penned note)

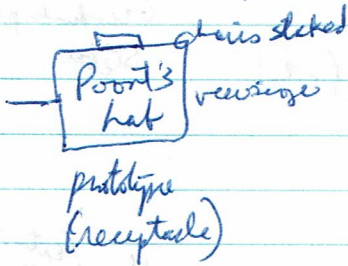

~~secret~~ book "Poont's Experiments"

BEAR'S CAVE (need det pills)

MIRROR CHAMBER (S's mirror was warped)

CHAIRS (Frank + Frank)

SECRET PROJECT A (need fish for receptacle)

key J to bypass chair

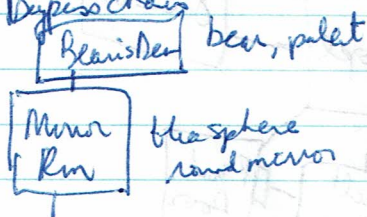

trumpet glows blue

put mirror in frame  
→ "Date of colour"  
(alters light)

major (the mirror 3rd)

+1  
D (red hairs → blue)  
use duck to get it!  
put hair in cleft [+2]



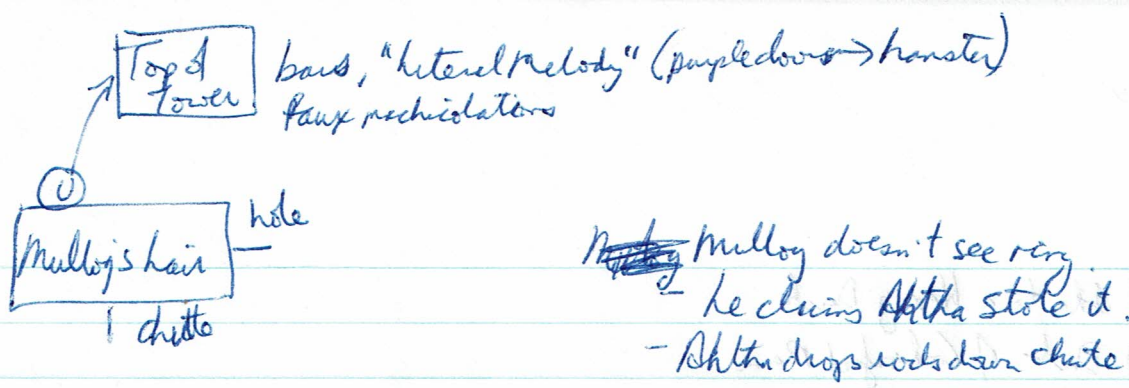

push fern (Pety Vandelen)  
 → killer  
 tall widow alt day  
 push fern. Play S. → Ms. Amoshtuff  
 + 2 rts. (46 total)

song D → complex layers  
 "literal melody" (L)

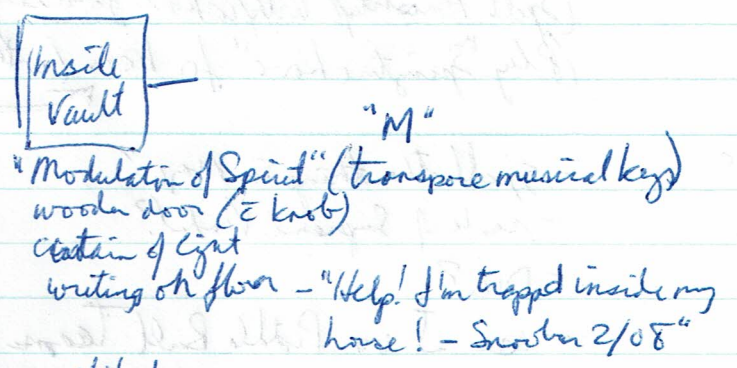

door in depression

mitigate:  
 "You're nearing the end, you're reaching up faster.  
 Now go to the front yard & ruminate."

play M in operahall (x4: 58)  
 → 25th key manifests physically.

Front yd:  
 "Now head for the surface, dirt dolly,  
 don't wait, but up in the balcony,  
 pandiculate (lost Loung Pt.)"

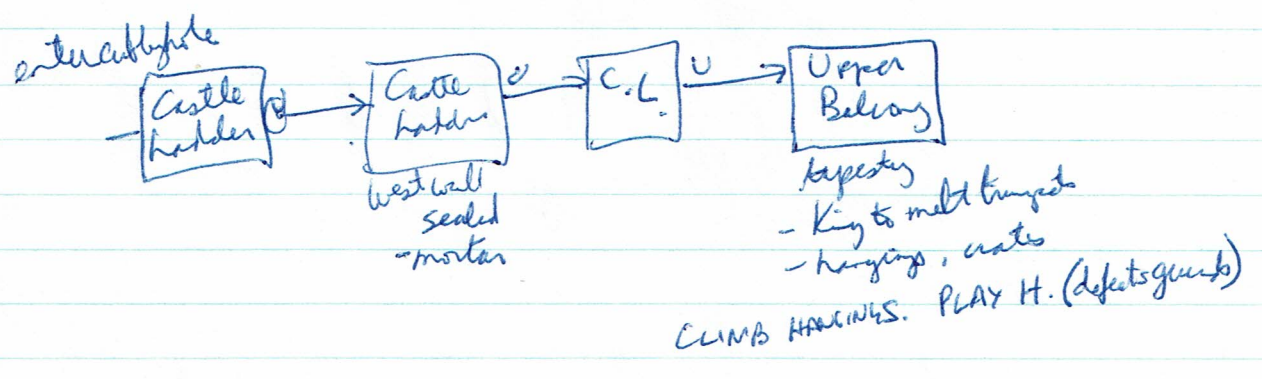

- O) Ode to a Heavy Duck
- D) Date of Colorful Rain
- H) Heavy Love
- J) Lovely Jig of Modulation

vs. Piddle Bull team, play H (or J)  
 vs Elite Snipers, play D  
 vs King himself, play O

(Spell Anashtuff with/without gold ring)  
 (Play "Springtime Love" for beer (with/without gold ring))

do at Mirors; under pallet  
 → Butler's Cottage

- spell other thing in maze?
- rank of Supreme Vandal?
- DIB?
- use J vs Piddle Bull Teams

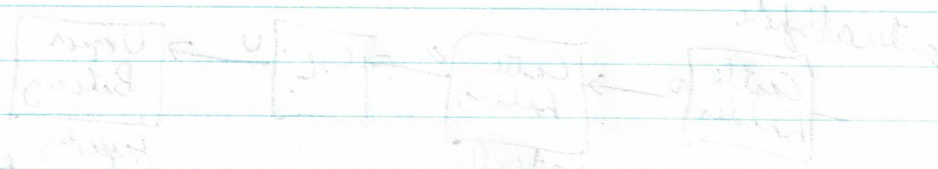

(Camp...)