

Melagoth & dragon "help"

Bliss
(bliss.gard)
10:27a-

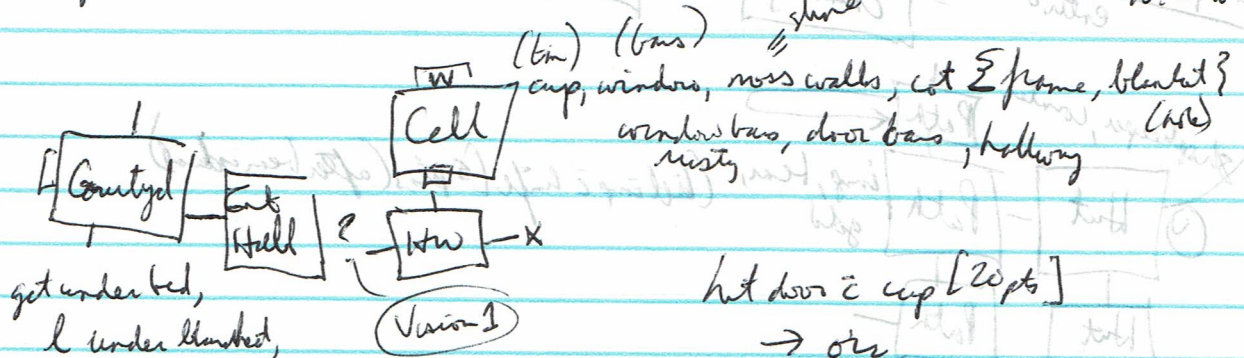

get under bed,
l under blanket,
pull legs. [10 pts]
search ore \Rightarrow knife, key?
(kill ore \bar{c} knife)

hit door \bar{c} cup [20 pts]
 \rightarrow ore
ask ore abt food, mangoth, re, drogers,
cot, cup, blanket, ore, moss, rotten

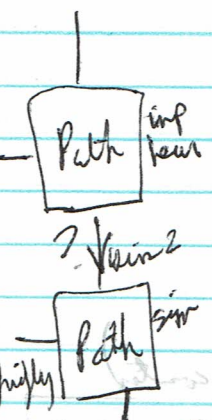

kill ore \bar{c} knife [5 pts]
kill ore \bar{c} knife [5 pts]

Gateway - portcullis, crane
throw knife at statue \rightarrow just heavy enough
throw cup at statue (+20)
(with chd)
kill ore at gate \bar{c} knife

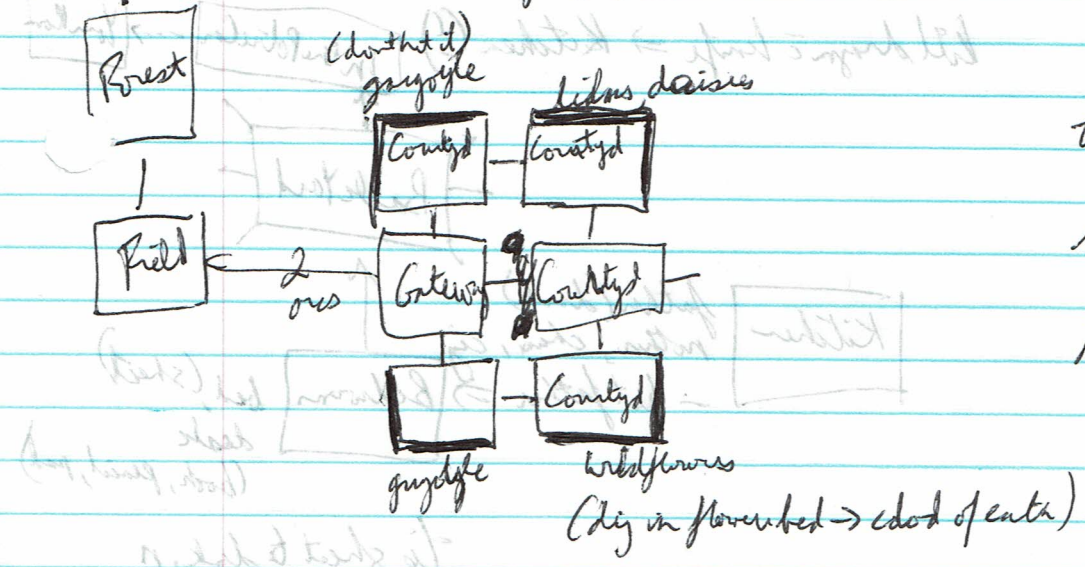

sign @ Path: "Theodore's Hollow"

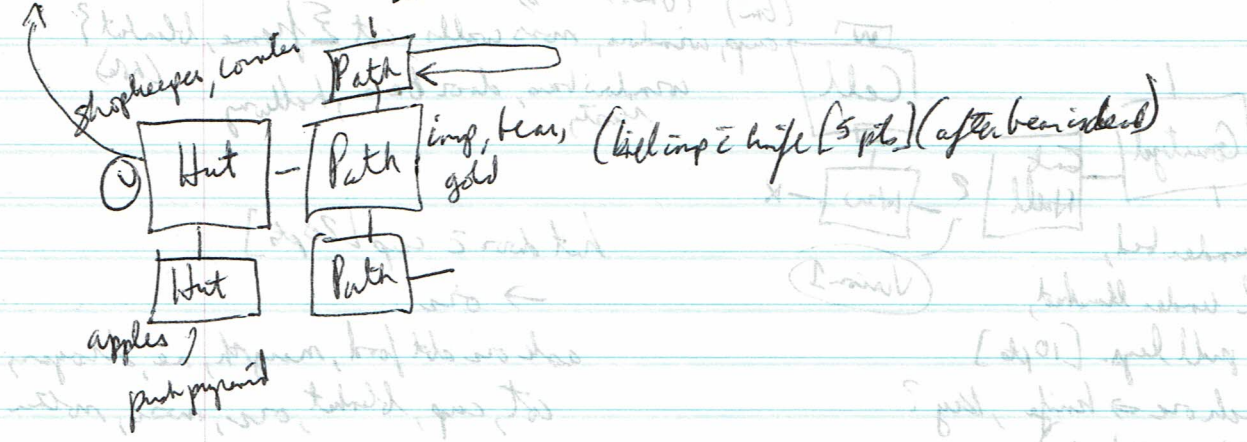
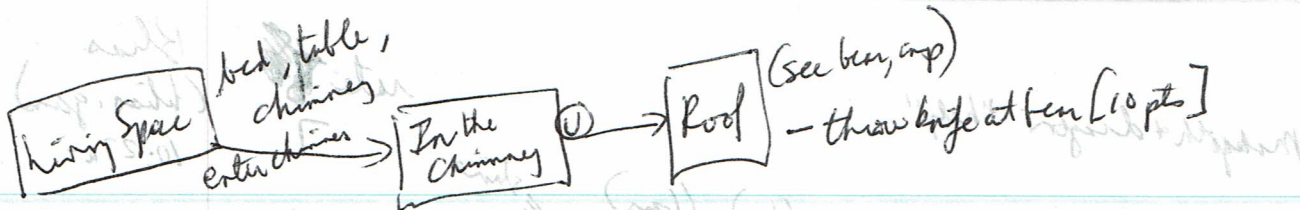

ask ^{mom} family, roger → needs money to buy something from apothecary

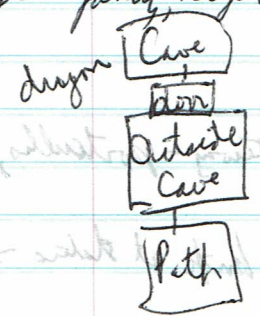

l behind counter ⇒ crowbar (not l under counter)
kill dragon & knife ⇒ Kitchen (1) → In the Petriole → You know

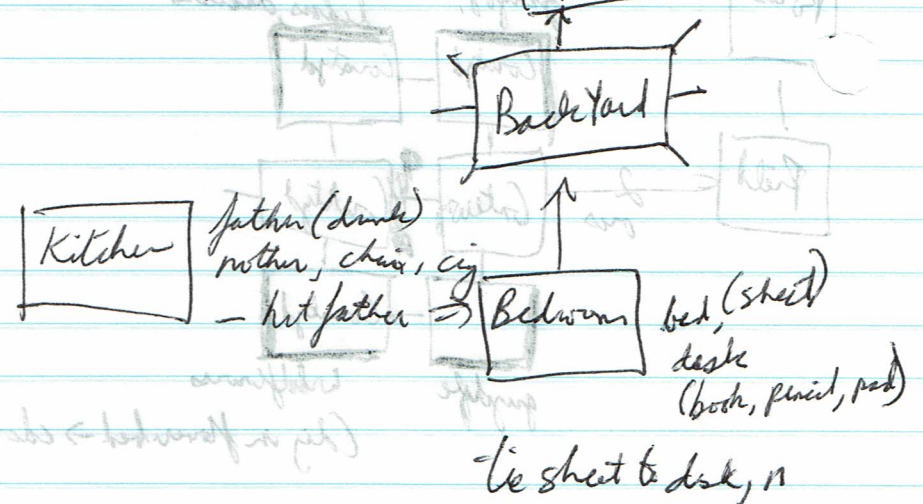

"(walk) & (run)..."