

2003

CAUSALITY

Causality by Hugo Martay (SD, 25)

[Hull] into E, star, sea, city, people, d → [Street] houses, cars, dog, meadow S

(die) → [The Mass 24] wires, hatch d, computer, window, knife i {note}

virus MN390 is onboard; destroying ship will save Mars

d → [Narrow tunnel] U, N, S → N [sleeping quarters] W, ~~people~~

S (from note) → [life support] wires, fans, life support machinery. cut wires ⇒ [Airlock] z*

⇒ [Hub] n Bus, e Comm, s Telescope, w Habitation, up; blue door, gndown, hatch, note

note (destroying bio labs that created the virus)

n [Bio labs] microscope, computer, cabinet of vials, workbench

books in microscope (battery) x cabinet. x vials (green, blue, purple) MN390

open green door (denied; noisy) open blue door (retreat; sleepers)

[Communications room] radio (cable) - missing coaxial cable &/or batteries.

// search cabinet. // U from Hub ⇒ Antarctic

progen { asteroid spotted 2043, fusion bomb 2095, mass-ejector Arel 2096

[redon] keys, tablet, newspaper { asteroid spotted 2043, fusion bomb 2095, mass-ejector Arel 2096

(plutonium detector), today 15th Oct 2097, 6:17 (kept newspaper & red scene)

could be slowed be virus? search wires (coaxial cable) take cable

[Airlock] lose all but cable, newspaper. // Arrow green vial ⇒ [Telescope Rm] gndown, complex, noise

x computers (5th Feb 2096) i { - } observation needed on 10th March. open green door. N. W

take all. S. open blue door. W. [Sleeping quarters] window, Tom, Natalie, bed, desk (diag)

open desk. take diag (asteroid observations. last 03/02/2091)

ask Tom about radio. Ask Natalie about green vial (MN390)

Show green vial to Natalie (weeks pass) x radio (working) // x computer in Telescope (Mar 10th)

(after several turns, ⇒ [Room] x newspaper (5th July 2091; maybe from base 2 months ago,

Natalie critic, other 2 dead; comm problems. Virus released Feb 2091, Mars mission

x radio, z. [Liferaft] 3AS left. l. (ship approaches) i { cd, note }

x note (Disable comm system with virus on CD to prevent nuclear war; computer is W, A checks

[Motor Boat] x marines, x ch. [Medical Bay] exit N, thl, doctor.

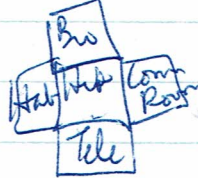

YJAZUAD

red s

football s

n [Condo, B deck, Central.] w [Condo, B deck, West side.] w [Stair, West-B deck.]
 u, e + s (Kitchen s) u → [Stair, East, A deck.] u, d, e e [Condo, A deck, West side.]
 maines, ctrl room s {pass only?} e [Condo, A deck, Central.] number stairs.
 e. [Condo, A deck, East End] computer room s, maines s [Ctrl computer room]
 x computer. put cd in computer. x computer. (alarm!) n. e. [Stair, West, A deck] u, d, w
 u [Stair, West, P deck. You can go outside to the east.]
 e [Missile Deck] launchers x launchers (machinery below deck, only turrets here)
 z* [Underwater] z, z.z.z.z. [In the Sea] x anomaly. z. [Underwater] z z
 [Arch living capsule] ambale U, intend door, note (destroy vessel)
 open door. U. (extend door, intend door U) close intend. open extend, u [out of capsule]
 engine, workbench, door. search workbench (detonator, Plutonium workbench)
 x plutonium workbench (clump of plutonium)
 search engine (thrust, radiation shield, plutonium source - fake shield.
 fake plutonium. put plutonium in engine. ⇒ [Main done, mass] {mass 24
 will land in desert = water + water tools } bag N, planning S i {shield

S [planning room] charts, local map

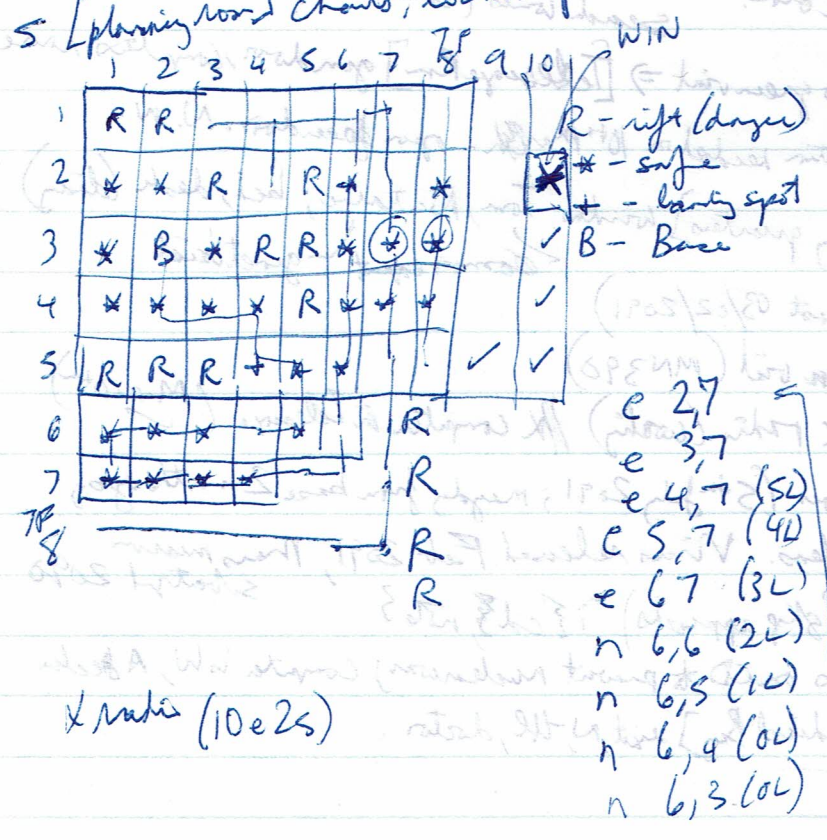

N - Dorking Bay } dry N, cover
 entrance [Out of main base]

- 19h fuel, loc 2e3s
- S [18L, 2e4s] wilderness
- e [17L, 3e4s]
- e [16L, 4e4s]
- S [15L, 4e5s]
- e [14L, 5e5s]
- S [13L, 5e6s]
- w [12L, 4e6s]
- w [11L, 3e6s]
- n (die → ed) @ Altap
- w [10L, 2e6s]
- w [9L, 1e6s]
- S [8L, 1e7s]