

Cutthroats
(start 8 am)
hungry at 8:15
thirst at 8:20

"If you're interested in a big deal,
be at the shanty at 8:30 this morning."
- Johnny "

wind watch!

Characters

- Halbin (killed)
- ~~Red~~
- Johnny Red
- The Weasel
- Desk Clerk
- Pete the Rat (eyepatch)
- Bar tender
- Parrot (wooden leg + eyepatch)
- McInty (agas, envy)
- Teller (safe)

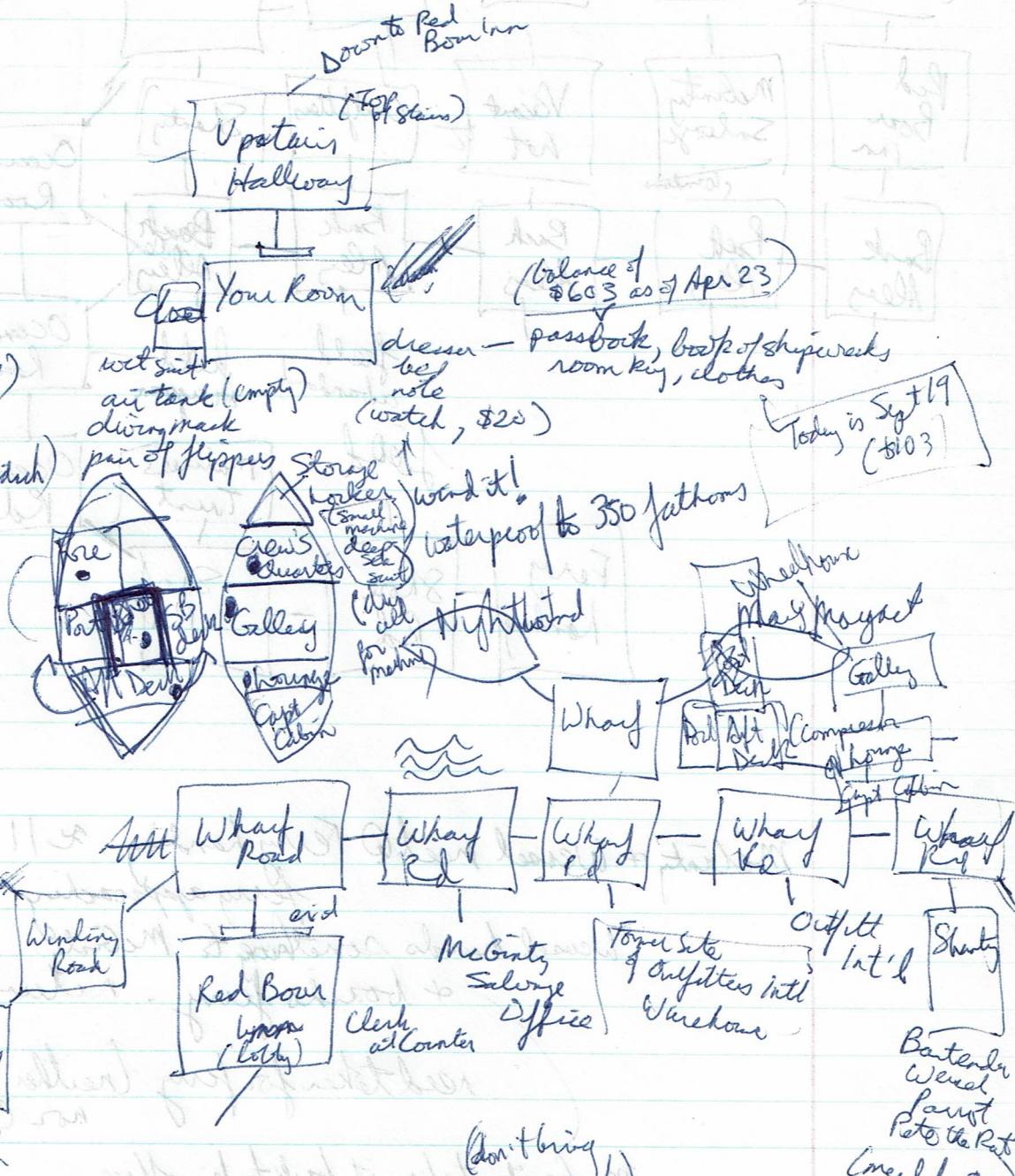

Gold coin (1680, portrait King Peter II of Portugal)
(São Paulo)

- I'll ident ship & dive, Red is Capt, Pete cook, Weasel crew.
- supply longitude & latitude, \$500 @ Pt lookout at 10:45 (Pete's boat)
- meet @ shanty @ 11:45 for final arrangements
- (rent Mary Magdalen)
- leave @ high tide (be 1/2 hr before to watch stuff) (2:00)
- contributed \$448



McBinty + Weasel meet @ Ferry landing @ 11:58 am
 ferry approaching
 Weasel hands something to McBinty
 + boards ferry. returns at 2 am
 (need token for ferry (neither Mainer's Trust nor Outfitter's have one))

McBinty takes it back to his office
 an envelope - has McBinty Salvage return address
 + "Weasel's Merchant Seaman's card
 - collateral for deal"
 in McBinty's hand.

card
 "Frank Webster
 Seaman First Class
 No. 2626868"

Open window + enter that way
 after McBinty is gone!
 he leaves around 12:31 am

Sao Vera

gold coin

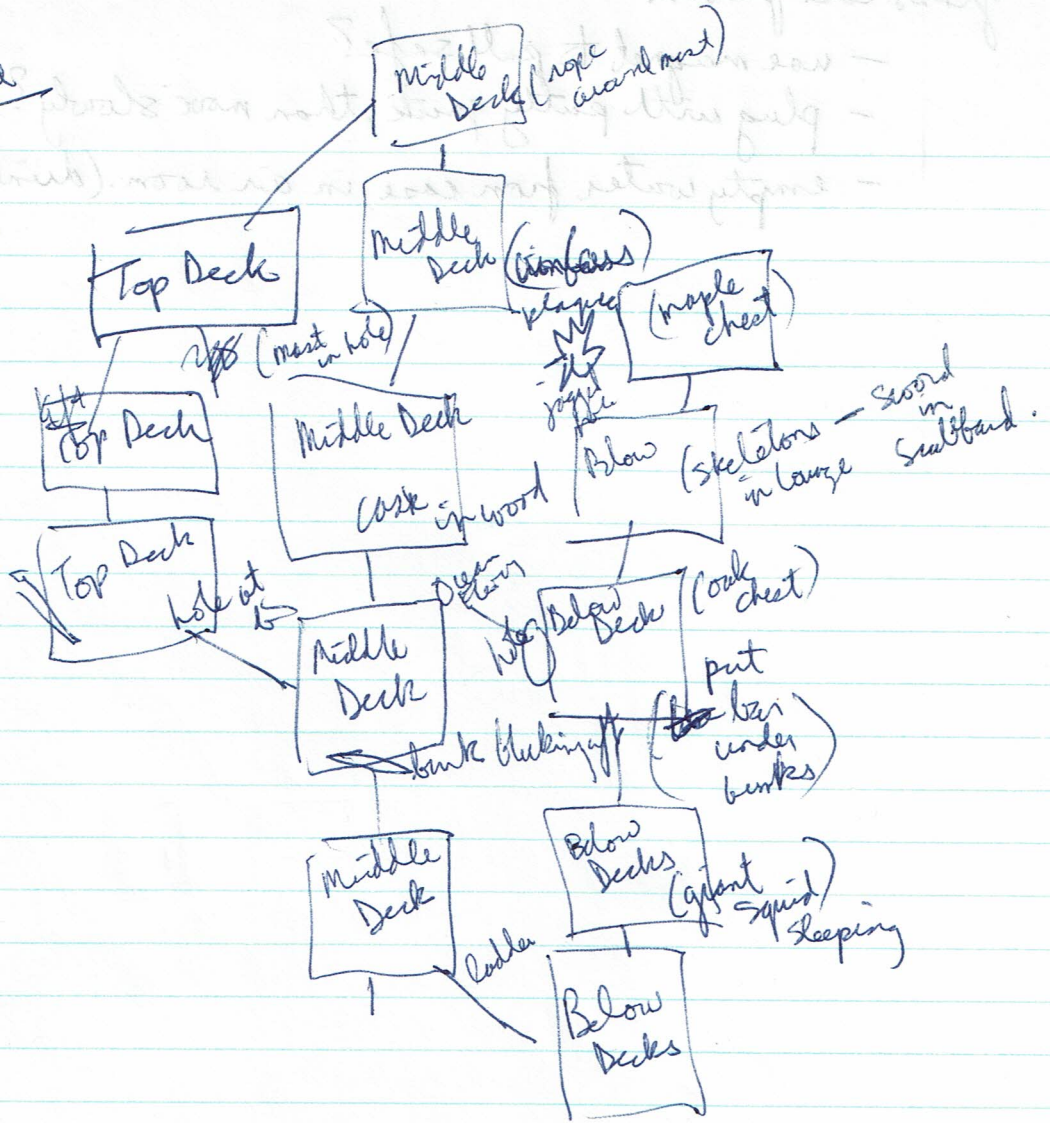

need repellent

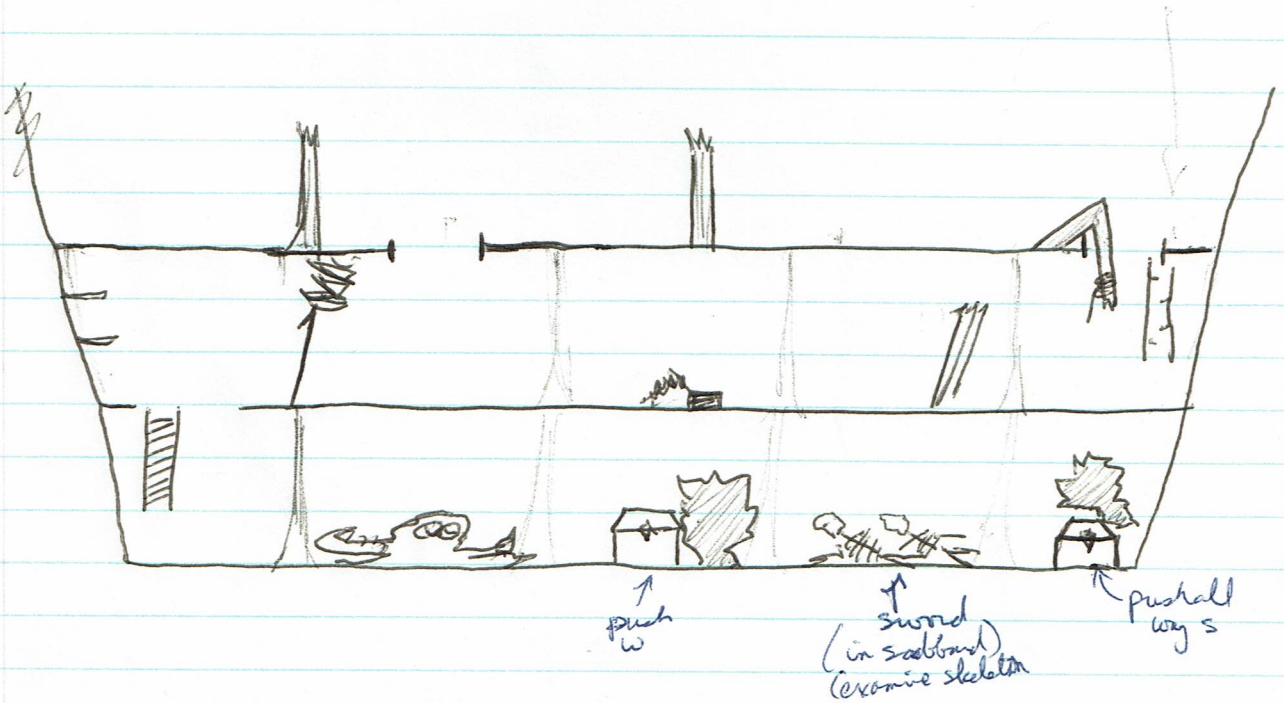

glass case problem

- use magnet to pull safe?
- plug with putty quick, then move slowly?
- empty water from case in air room. (drink it?)

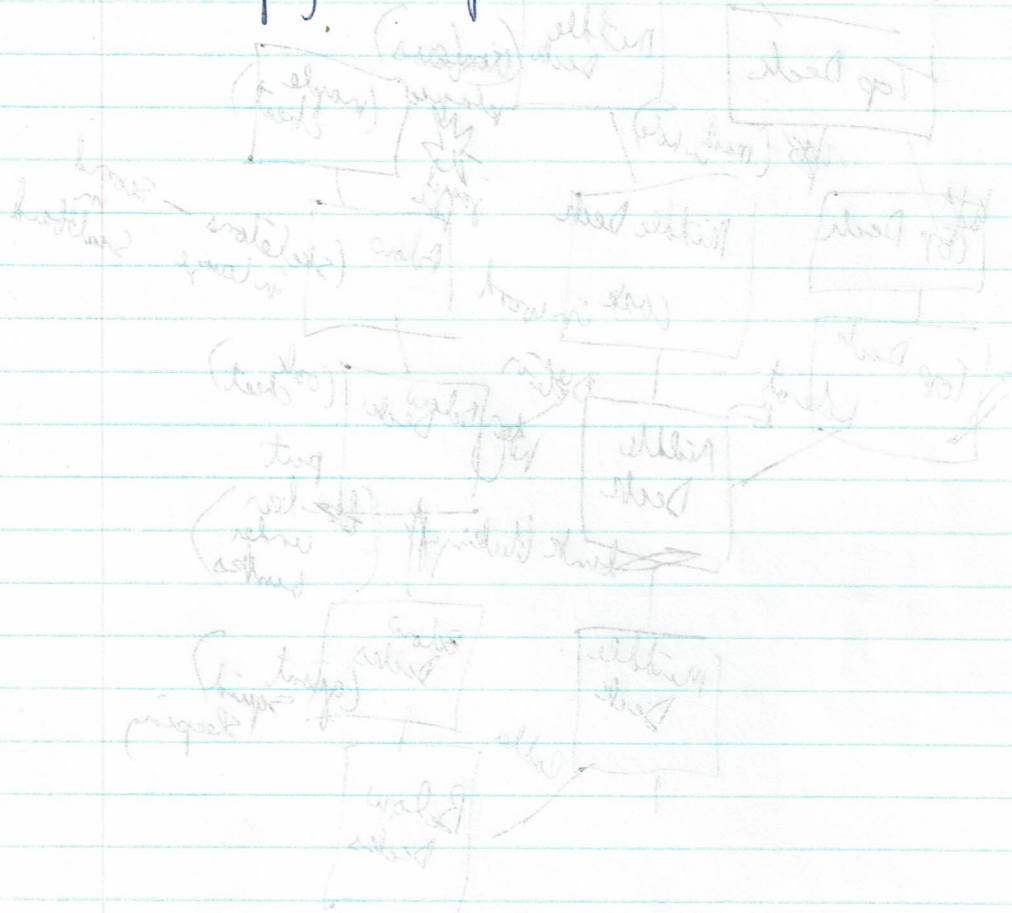

tray for beer

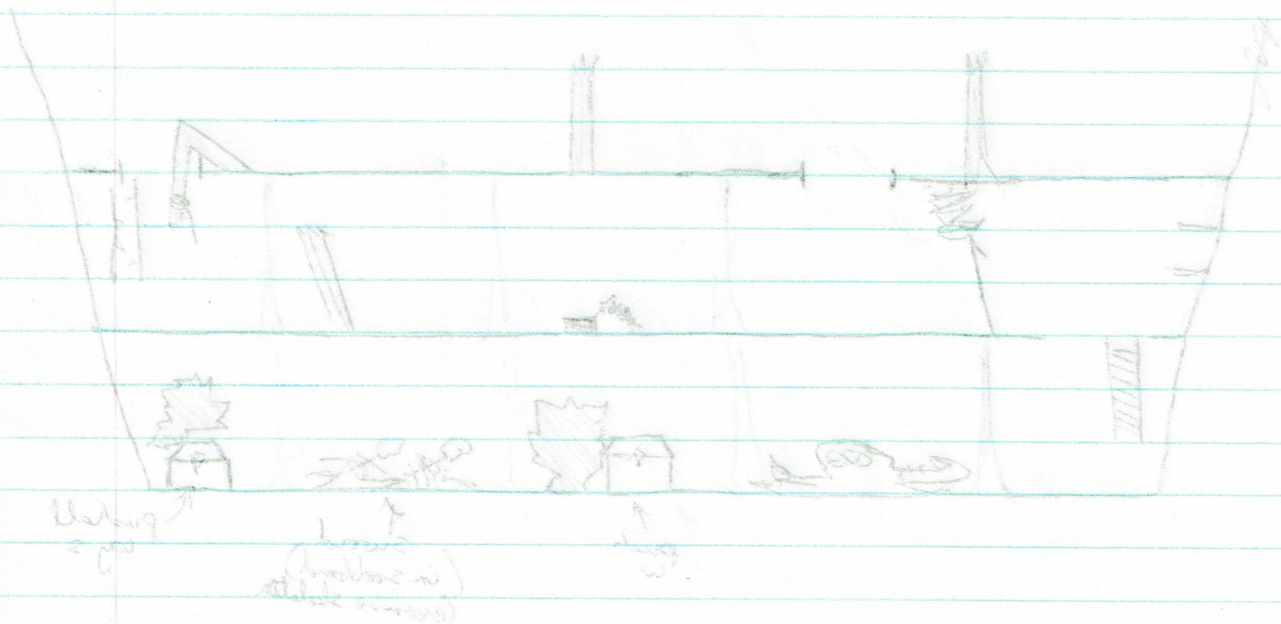

Cutthroats

WIND WATCH / GET UP / OPEN DRESSER / TAKE KEY
 OPEN DOOR / N / LOCK DOOR / LOCK IT
 N / N / E / E / E / E / S
 SIT / BUY FOOD / EAT IT / BUY DRINK / DRINK IT

WAIT FOR JOHNNY, YES
 GET UP / N / W / W / W / W / SW / SW / NW / WAIT FOR POTZ / WAIT

gold coin (0)
 Sao Vera
 long = 45
 hat = 40

{ need to get money from Pt. Lockhart } { \$603 in wallet }
 SE / NE / NE / S / S / UNLOCK DOOR / OPEN IT / S
 TAKE PASSBOOK / N / CLOSE DOOR / LOCK IT
 N / N / E / E / E / E / SE / S / S / SW / N
 WITHDRAW \$500 / S / NE / SE / WAIT FOR JOHNNY
 SHOW MONEY / RED, YES { Mary Margaret }
 FOLLOW RED (G) / S / WAIT for Johnny to visit M.M.

(chip in amount varies) GIVE \$437

(1) BUY FLASHLIGHT, REPELLENT, DRY CELL (24+20+5 = \$49 not strictly necessary)
 (GO TO SHANTY FOR DRINK)

GO BEHIND MCGINTY'S WAIT FOR MCGINTY to leave,
 OPEN WINDOW / N / TAKE ENVELOPE / S / CLOSE WINDOW
 E / N / N / N
 E / S / D / N / N / HIDE ENVELOPE UNDER BUNK / N

(2) WAIT FOR BOY (checking machine)
 wait for Johnny, tell him long, lat, sleep in bunk (wait)

6:05 am → ^{look} under bunk, take envelope
 Go to Red, Show envelope to JOHNNY
 Go to Galley EAT STEW / DRINK WATER Go to Supply TAKE ALL
 Go Aft Deck, WEAR SUIT / CONNECT HOSE TO SUIT / TURN ON COMPRESS

Top Deck (3)

DIVE / TURN ON FLASH / D / D / (open lock) (D)
 D / S / TAKE BAR / S / S / MOVE BUNKS WITH BAR / PUT BAR UNDER BUNK S / S
 D / N / N / PUSH CHEST W / TAKE LINE / TIE IT TO CHEST / PULL LINE / E
 N / EXAMINE SKELETON / LOOK IN SCABBARD / TAKE SWORD / N / PUSH CHEST S (open)
 STAND ON CHEST / U / N / N / PUSH CASE / STAND ON CASE / CUT ROPE WITH SWORD / U

"Johnny spends several minutes forcing open the chest. To everyone's delight, there are hundreds of gold escudos inside. Johnny slaps you on the back, "Good job, matey!" As you return to the island over the calm, dazzling blue sea, you contemplate your wealth with a touch of sadness. You think of Merlin of hope his soul is resting a little easier now."

Your score is 250 out of a possible 250. This score gives you the rank of a rich diver.