

[Cell 4B] door N. i {evening uniform '31337'} {E cant remove it; (eye)}

N [Cell Block 4] N, S, NE, SW
// cut me with knife -> die (bleed to death)
NRE from Rec Field -> die (DFA lasers)
open all @ Kitchen {reverts stove, wasteb} (x)
open all @ Common Rm {two couches}

32767-832H

Escape from Lowell Prison by Jimmy

32767 dec = 7FFF hex
832 dec = 340 hex
32767 - 832 = 31935 dec = 7CBF hex
32767 = 2^15 - 1

look under couch. drink vial. (win)

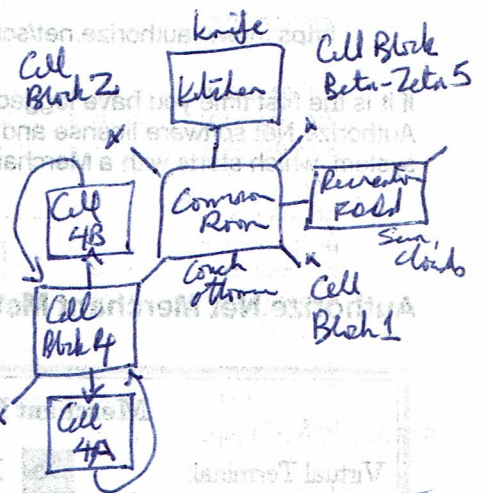

[Ashlote-Block Cell] wall, old man, gate. {Help: Just act. E = talk about}
x me {scenery beyond gate changed to ship deck}
t ship. t gate. t gate. {all potential escapes put here}
5 -> Oblivion. {gate shows hallway}. enter gate -> TOW end.
mother this man claims to have built the jail

Lowell Prison by Emily

(or Z. -> TTB end)

Virtual Terminal Overview

The Virtual Terminal should be used for handling entry of transactions on the Authorize.Net system. Some of the reasons you might need to use Virtual Terminal are:

- You received an order by phone, fax or mail and need to expedite the transaction.
- You need to perform a credit transaction according to your own return policy.
- You previously received a voice authorization by phone and now need to submit the transaction to be captured. (Also called a Post-authorization.)

As you can see, the Virtual Terminal allows you to do many different kinds of transactions, including credit returns (for refunding money to a customer's credit card), authorization only, post-authorized only, and of course a normal authorization. You don't need to have a web site to use Virtual Terminal. Simply login to Authorize.Net and choose Virtual Terminal on the Merchant Menu.