

- Death comes to the difficult cases
- examine homeless
- says X to Horse (deducted)
- reap soul (need scythe)

strange - pairs com

A FINE DAY FOR REAPING

[The King Room of Death] - bookcase, CD player & CDs on shelf, anchor, window, E.
 i {hourglass x hourglass (12 hrs)}
 Gables & Candle in window

e → [The How of Death] find door S, read mail (free credit card) → bin, mirror, books, E, S, W.

- ✓ Lord Nigel McWorthington, Himalaya, Nepal
- Ernest Brunet, Manchester
- Junmya Wangui - Wajin
- ✓ Agathe Laurent - Paris
- ✓ Splong 56 - Nevada

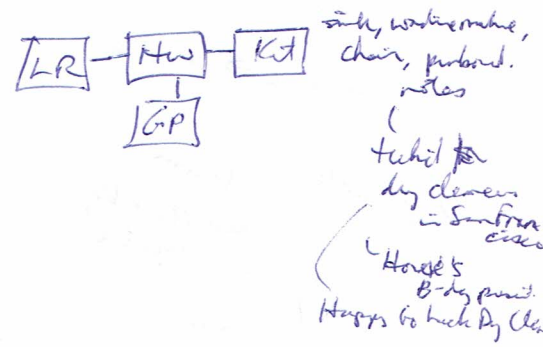

Tucker Path (M/S) - S → [The Stable of Death] Whatstone, scythe, Horse

Mt Pass (Himalayas) - snowdrift buried him.
 Manchester → Cellar (explosive machine), U, tools, shoe, Thomas Brewer
 U → [How] telephone on table, N, S, W, D.
 Nevada → Strongy Lybosi (Ameas) & shovel blade
 Kline in Courtyard (N, S, W)
 - Crane

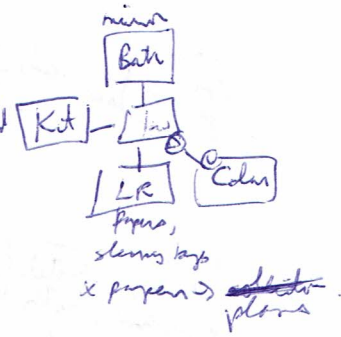
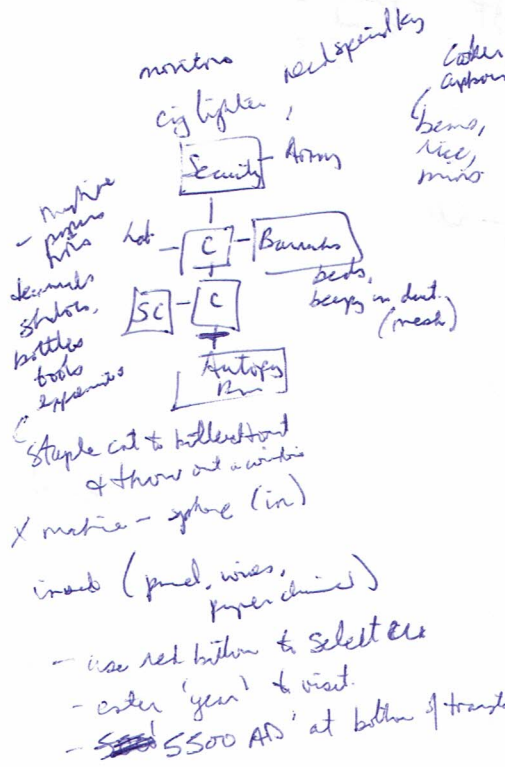

Agat Junglones in Paris, spf
 Coleward - Blue Sparrow.
 press button → hot unboxed.

- Splong 55
- table, instruments
- trolley

X wired Cellar
 → 10, 097 BC

CFB

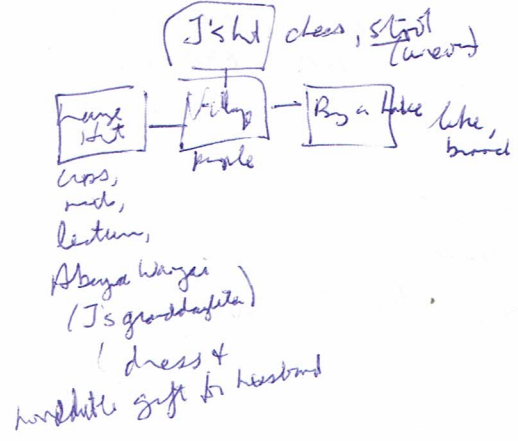

use drum \Rightarrow blunt saw.

light by the alarm bed, chalk line, Azetka

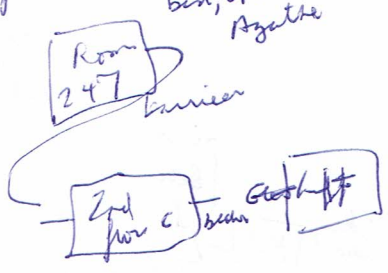

- grand 0
- first 1
- first 2
- second 3
- last 3

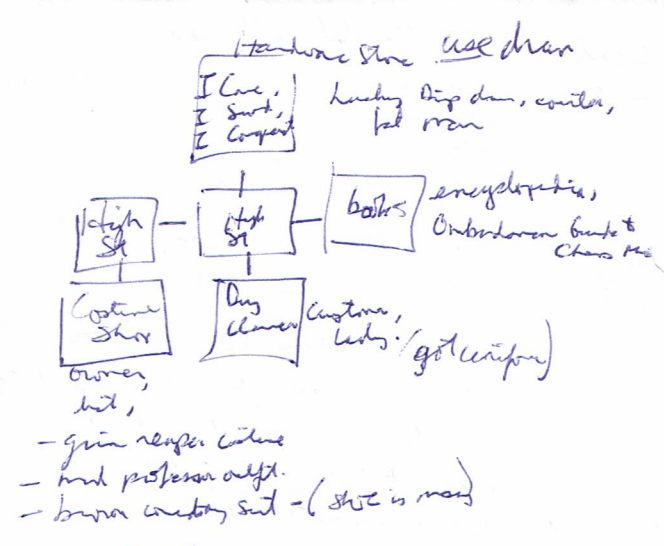

- give shoe
- chin man
- wedding gown
- say gown. \Rightarrow wedding dress

x encyclopedia \rightarrow Follina, 12000 yrs ago.
 x guide. found in 2004.
 w: "Agent Fellows"

x panel \rightarrow need a coil of wire

