

7

GRAYSCALE grayscale.gam

6:22p - 8:13p

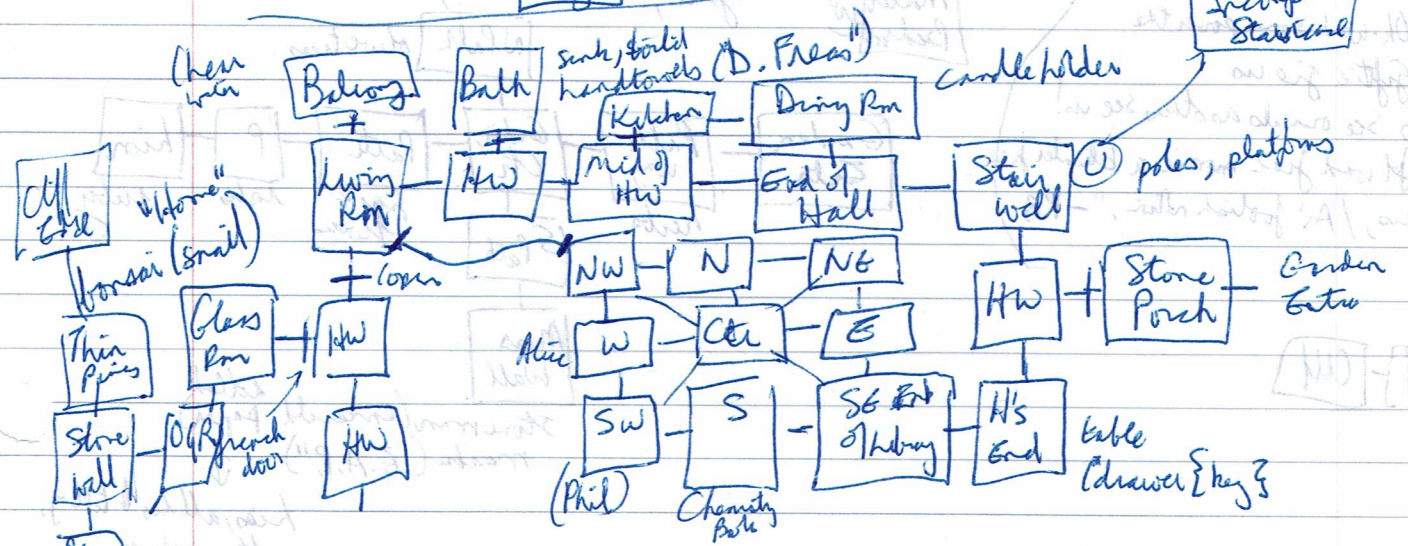
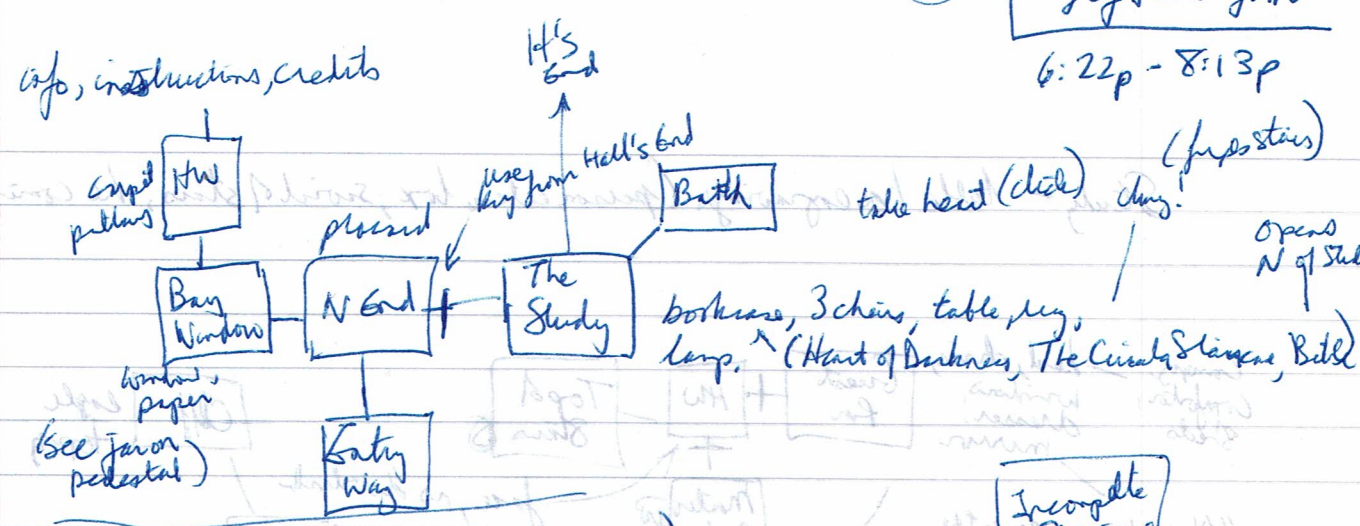

- Living Rm - octogon shape, couches, chair, tables, book stands, drapes
- Kitchen - knife, counter, refrigerator, stove, sink (all steel)
- Chem - 'nitric acid acts on copper' (green blue liquid, air like red, acid eats fingers & trousers)
- Phil - 'Philosophy is a fool's game'
- Alice - 'Why do the boots & shoes (under sea)'
- N: Don Quixote by Cervantes (hat is a thick stick)
- NE: bookcases, Modern Poetry
- E: Flashed by Abbott (8 bonding cubes)
- Ctr: Woman in stone chair on platform, leather chair faces platform, skylight
woman say house is in a gray box; another world on other side of tunnels.
- testers / key (for N end of entry way)
- Daniel Freas - programmed me. I was ready to be compiled for release.
- x-think - "Walker Stevers was here."
- Take clear jar - iron bars

Study - table has engravings (person enters box, sword of stars, he comes out bottom of box)

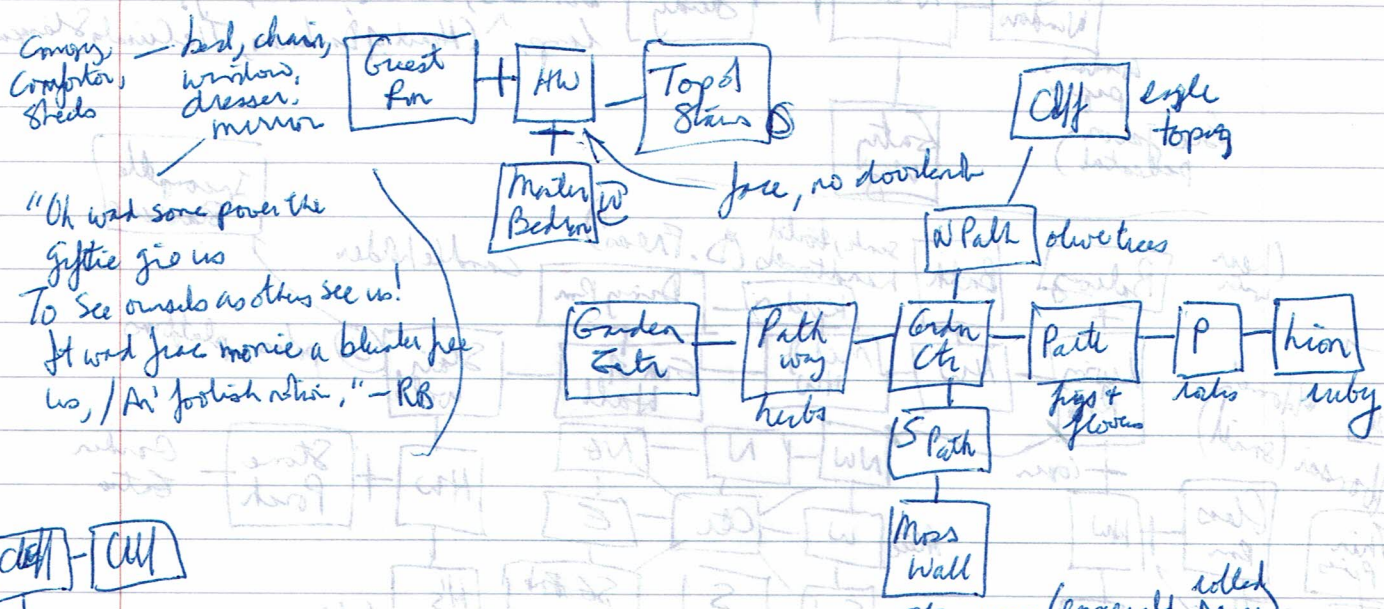

added paper
 ↓
 lies, all his & tell y.
 then silence
 Death comes - death leaves.

Garden Bath (grape vines, flowers, trees, stone ball)
 ↑
 (berries) ↑ "Atropa Belladonna"
 out grapes (heart poisons) (does a dilute solution of Nightshade in eyes to dilute the pupils)
 w: opal "West."
 Garden Ctr - pool & rocks (healthy water) (wears mask - 12 bell studies?)

mask - break it? 'EAP' = Edgar Allan Poe
 - put mask on face (door opens)

Master Bed - tiles, square bed, table, dresser, writer
 ↑
 compass with holes

(black jar in compartment - "Dominion")

open french door & knife
 way down from Ctr (now open)
 → Dream Room

put class for on pillar of Dream Rm

- passages N, S, W, E

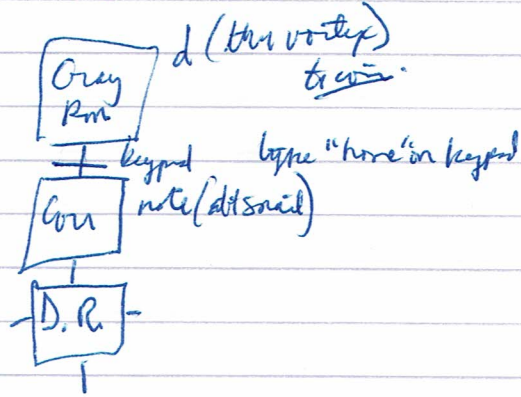

Push about x (credit)

GRAYSCALE
by Daniel Freas

info. start at Entry Way (house, iron door(s?), north to ?)

n → [North End of Entry Way] placard (quote by S.C.) w, e (door) behind.

w → [Bay Window] N, E, window, paginated paper. (read it)
↳ see trees, pillar & jar

n → [Hallway] N/S, carpet, pillars,

n → [Hallway] french door w, double door N. look through french {plants, bonsai tree}

n → (auto open door) [Living Room] ^{lighting} couches, chair, tables, ^{spindles/books} bookshelves, drapes, glass door N,
hw e, cedar doors SE, door S

open glass door. n → [Balcony] x cliff, x stairs. s. close glass door.

e of LR → [Hallway] n → [Bathroom] x sink, toilet, lid, towels.

turn on sink. drink water. turn off sink.

e of hw → [Middle of Hallway] E, W, N. [Stairwell] stairs.

[Dining Room] table, high backed chairs, scratching chairs, holder (sit on with holder).

[Kitchen] counters, sink, fridge, stove, knife (butter knife).

[Northwest End of living] doors NW, books.

[North Side of living] books. ~~books (Don Quixote)~~ take book (he read it & put it back)

[Northeast End of living] bookshelves. (Modern Poetry) take book (pgs ripped, words on back cover)

[East Side " "] Flatland. read book

[Center of living] platform, woman in stone chair, leather chair, skylight.

ask woman abt herself. name (Daniel called me 'Fire and Ice', but my 1st name was Alanna)

ask Alanna abt Daniel. abt house (kitchen, gray box, outside world, on other side of hands)

abt testees; abt box (outward reality vs. true reality), abt stairs.

abt library. abt books (specify?) abt Flatland. abt placard. (over)

abt paginated paper (due to jar thru window) abt jar. abt leaving (abt lamp)

abt knife. abt balcony (don't jump!) abt fire and ice ("I'm sitting on the armoire")
poem by Robert Frost.

ask abt stone chair. abt holder. abt stairs (there is a way to complete it.)

ask abt modern poetry. abt cervantes, abt don quixote. touch alanna. (head passes thru!)

ask abt bonsai. abt trees. abt skylight.

abt keys (key in study, in drawer of table). abt tunnels (vortex or center of oily way, see coffee table; another abt.)

abt coffee table (in study). abt vortex. kiss alanna.

[West Side of living] Wonderful by Carroll. [SB] no books.

[S] Chemistry by Ira Remsen [SW] Philosophy (blank! except one line)

[Hall's End] table (drawer (key)) handle. [Stone Arch] Steps

engravings
Key front hall, but unlocks door to [the Study] chairs, coffee table, rug, lamp,
bookcase N, ^{small} door NE.

↳ 'Heart of Darkness', 'The Circular Staircase', Bible.

NE → [Bathroom] take Bible → (a wall opens)

↳ Heart (Conrad, Joseph - 1902)

take heart (clutch; heart of electricity!)

Pinchard May Roberts - 1908
take it (the staircase goes up!)

[@ Balcony] jump x 4 → (die!)

e of Stone Park → [Garden Entrance] e, grape vines, purple flowers, willow trees, bull (open in back)
Some grapes are shiny? (eat grapes (can't take them) "Atropa Belladonna" "awful")

[Garden Center] pool i rock (falls as is by) (drink water - healthier?)

[Cliff Overlook] cliff, stone eagle, bench topaz (orange)

[Pathway] - [Pathway] - [Stone lion] hedge, lion, ruby

[South Path] stones, moss, roses (small), foellies.

[Moss Wall] stone, man, mask. - "E.A.P."

↳ David, enamel, rolled paper

wear mask (12 strikes of a bell head?)
2. (blood drops) (Who does? Hay him?)
2. blue; purple; green; orange; white; violet
black (blood); (die!)
(stud!)

ask Alanna abt mask (try breaking it?)

ask abt GAP (Edgar Allan Poe) abt Poe

abt the Tell-tale heart. abt Bible.

abt the circular staircase - the heart of darkness (man's trip to depths of Africa)

abt Conrad. bull. open. lion. ruby. eagle. topaz. man. enamel.
(W) (E) (N) (S)

abt french door (unlock it from other side?)

(put mask on face (opens)
take it (it closes)

[Master Bedroom] tiles, bed, table, dresser S, window E. - see garden

stair frame + red covers, table has 4 shallow holes (north, south, east + west)

ask woman abt black jar (if holding it) E write open S

abt key (if holding it), abt rolled paper (it showed up when mask started acting weird)

abt pool (water cures all diseases + poisoning) abt cliff

abt Howard (Jacques-Henri David, a French painter)

abt snail (he, bonsai + me are the only "real" things in this place)

home. Nothing happens, perhaps it only works for snails)

french door (opens)

abt window (Alanna doesn't think it's ever been opened; she doesn't know what's on the other side.)

Grayscale

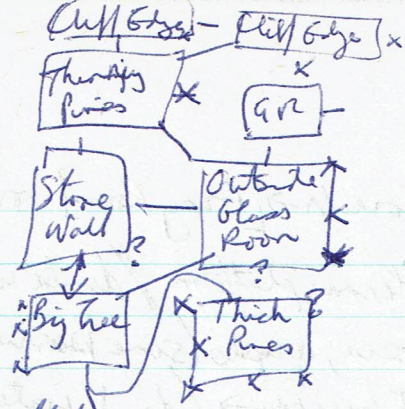
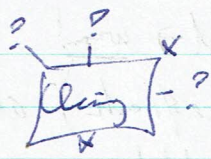

bonsai is takeable (and ask Alanna abt it)
if y drop everything else. The snail is stuck to it.
~~ask woman abt clear jir~~ (if holding it)

open den jir @ Clearing (wholly, pillar turns 360° clockwise). (also, seat of leather chair in center of library has folded out; very dramatic darkness)
jir → it turns counter clockwise

d (pitch black) (pulling heart of darkness. trees on the left)
[Dream Room]
pillar, windows all darkish, walls tilted (all return)

put jir on pillar (corridors straight; 4 corridors N, E, W, S) (blue tint)
ask abt pillar (the pillar outside can hear.)

n of Dream Rm → [Lounge] N/S, table (note), door = keypad. (type 'word' on keypad)
note is abt the snail.

type "home" on keypad

s of Dream Rm → [Mirror Room] mirrors, podium (read it: "If a screen could be a person...")

w of Dream Rm → [Super Computer] computer, placid ("Alanna")
red button (Toggle GUI on/off)
push btn: ("Graphical user interface disabled.") (Alanna is gone)

store chair. read it ("Orange never was my favorite color, ...")
{ mix blue of ice with orange of fire? } - fasting of desire?

e of Dream Rm → [Art Room] frames + paintings
x paintings { 1st: girl in storybook (By "Sovgverear")

g (2nd: man on mitrop; Chinese characters; "Chen Zhou") - abt of plea?

g (3rd: astronomer in book, globe of stars; "Gerrit Dou")

g (4th: sculptor + statue of woman; she's kneeling; "J. L. Gerome")

g (5th: remains of Roman Empire; setting sun; "Thomas Cole")

g (6th: cloud of stars, two hands holding orange creature; Kelly Freas)

g (7th: woman on bench tearing a kitten's fur; John Godward)

g (8th: ship in moonlight; Caspar Friedrich)

g (9th + last: Napoleon on horse; woman on mt; Jacques-Louis David)

Abt podium
room is just
ask abt front

n of Corridor → [Gray Room] vortex downward. d → win!

abt Athena; platform / drink water (breaks curse of rock); abt water; abt rock roses; grapes (some berries aren't safe); abt berries; abt belladonna. eat berries → (drink water asap)

(jar must be empty to make Dean Rm work)

break jar → (illumination of gray room temporarily broken)

(if you do this 3 times, you die)

- y cant pour water in sink @ Kitchen
(or in either Bathroom)

Take water
not fill jar
not put water in jar

> put tree in jar
The jar already has a bonsai tree in it.