

Heroin's
Mantle
Heroin. 25

break bracelet. I under it. open bracelet. take it. wear it.

Crusader: "I will watch over you, always."

8 yrs later, Amy at ACV discovered where Toshigi Takamura is,
to meet her at Yamitsi Elec. Corp. party.

→ Cocktail Reception (globe, se, sw, doors n, stairs d)

↳ mother's silver chain, blue dress, gold bracelet, underwear }

↑ sapphire encrusted crucifix & letters ("To my dear wife Mercedes.
Present to mother on her wedding day. [From Jazor.]")

globe spins on axis in time & Earth; microchips make conquests

Amy { gold gown, pink Christmas cracker }

TV { data cables, suspension poles }

Amy say that T is upstairs, try to find something circumvent.

- gives you compact taser (ghosts of alan - Amy is Crusader!?)

put (closed) chain under coat.
press button down

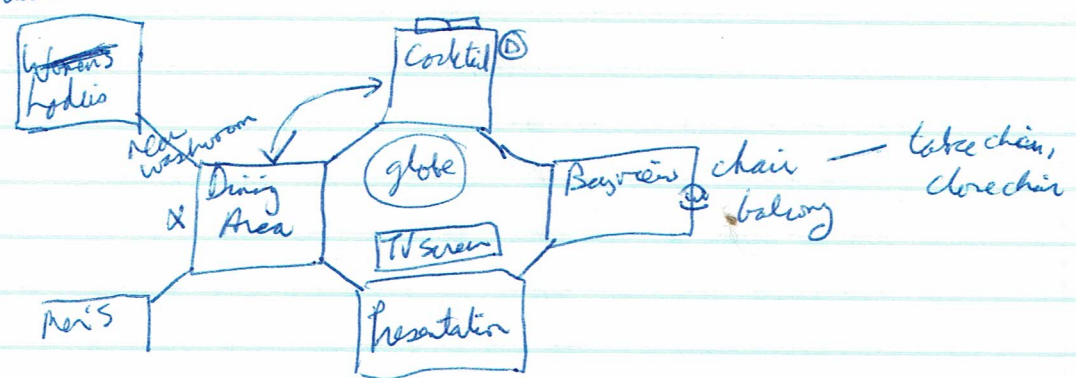

Amy, Toshigi,
jacuzzi,
2 Japanese women
& needle gens

Heroin's Mantle

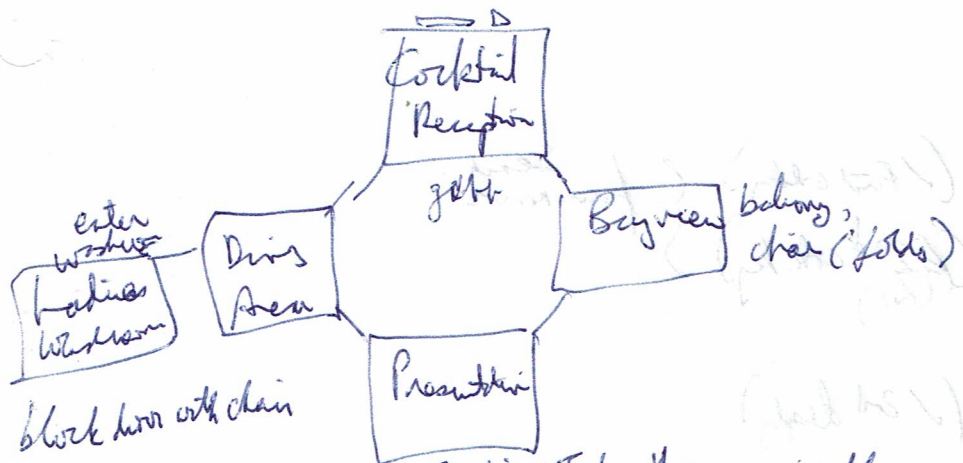

Toshigi Takemura, needle gun
 jacuzzi, 2 women, Aug,
 television screen
 - data cables, relay wire

compact boxes

- The Baron has taken over the broadcast.
- oriental beauty goes to washroom ("Mantle box")

president E. MARISAWA 1996-2001 in main in photo

offices, twenty third floor

pydows i bush.
 lift shaft

TWIST DESS.
 CLIMB DESS.

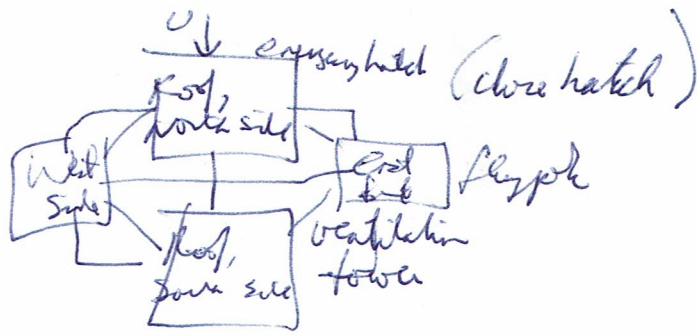

Letty
 - hook up marisawa
 VIDPROM: ACYB25P
 (25th Penthouse)

- x 60 pensets
- x disc
- put gun on controls
- put chin on gun
- gun compartment
- take disc

answering machine
 laptop
 memos
 (long pen, square slots)

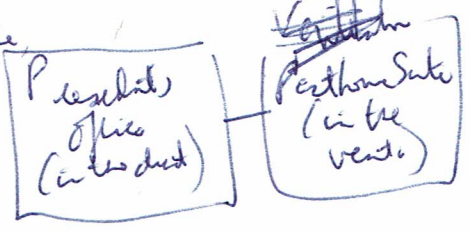

Capitop reacted to Mantle box
 says her own name.

From miss 1011
To: miss 9132
-- Calm

Say 4379 to laptop (✓ first order) } from news
~~Say 9132 to laptop (✓ 2nd order key)~~ }

Say 8121 to laptop (✓ 2nd display)

- history museum
- playa theatre
- clock tower
- terminal #4 at airport
- crisis tree (??)
- temple (??)

(Mallette is the Baron's daughter!)

miss 1011
miss 9132
miss 8121
miss 4379

