

xyzyy > That's not a verb I recognise.

JBT-BLUG
by Paul T. Johnson .28

ULALUMG
LIGHT OF SORROW

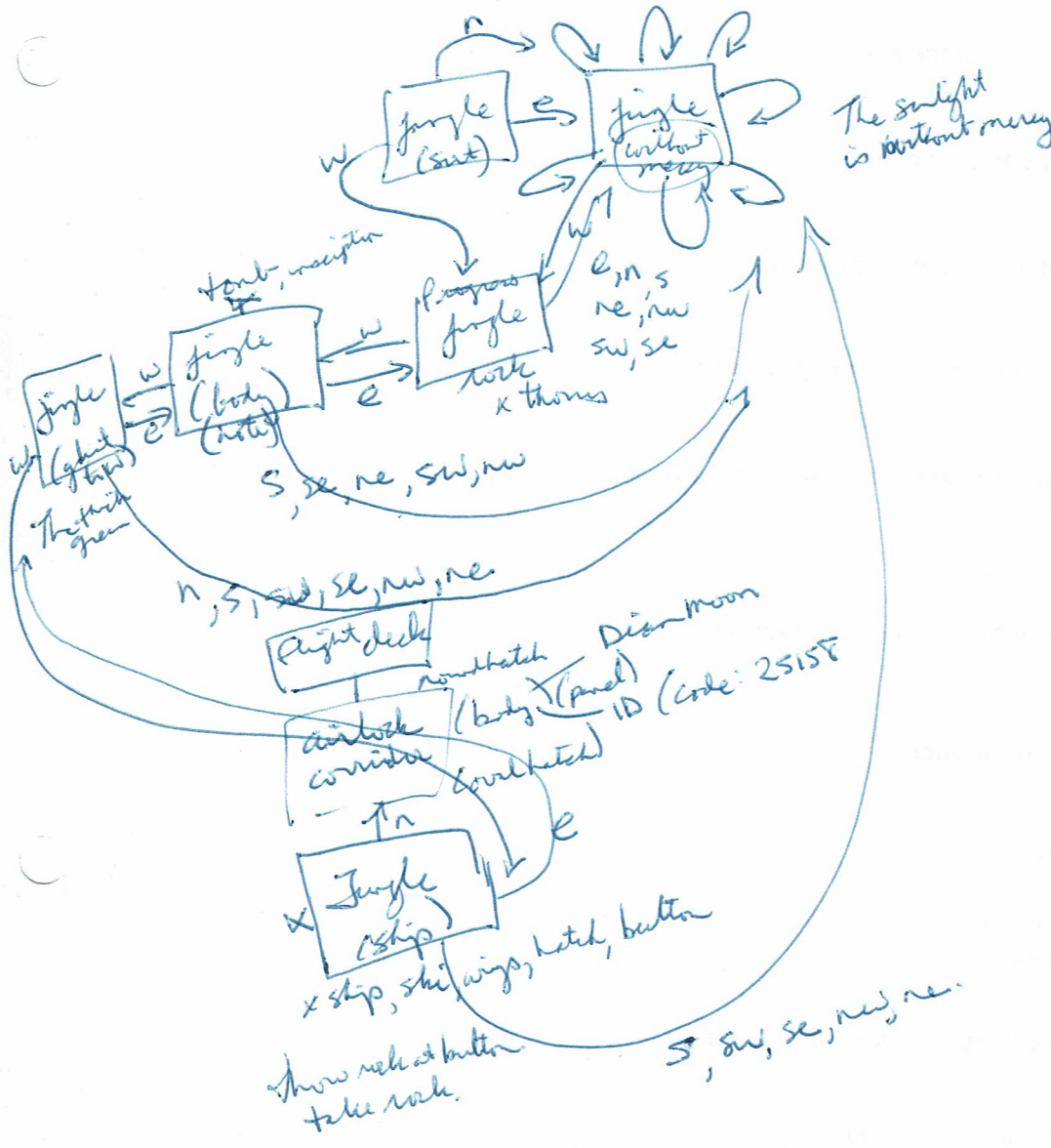

- KEYPAD
- Alpha - reboot
 - Brown - engine reset
 - Charlie - power reset
 - Delta - abort flight
 - Omega - confirm

- flight deck systems ✓
- lights ✓
 - seats ✓
 - display ✓
 - files ✓
 - keypad ✓
 - keyboard ✓
 - joystick ✓
 - belts ✓

push alpha. x computer.
(chip to last)
ask computer alt chip
talk to computer
ask computer alt typist
ask computer alt Dean
alt Ulalume
x circuit

put chip in circuit.
push brown.
push charlie (power at 12V)
push delta
say 25158 to computer
S.

[airlock corridor]
Dean (alive), ship in flight!
x panel (air con on)
n [flight deck]

e.e. [Jingle] robot shoots Fijit! x robot. x gun.
search body. take chip. x it.

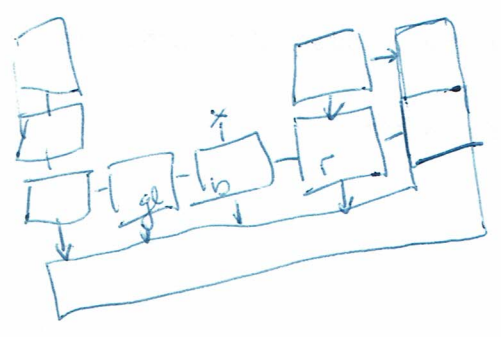

- bits
1. Ship master file
 2. Power plant
 3. Ship defense + laser
 4. Computer protection
- push button for push button (air con) (defense + laser off line, robot listing e.e.e. extent (C.))

Robot, cables, panel

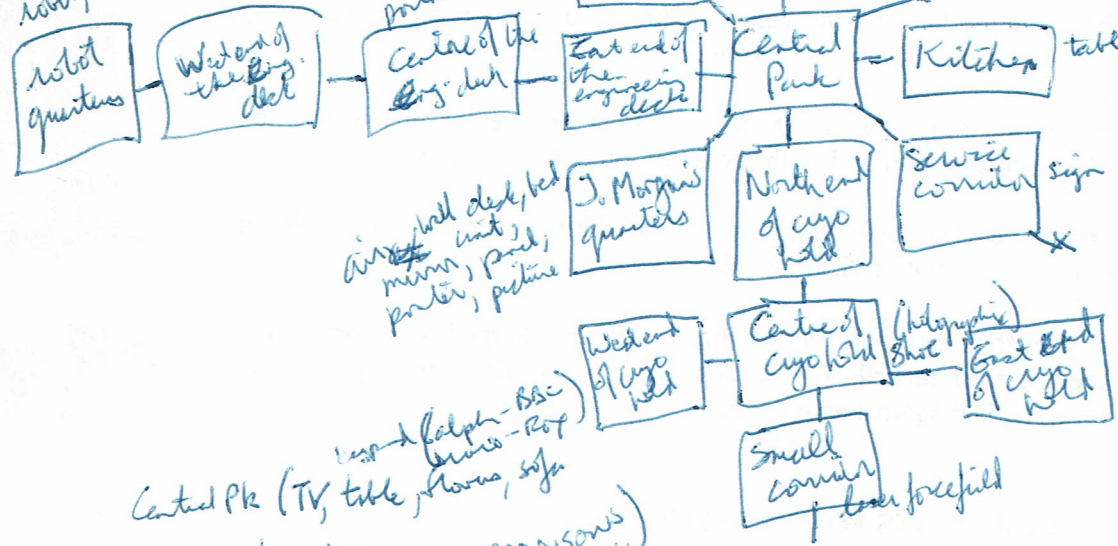

Central Pk (TV, table, floors, sofa)

Shoe/minder

x chambers, people, panel (ADDISON'S DISEASE NEGATIVE)

Small shoe (honeycomb)

x picture (Psyche I mistook go north 2x)
July 4th 2101 Cocoa Beach Florida

in Eng:
ask computer abt robot, ship, engineer

ask dia abt dia
NB: Lippell, she, to
robot ✓ ship ✓ Yarnack ✓
disease ✓ (80% of Earth's population = earth is infected)

(The Bolshoi theatre stage] ballerina introduced self as Psyche; robot follows you in
 audience applauds. music, lights, steps W+6
 ask Psyche abt robot (reply to save Ulalume & return; colony is infidel + must die)
 ask " abt addisons (new life built via space mag.; an invasion, a virus by radio)
 ask " abt Ulalume (that's a new dance. I'm a program + can't start Ulalume, but once
 I do, I must leave + can't help anyone. Do you want me to start? Y/N)

x tv. x lights. x pit.
 e [The Bolshoi theatre Eastern aisle] doors S (locked)
 w [" " Western aisle] doors S (locked)
 ask girl abt ship (doomed; all must die); y are key to mankind's survival
 ask girl abt Dior (James Moya loved her, but it cannot be saved)
 show picture to girl (You have to find + enter the tomb. All your answers are there.)
 x watch (see much @ 6:8) ask girl abt Ulalume. yes (door open, robot is giving gun
 + leaves.)
 - only you must enter lifeboat; it will auto-rew to forest after launch. w S.

[C-Deck] sign, Dior, hatch W+D. hit door. d [D-deck] panel, sign, U+D
 x sign (hatched-2) (corridor)
 open panel (ATI board) take board. d. [life boat] display. x panel (open) - (board board)
 push button - "I never stopped loving you, Dior" (failed, but know why it's do.)

dior go (when in airlock) close hatch. panel btn.
 // [stone entrance to a sepulchre] d → [Stone steps] listen. d.
 [Underground chamber] cables, lighting, steps up, passageway.
 S [Underground passageway]
 S [Underground chamber] boulder blocks exit, mirror w, bronze door S, mechanical lock.
 x mirror (Stand before us as when y were born.) x lock ("IT")
 remove suit. x mirror (A=1, B=2, ... Z=26)
 set lock to 920. S. [twelve] "Twelve", 2 btms, exts N, SE, SW.
 x blue btn ("up") x red btn ("H")

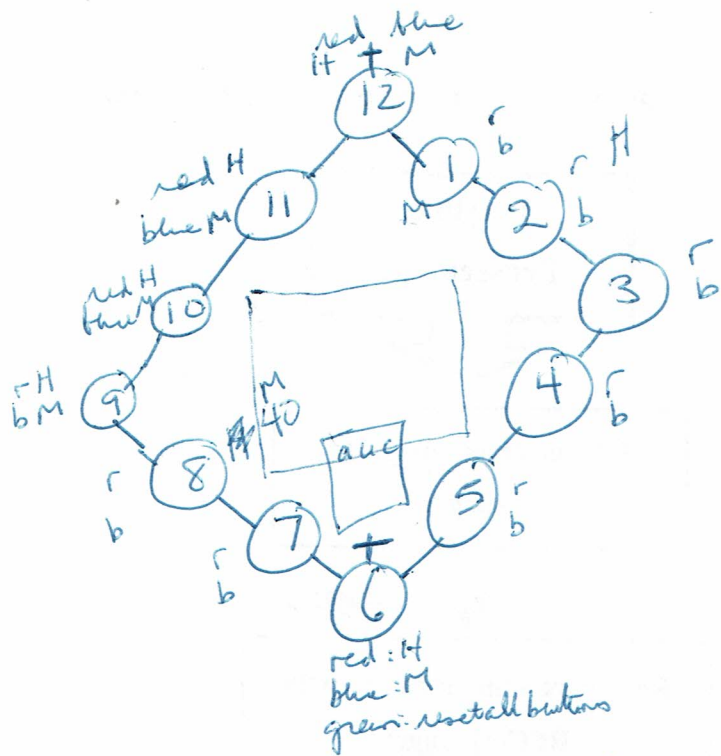

[an underground cocoon] cryo chamber. readout. panel.
 open chamber. x body. search it. take stick. put stick in slot.
 — win! (for prize: go to flight deck + "say 1981 to Dion")