

Jacky

SHELBY'S
ADDENDUM

~~2044~~
SPACE
~~TELEPHONES~~

~~Cave (hole U, downy W) detonated mines
W → Control Center (computer cloud) { lamp not water }
N → Kitchen (Fridgebuddy) { Turkey }
A → Walkway (W - bars, e → left) sagging ceiling, cracks.
W → Barrels. A dipping~~

The Cyst (Fog, W of highway
W - highway, sawall E, window (lt)
Galaxy W - lat, N - living rm, S - cyst. rubberbed, footpath

SHELBY'S
ADDENDUM

Kt table (bag), counter (btl open), window, chair, stove, cupboards.
Sandwich

living rm. window, curtain (#), bureau, chair, fireplace S, mosaic,
rug, oak boards, archway NW.

NW → E W Corridor (bedrooms N + E) W - Workarea (and continues N from there)
(E → Shelby's km (bed, boxes, desk, closet, notepaper, train ticket)
N → Holcomb's km (candelabra, bed, desk, chair, closet, dresser,
washstand, towel rack, weighing scale)
desk { diary, employee report }
↳ crystal in secret chamber behind my quarters.

836 since Dec 11, 1905
push eye "type" #836" take bracelet, wear it.
search safe.

sid of kitchen (broomstick, solid moped) - sticky brown substance (blood?)

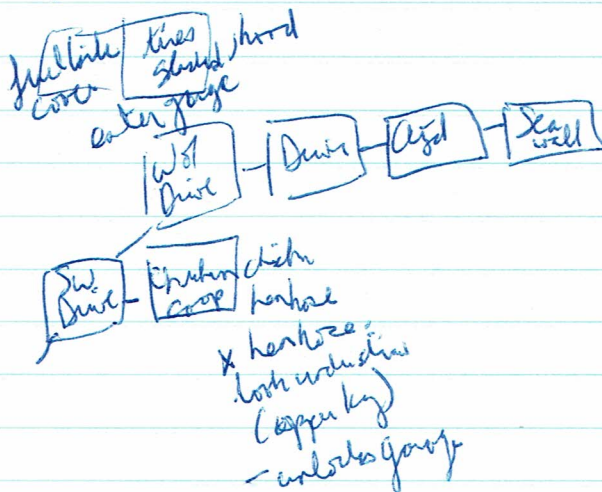

THE LIGHT:
SHELBY'S MANSION

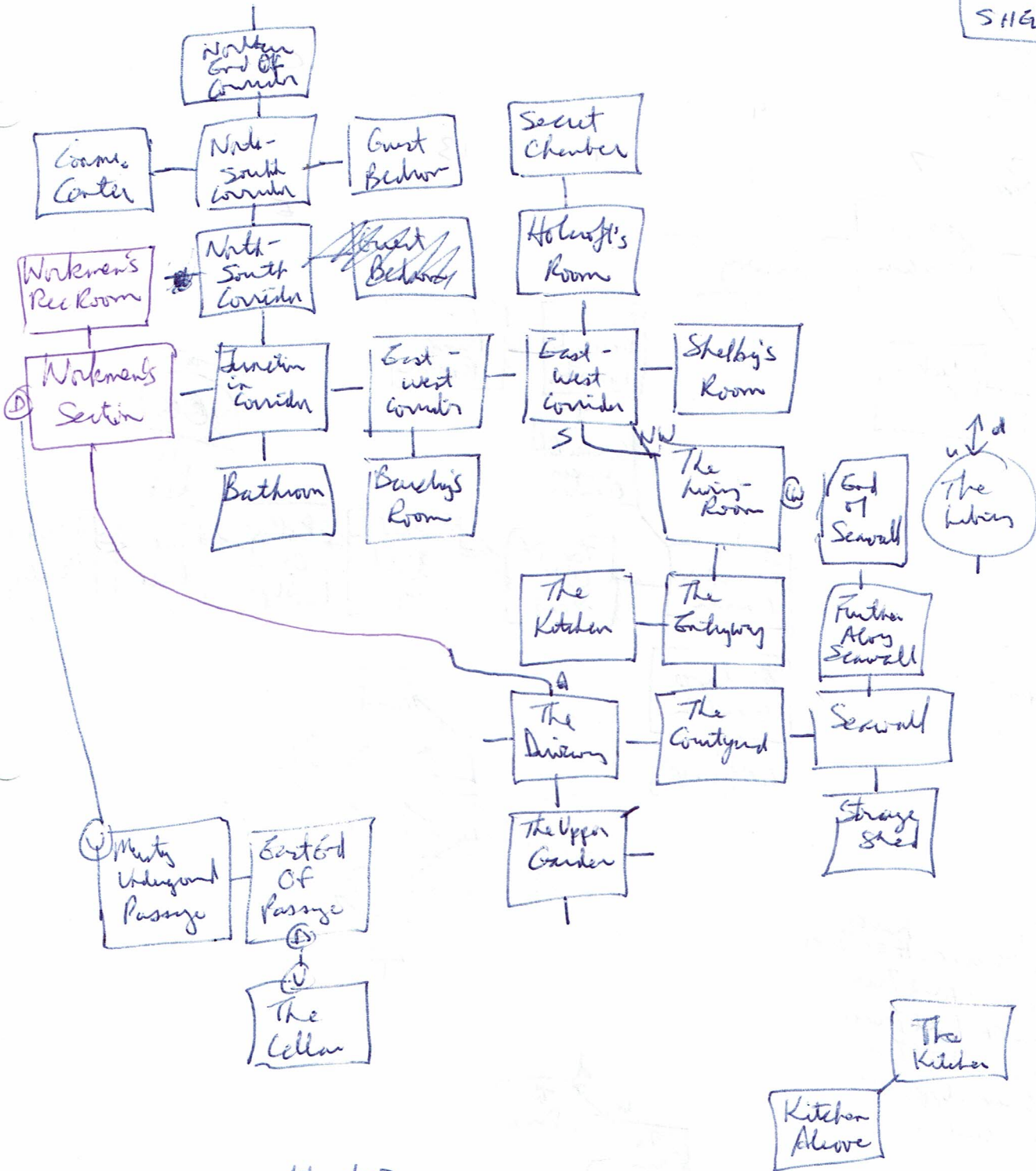

- open partition door
- open Barely's cabinet
- find H's crystal
- use H's scale

(left the beerstich in the cellar)

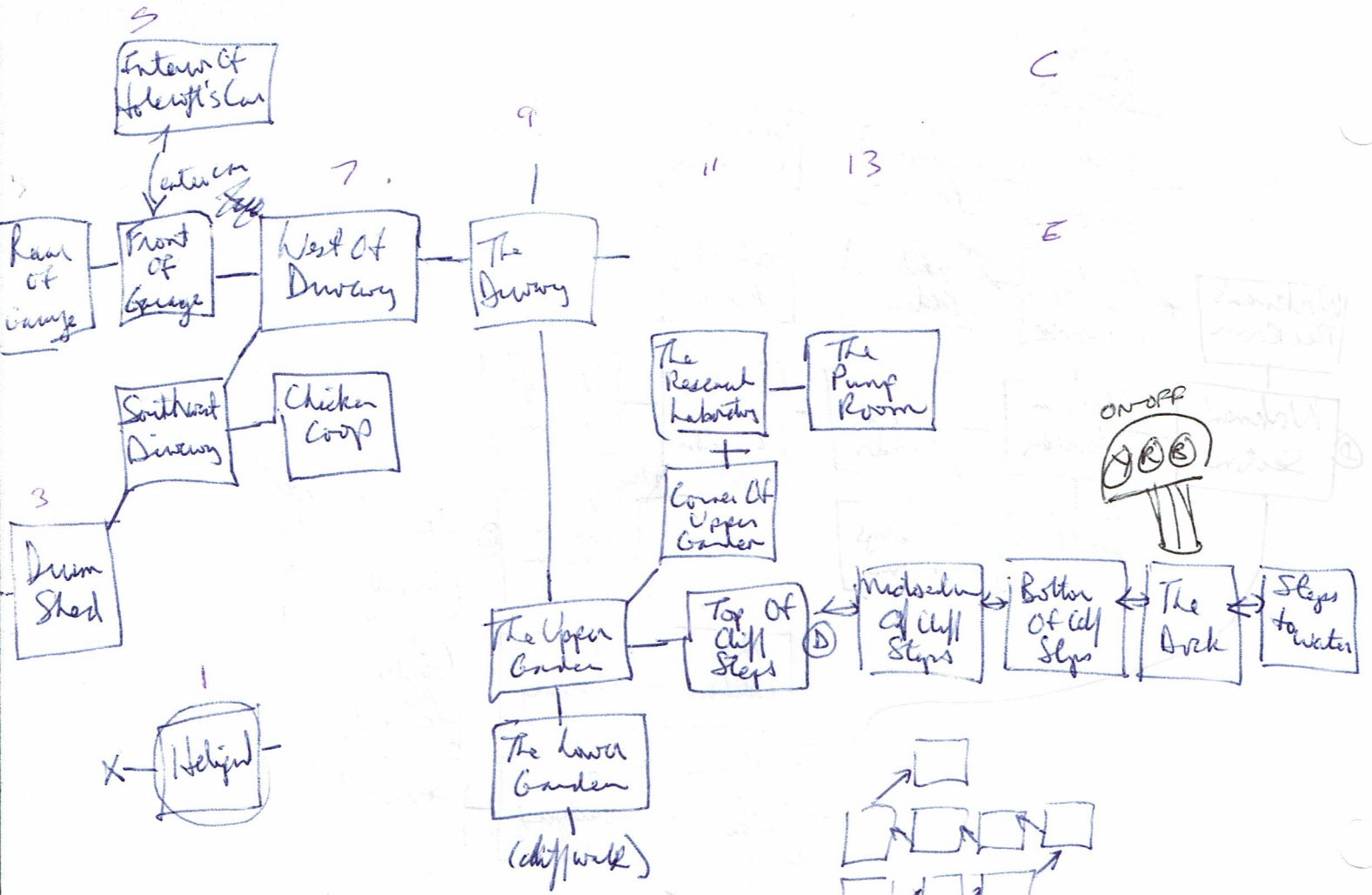

The key,
 3x Spiral Stairs: ~~Mid Tower~~ ^{lower}
 Spiral Stairs: Mid Tower
 Missile of light Tower
 Spiral Stairs: Mid Tower
 Spiral Stairs: Upper Tower
 The Antic-Chamber

