

hurling Honor

"Greetings"

Start: Terminal Room
 (need to write 20-pg paper)
 - assignment (from "The Classics in the Modern Tradition"
 0224-014 - on modern analogues
 of Xenophon's "Anabasis.")

Logon: 812325412
 Pswd: UHLERSOTH

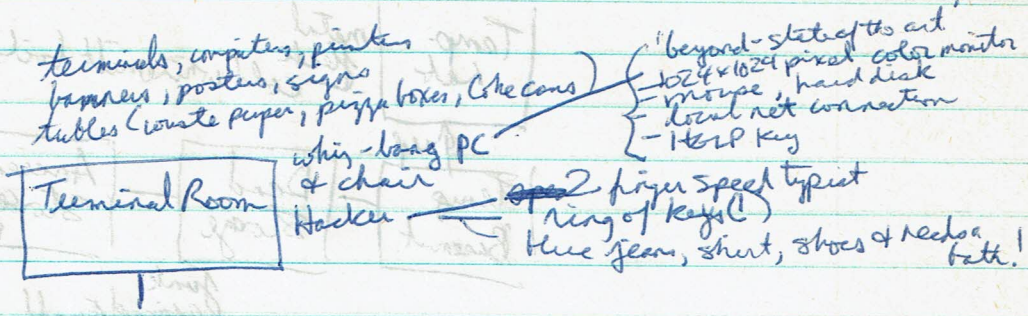

- list of tasks
- menu box EDIT CLASSICS PAPER
 CLICK MENU BOX
 (YAK text editor)
 CLICK RFD BOX
 (your paper is replaced by incantation?)

- Hacker takeover chair
- snow & unusual characters
- funny of windows opening
- fixed directory (your file
 mixed up with files from Dept of Alchemy
 mode is "lovecraft")

3rd page

"He returns, he is called back (?)
 The loyal ones (acolytes?) make a sacrifice
 Those who survive will meet him (be absorbed? eaten?)
 They will live, yet die
 Forever will be (is?) nothing to them (to him?)

open valve
 with cutter

"His place (lair? bureau?) must be prepared
 his food (offerings?) must be prepared
 Call him forth (invite him?) with great power
 Only an acceptable (trustful?) sacrifice will call him forth
 He will be grateful (saturated?)"

4th page [photograph: is that a mouth & what is in it?]

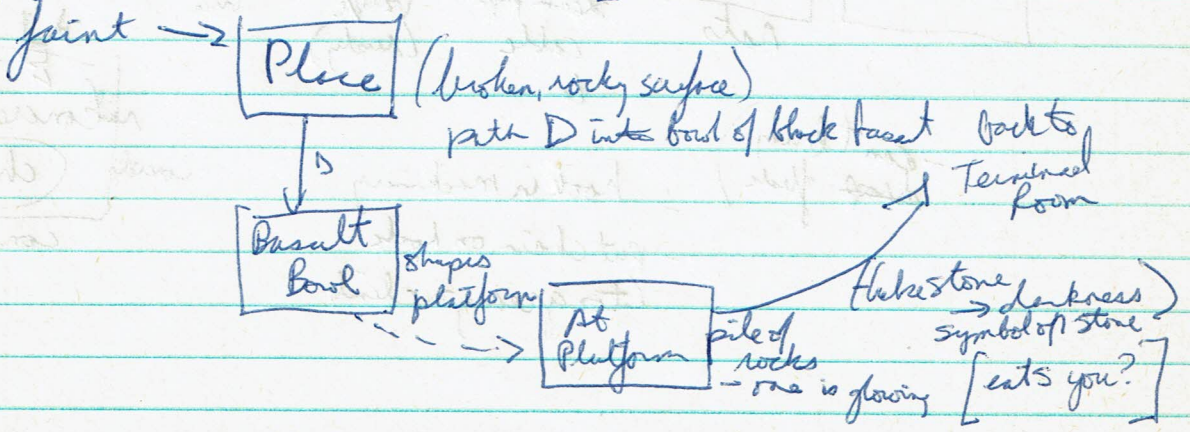

Smith St.

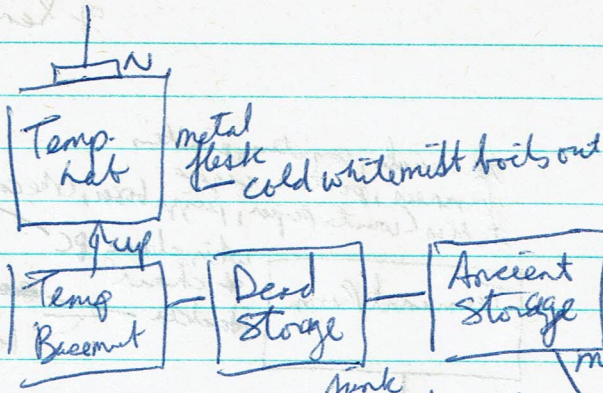

junk
Jagimud Ewell
on pallets (heavy)
(4 times)
MOVE PALLET WITH FORK

LIFT RING WITH BAR
Before the
Altar

- Before the Altar
- carved dirt symbols (incised)
 - red stains
 - iron plate in floor (2' sq., staked, upward dents)
 - sharp, thin bladed knife

Renovated
Cave

Beams of wood
iron + steel
flat slab
of granite
(3' high,
circular)

Brick
Tunnel

mortar
bricks + slabs

concrete
floor +
ceiling

Cinderblock
Tunnel

cloud
plate
incision
(1/2" or few inches)
but then hits something &
goes no further)

rusty steel
reinforcing rod
in hole

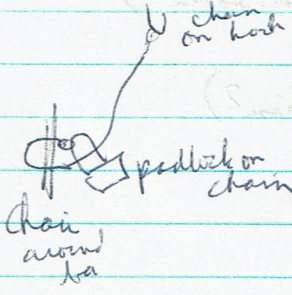

CLIMB
CABLE

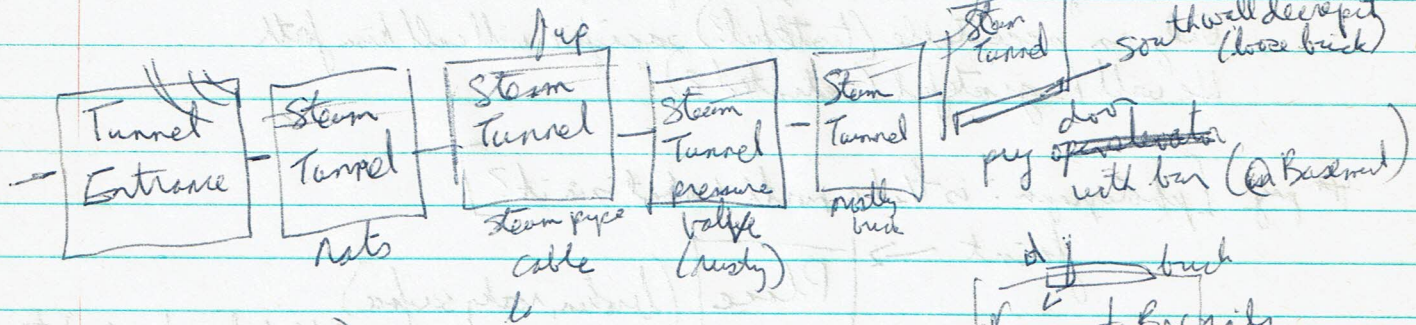

- can't bring
drop flesh

hook in machinery
put chain on hook
(too greasy to climb)

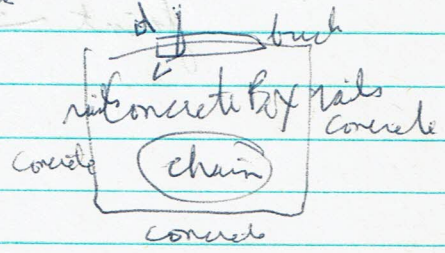

> PRY ~~OFF~~ DOOR WITH BAR

You force the doors apart with the crowbar, barely able to hold them open. Beyond you see the elevator shaft. In the elevator shaft a tangle of machinery is visible. The machinery has that malevolent appearance that means danger.

URCHIN, HI

ASK URCHIN ABOUT STUDENT

" " " KIDS

LOVEKRAFT

PARACELSUS

DUN SANY

Show reports to Prof. — "What a dive! I could have helped him"
Dufe — "I'll take that!"

Lab bench (vat of tarry liquid) — lab coat
Alchemy Dept computer — brass ring (just a hint)
pentagon

— "Lovecraft" written on display
— Elixir is thick & tarry (bubbles?)

— brass hyrax (ring)
— piece of paper

computer needs disk.

POUR COLD LIQUID ON TARRY LIQUID (destroys both!)
vat: "Elixir of life" (glass or pyrex)

show hand to hacker
 "Mondo grosso"

show hand to uschin

"I heard what happens around here! I'm not getting fed to a monster!"
 - bolt cutter (cuts bolts or chains)

dead rat
 (forlign?)
 - it runs away.

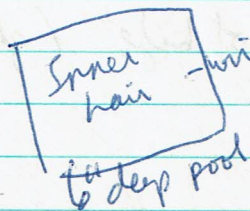
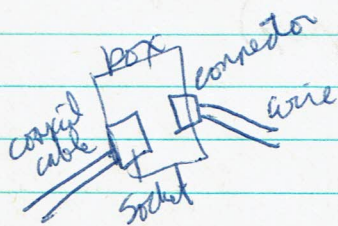
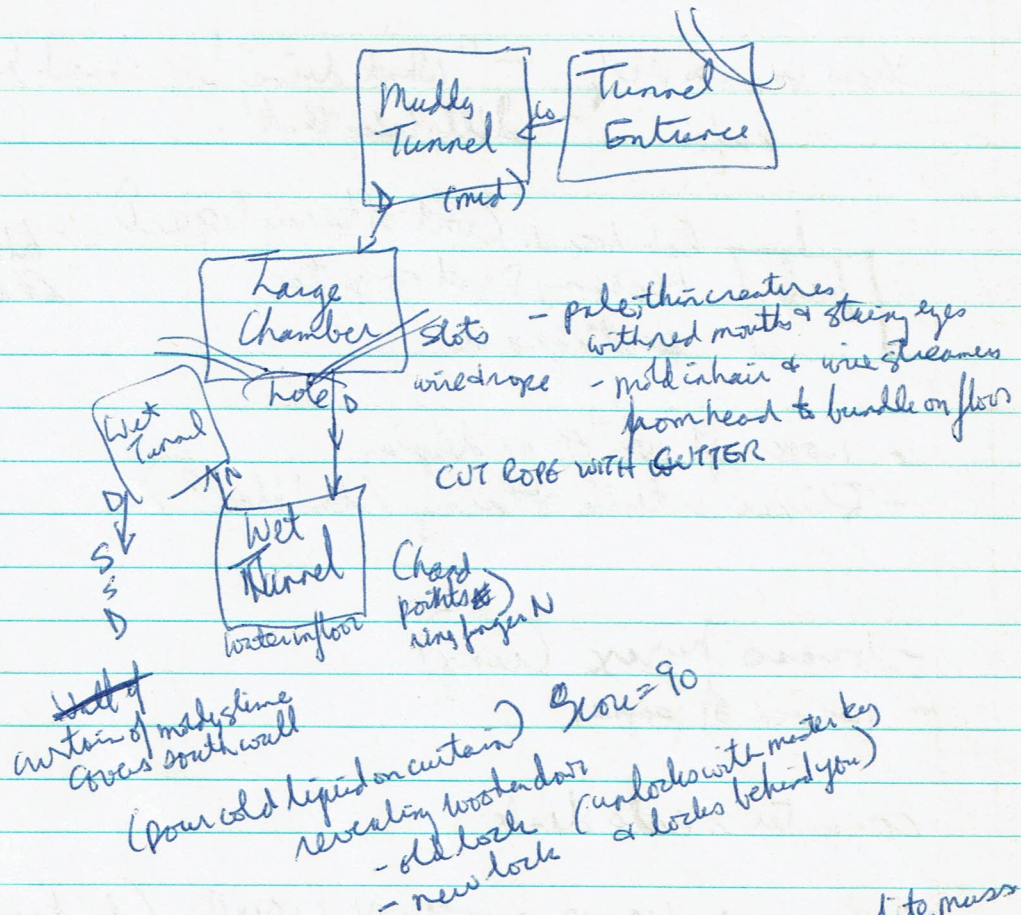

- wires drop into large white mess
 - metal box with cover
 coaxial to mess
 - hand dives in pool
 - hacker enters hair!

line below surface

- maintenance man using floor waxer
- wall socket & waxer plugged in it
- cabinet has fire axe

On the Great Dome

bronze ply
- reveals paper

"I can no longer face what I've been doing. I can't sleep, I start at the slightest noise, & even dulling my senses w/ alcohol or drugs is no longer enough. I refuse to participate in what he is doing any more. Either he is insane, or I am insane or (which is what I fear most) the universe itself is insane. I have only one final warning: I am the only suicide, but I will not be the final death."

- name of Alchemy book

Factory (Moggy floor waxer & Desert Loppies)

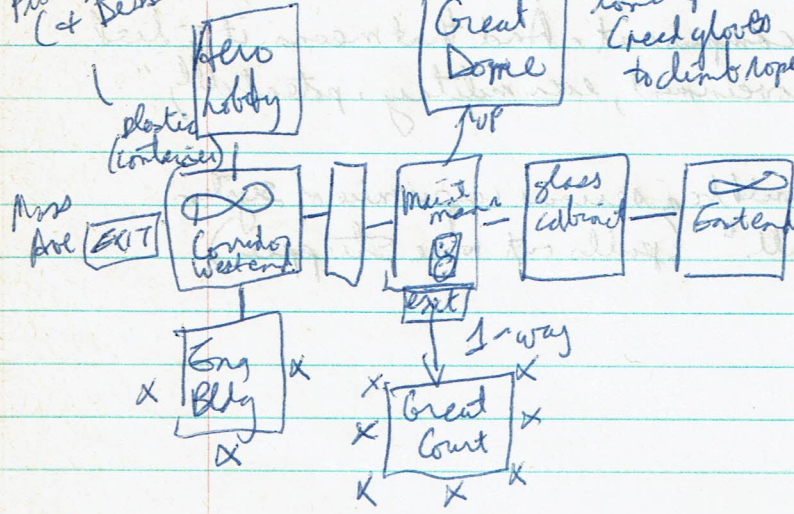

Pool of Great Dome

Top of Dome
- ladder
- metal door
- catwalk

Great Dome
- shiny
- come up
- (need gloves to climb rope)

- you climbed a tentacle! of pulpy mass

Carol's Sat night

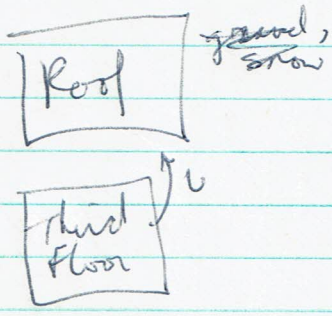

- elevator
- flashlight in panel
 - graffiti: "Kilroy was here"

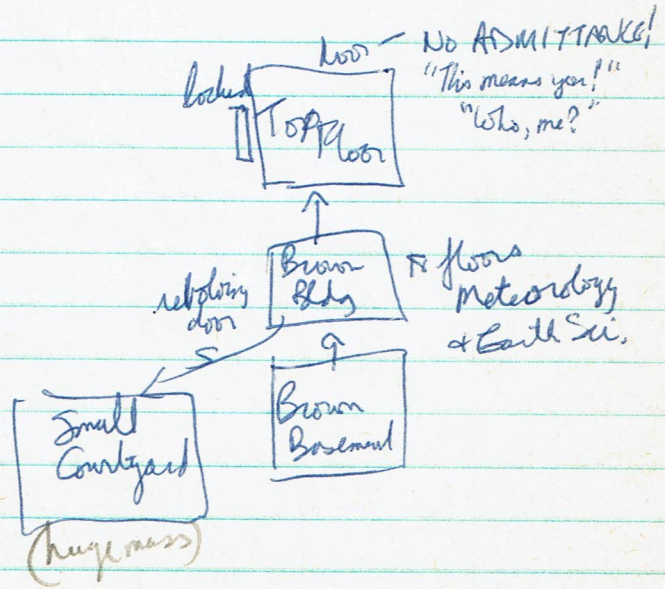

"It's you! When I gave you my key, I never suspected you'd get this far!"

"I got my suspicions about your problems with the net. I began to trace some coax, found some repeaters & bridges that weren't on the layout charts, & started following them. Anyway, here I am. That thing there, whatever it is, & those wires, are interfaced to the whole campus net. And that means it's tied into all the nets, commercial, government, even military, potentially."

"I guess I better do something. It could be a serious compromise of system integrity if this thing isn't dealt with." (pulls out wire cutters)

- lift line

2 min med - lukewarm
 4 min " - warm
 6 min - hot
 14 min - volcanic

Master Key

green aluminum Medics
 green brass Taley
 green aluminum tile
 red aluminum tile

cold Szechuan shrimp
 red peppers pate out of sauce

- oven
 - 0 to 9
 - NM
 - LO
 - MED
 - HI
 - START
 - CLEAR
 - STOP

2 liter Classic Coke
 curries (symbol)
 Chinese food
 Refrig
 Microwave
 Package of 6 Furry Bones
 (peanut butter & choc. cake)

Terminal Rm

stairs up & down

2nd floor

Elevator

claw & buttons
 fake wood/graffiti "Tech is hell"
 B, 1, 2, 3
 open/close/stop/alarm
 access panel

3 min at MED
 - radioactive (overcooked)

ASSEMBLY

- within 10 min out of snow
- eats Furry Bones in record time

Hatch -
 (W) Authorized personnel only
 (This means you!)

"The Tomb of the Unknown Tool"

graffiti
 locked hatch
 - within

Aero hobby

Smith Street

Computer Center

Elev

Steam Tunnel

steam pipe
 muddo/fungi
 insulation
 cable

pressure release valve

pitch black

Stairway

New Basement

Basement

Temporary Basement

Elev

wire channels
 steam pipe
 (electrician's gloves
 crowbar)

pitch black

Subbasement
 within

teenager in Skitch, bumpy
 runners shoes & threadbare parka

stone is smooth & cool

- break glass with comb
- wear gloves
- cut cord with axe
- pop in container, pour wax on man

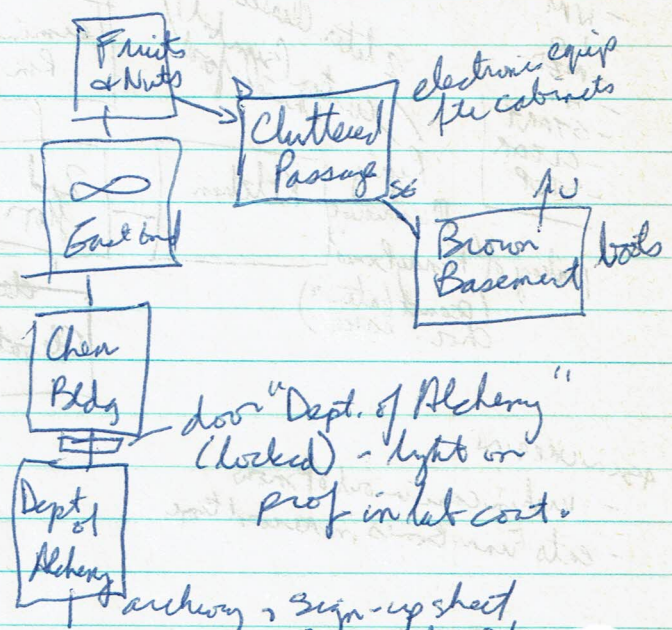
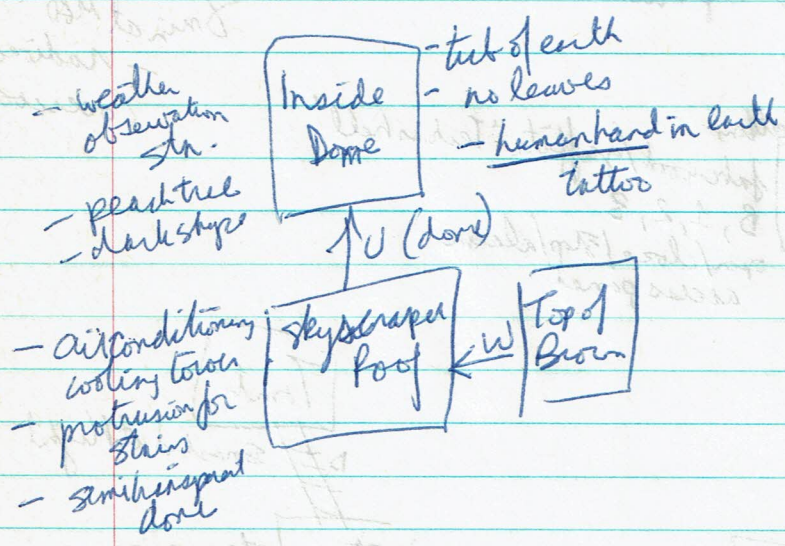

ask prof about LOVECRAFT

- machines in our dept have names like that. I wrote some stories about alchemy. We're got Paracelsus, Dansey, and a couple of others, too. (bored)

show stone to prof

- "Very interesting! I'll take that!" (malign)

ask prof about STONE, ASSIGNMENT, CREATOR

- uninterested

ask about GRADUATE STUDENT

- "I don't know anything about them. Tech is high pressure. Some people can't take it"

ask about LAB

- stops you from entering

Inside Dome

- you can repeat the creature with the stone

Don't try to animate the hand first yet.

Throw stone at creature. Take stone.

You can get both stone + hand to Skyscraper Roof

There, throw stone at creature; recover it outside

S of Brown Building. Don't bother the "mass" outside.

- It takes 3 turns in the vat before the hand animates properly

- ring fits both your hand & the hand.

Show hand to archer

- he'll scream & drop ~~stone~~ bolt cutter.

~~Open~~ Open valve with cutter twice. Open fully when rats there. Take dead rat.

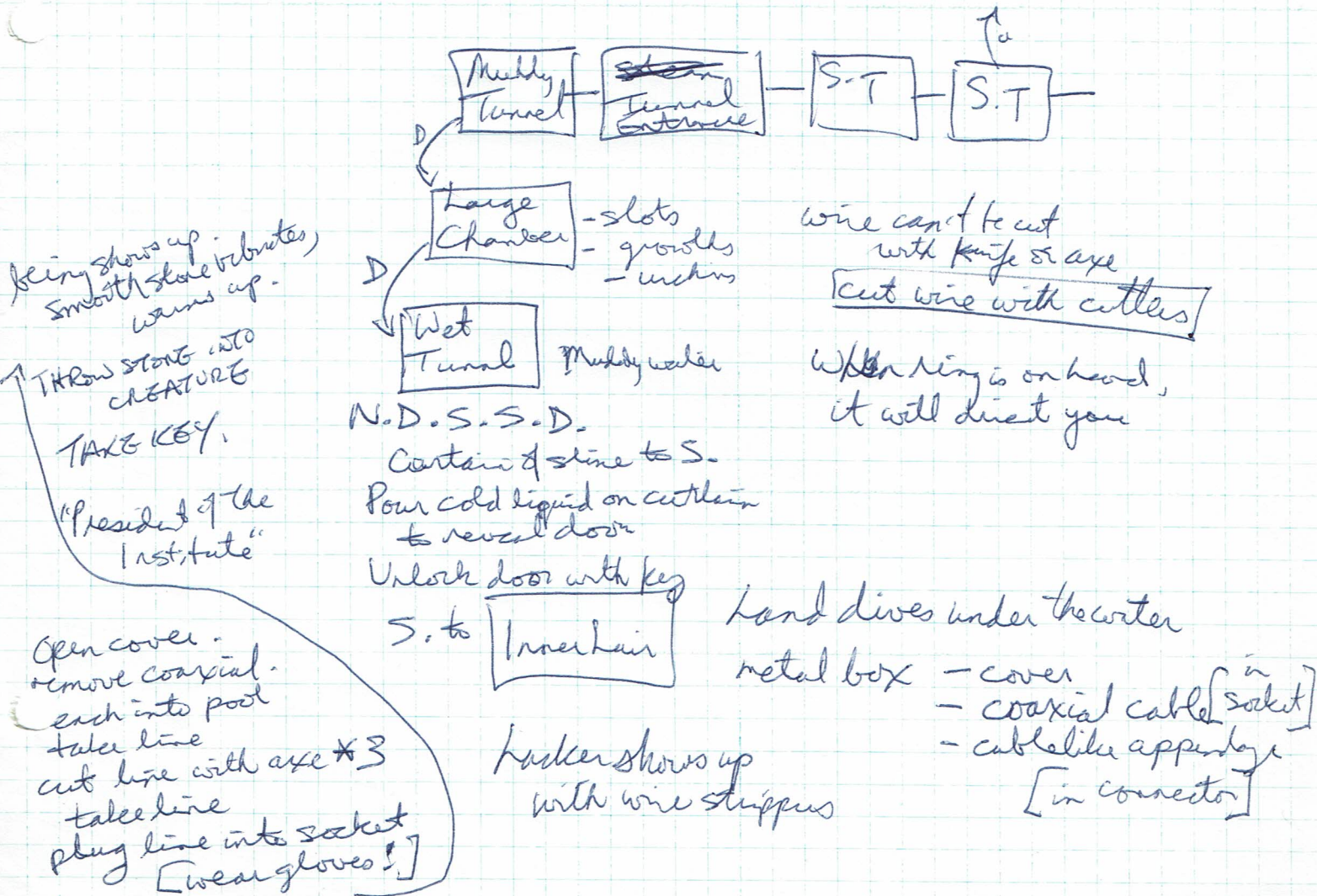

Terminal Rm

- strict c assignment
- hacker has keys
- turn on computer.
- Login Please: ~~type anything~~ ~~LOGIN~~ ~~down~~
- Password Please: ~~password~~ ~~up~~

LOGIN 872325412 ← from your STUDENT ID CARD
PASSWORD UHGRSOTD ← from G.U.E. & CLANCE

CLICK MENU BOX

CLICK RED BOX

READ TEXT

CLICK MORE

CLICK MORE

CLICK MORE

CLICK MORE <you faint>

at Place D

at Basalt Bowl D

at Platform TAKE STONE (has symbol scratched on it)

back at Terminal Rm.

for hacker

Cook Chinese food at 5 or 6 min
@ Medium. Ask hacker
about keys. Offer Chinese food
to hacker. Ask for hacker for
master key.

Keyring has
Green aluminum Medusa key
green brass Yale key
green aluminum Yale key
red aluminum Yale key

Kitchen - refrigerator [bottle of Coke + cardboard carton [Chinese food]]
- microwave oven
- packages of Punny Bones (snack food) [for urchin?]



Tomb - can't get flask into this room!

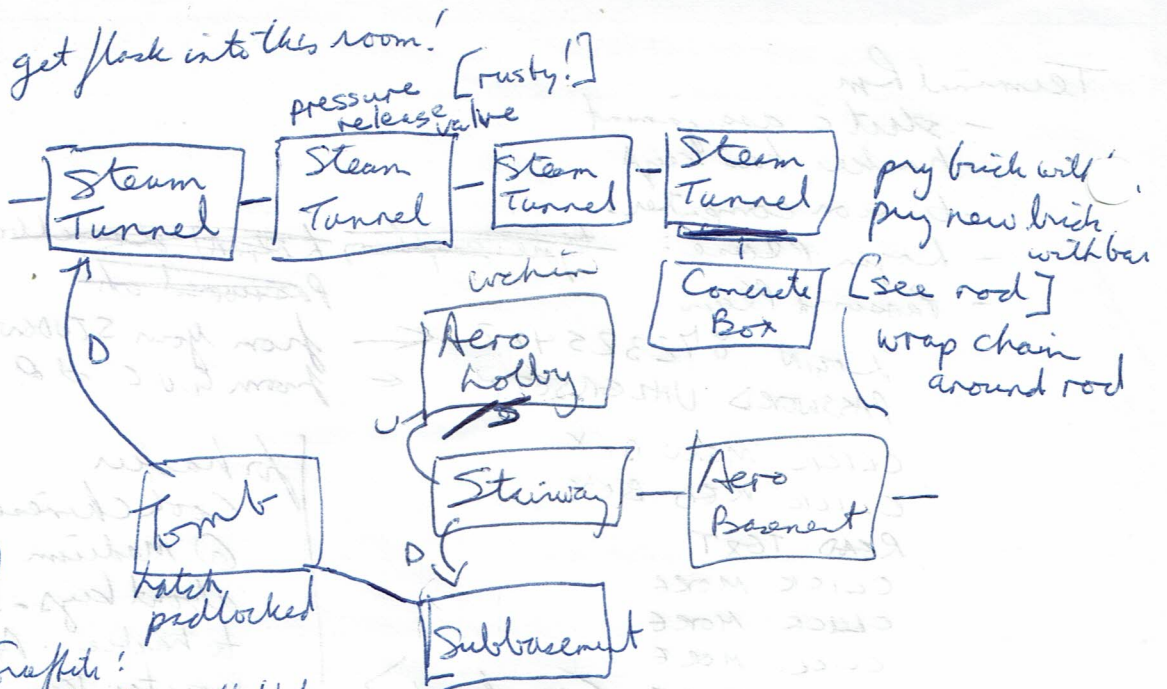

Grapple: "The Tomb of the Unknown Tool"

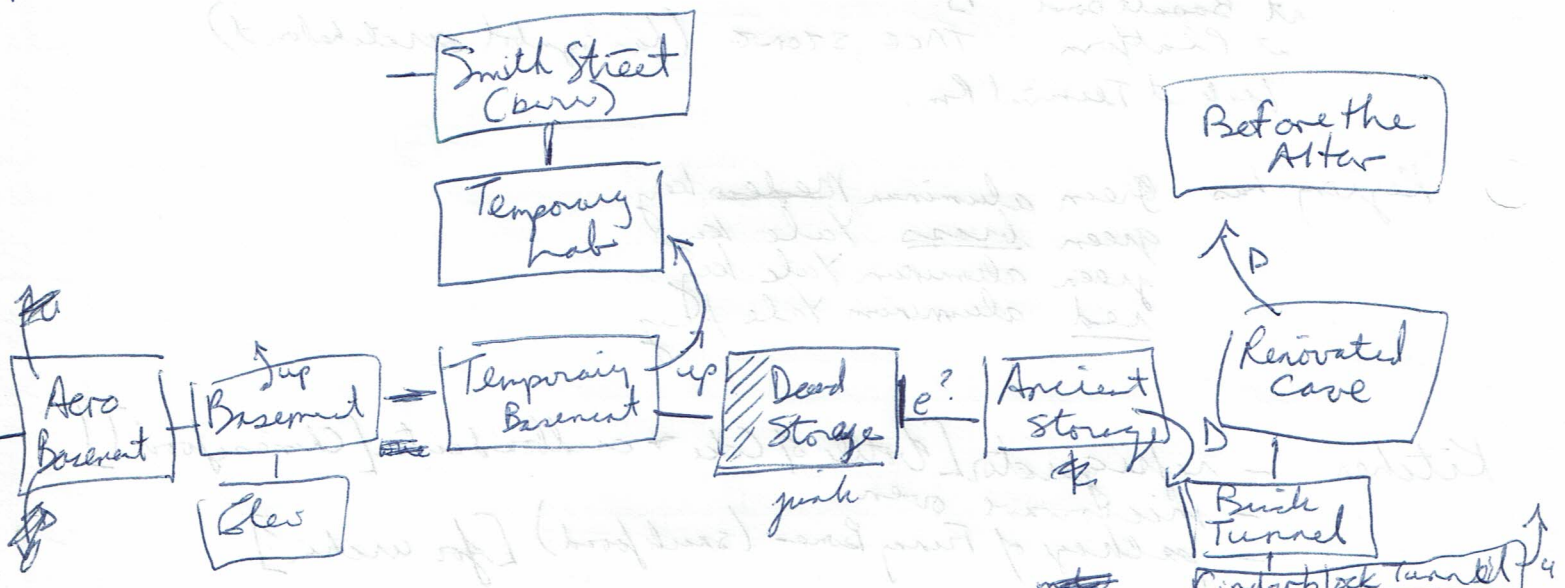

Basement
wire channels
& steam pipes

Temp. Basement
de-gloves
& crowbar

Temp hab
metal flask [cold white mist? inside]

Aero Basement
- forklift (get in, turn on, e, e, e, move junk with forklift 4 times)

Dead Storage
- move

Ancient Storage
- mold
- menthole
[lift ring with crowbar]

Cinderblock Tunnel
ladder to closed plate in ceiling

Before the Altar
- slab of granite [symbols, stars]
- iron plate in floor
- knife

Elevator

- graffiti [I.H.T.F.P.] [Ketrov was here] [Tech is hell]
- floor buttons B, 1, 2, 3
- open, close, ~~alarm~~ buttons
- stop switch
- access panel [contains flashlight]

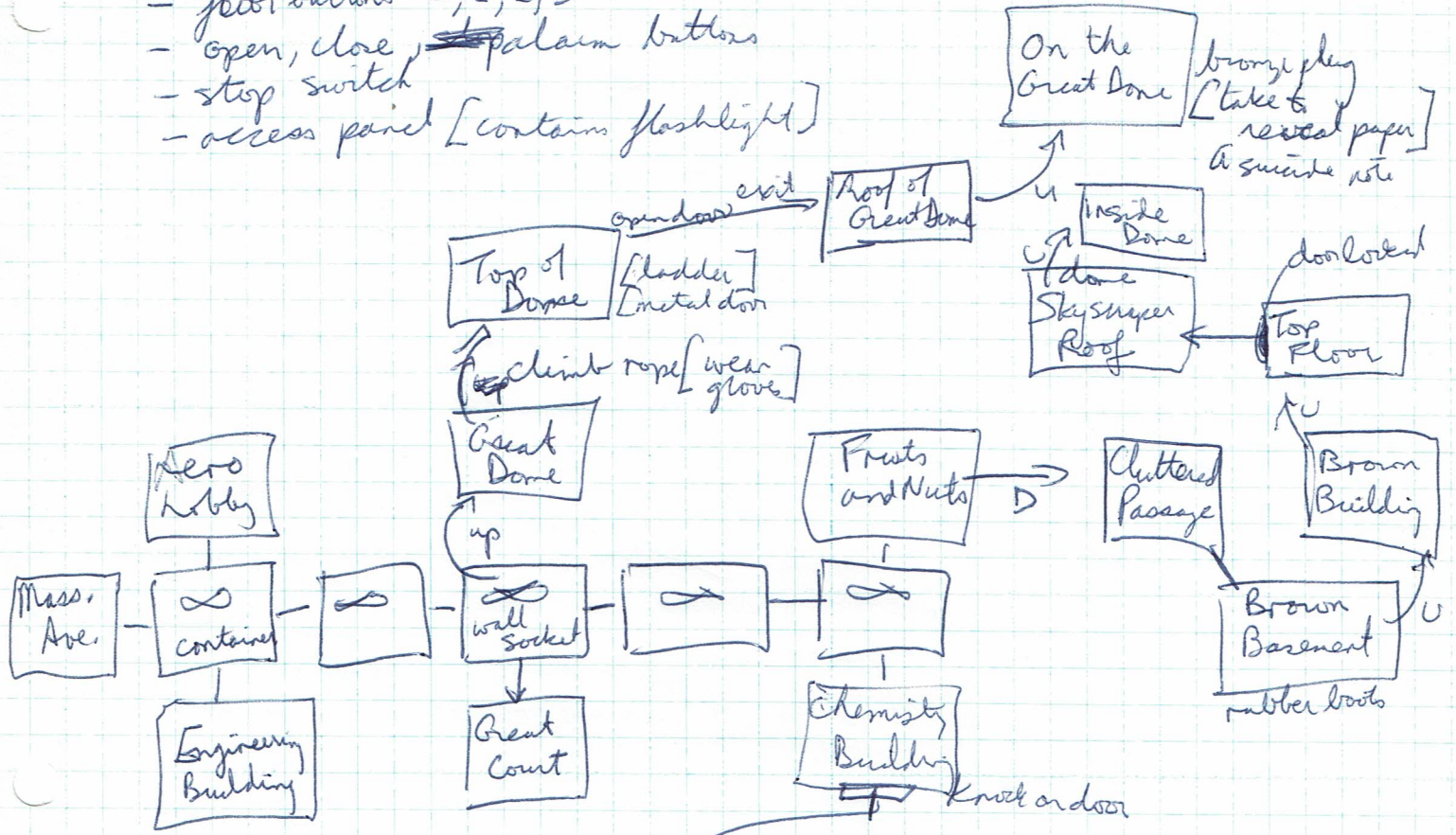

Inside
- creature not killed by axe

Top of Dome
~~lower~~
lower LADDER
(heavy)

Inside Dome
- equipment
- peach tree in tub of earth
- dark shape
- search tub & find human head

Dept of Alchemy
signing sheet
prof [how to get to lab?]
Show paper, then go S.

Lab
- vat of tarry liquid
- computer
- pentagram
- cut pentagram \bar{c} knife
after he's entered his.
~~then get out there!~~
Exit pentagram
Push bench
Open trapdoor
D. ~~close trapdoor~~

nyrax