

- searching for gold treasures

Bring all goods here + say "score"

MERLIN'S  
GOLDEN TROVE  
by John Olsen  
© '92, Doo

[Outside castle] sign, drawbridge S, moat, castle iS-}

S [On Drawbridge] present N, gate S, moat below d → [In Moat] frog  
S [Dusty Cyl] N, S, E, W S [Great Hall] table, gallery E+W, kt S, stairs U,  
laptop, W, platter (ex laptop ⇒ find W) goblet  
S [Kitchen] pit, tbl, door N, iron pot, fork cheese.

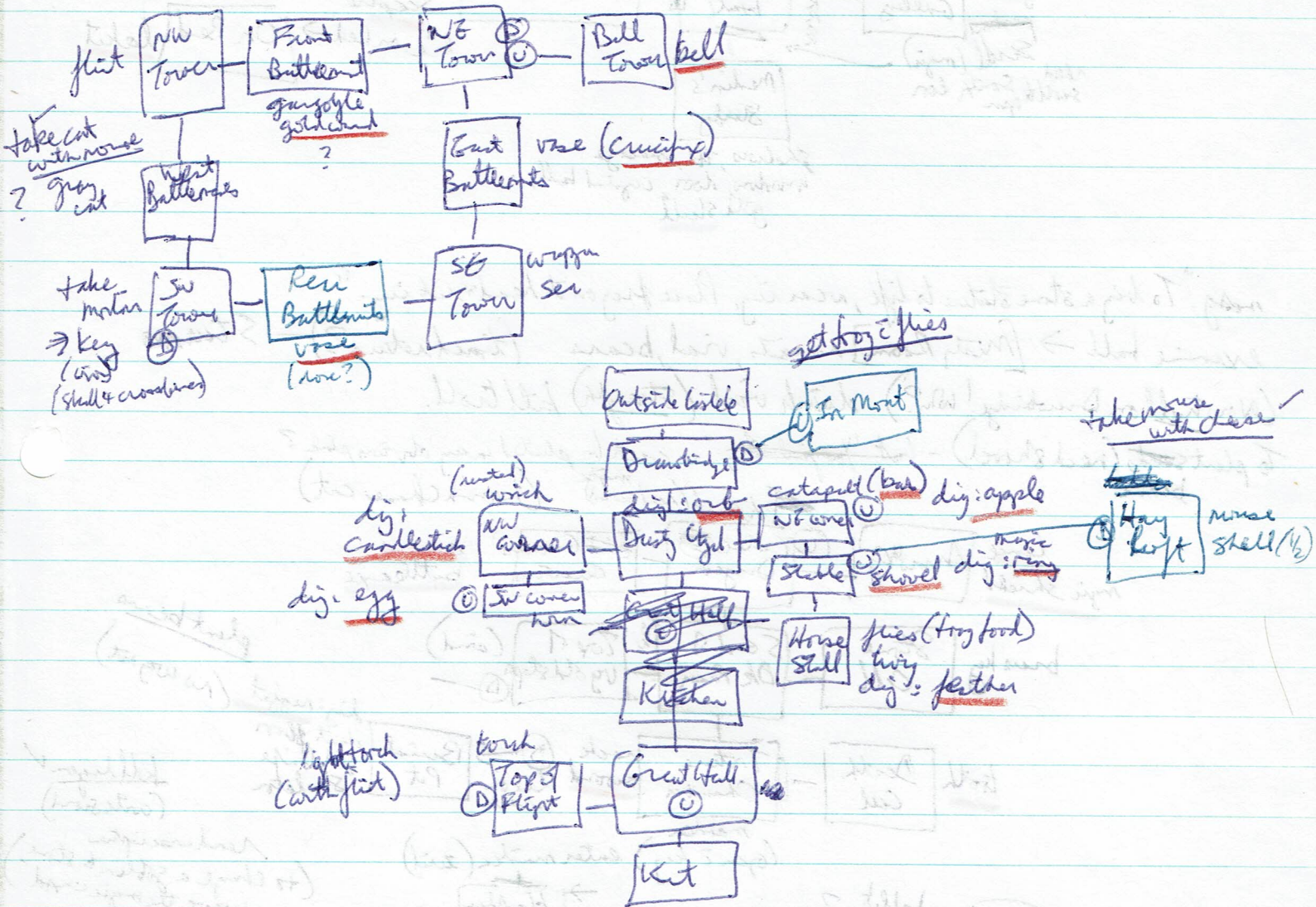

- |            |                |                |           |             |               |            |
|------------|----------------|----------------|-----------|-------------|---------------|------------|
| 1) orb     | 6) bar         | 11) shovel     | 16) vial  | 21) locket  | 26) tooth     | 31) tablet |
| 2) goblet  | 7) fork        | 12) wand       | 17) skull | 22) lance   | 27) sword     | 32) coins  |
| 3) ring    | 8) platter     | 13) bell       | 18) flute | 23) sceptre | 28) shield    |            |
| 4) apple   | 9) candlestick | 14) crucifix   | 19) arrow | 24) vase    | 29) medallion |            |
| 5) feather | 10) egg (33%)  | 15) rose (42%) | 20) axe   | 25) crown   | 30) key       |            |

~~more~~ mirror, more mirror.

chest key  
 iron key  
 brass key  
 twig  
 horn

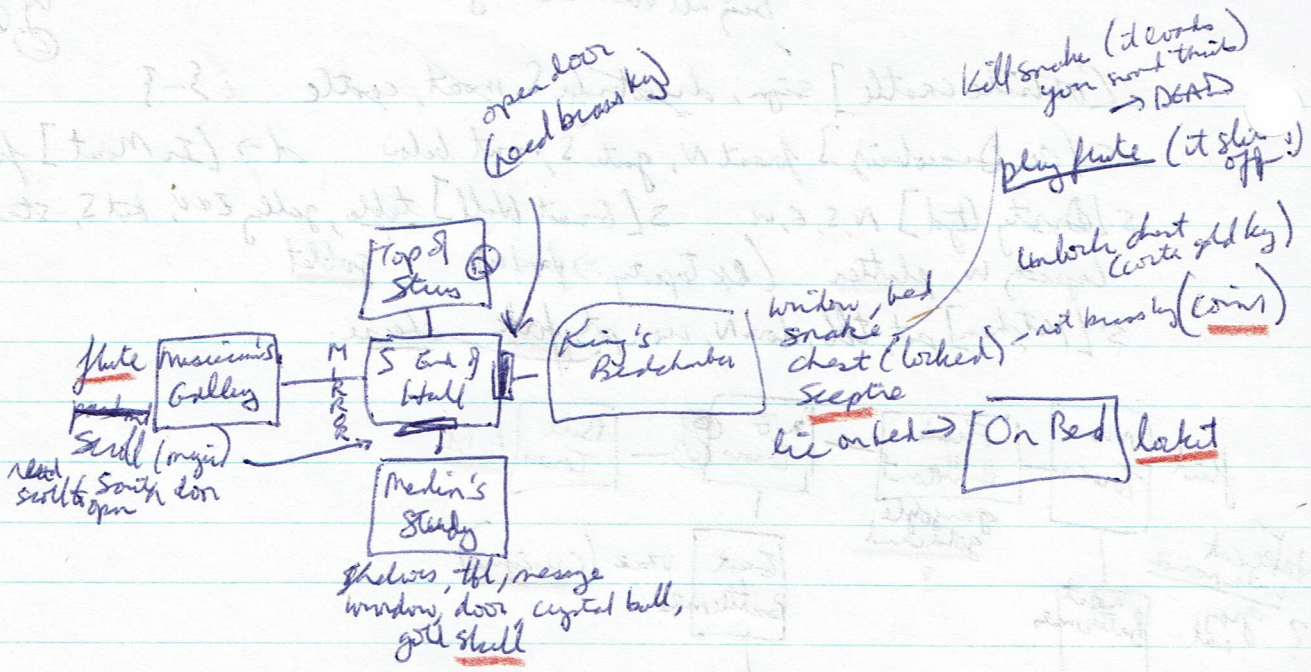

msg: To bring a stone statue to life, wearing three frogs on the head & rubbing.  
 examine ball -> [Misty Room] no exits, vial, beans (timed return?) - Steam  
 (Now hall on Smoking! why?) drink vial (strength) kill troll.  
 To plant seeds (need shovel) - but 'you find beans' - can't be planted in any obvious place?  
beans

