

hairs (blood, gore, eyes, etc)
 y = Corona laptop screen; Fri 7:30; Dr. Mammie Ephant escorted to Test Chamber.
 (Other docs: Raymond, Best) (Obs. room lit. thru combi for one)

One Eye Open
 . globe

7

[Test Chamber, Corona Labs] desk, chair, keypad [circle, cross, wavy, square, star]
 camera, w door to antechamber, glass (curved desk in obs. room)
 x curved desk { Dr E enters obs. room + cards + notebook }

2x3 (Dr E leaves a film + photo; study the scene closely)
 x both (left, red text?) x hair (brushed, kinky, pulled) x eyes (you - check them)
 x desk (beige wood) x background (-) x clothes (-) x hands (pinned x chin (-))

- slightly wavy (slightly worse, cut red; finger fingers left, right, tense?
 x hair (darker here, straight, no bang unbrushed) x book (college)
 x face (at to front) x desk (former beige wood) x hands (very pale, veins show thru, tight fists)

x entrance (square of black dots under entry)
 out -> [Antechamber, Corona Labs] fake palm, chair w (to hell too, wrenching sensation)
 e -> (door closed now?) open exit door (locked) x plant (living ficus tree now; two fake palms)

open hall door w. [Hall B] walls are white under of light blue-green, yr room 320 is w.
 paper free-down, left of door. x paper { it shivers, torned }
 red paper (5/12/78, so sick, psychic spike, echoes of cross. Dr. Ychuda. Is Theo hurt? Did he hurt you?
 Jan over edge. Theo left "Sandoz" pills of dead; I'm wrong, then; if I free Jan, I met Theo's edge
 smthg awful is abt to happen. EGB)

is [Room 320] wavy spike from front to ceiling, fixing corpse of a dk-haired woman. bed, bookshelf, dresser stacked w
 shredded paper, broken umbra. x woman (washed in '70s) x spike (like cat jump, but huge)
 x bookshelf (off one only) / search shredded paper - (Alice's Day 5/12/78, mouth bit room in half,
 don't know when Jan's. I'll wait here + we can be together + stop awful thng. Pls come back Jan, I love y.)

N of Hall B -> [Hall Intercom] N/S/E, w: elevator, call bng, bllg any
 x map (Med. Army Hospital, only down left corner unmarked)

x floor indicator (Basement)
 N -> [Hallway, not Army Hospital]
 N is dk. breeze from Sts. shadow N
 Washroom E, swings red w.
 x panel (leaky chute with shark's teeth
 & smthg caught on the teeth)

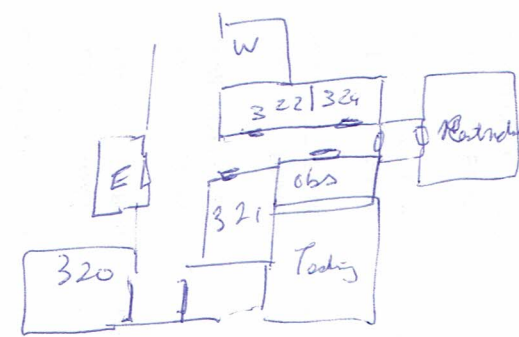

E -> [Bathroom]
 corpse in toilet, folded in half,
 sink, mirror + cracks, stubble light.
 x wryse (make orderly or nurse, omit blood)

E → [Side Hall] N (in 322 is locked) S (in 321 locked) {imm doors flap open in 'north door'}
E → [Side Hall] (including door, window, keyhole) E,
S → [Room 323] [Room 323] [Observation Room] Bed table, chairs, filing cabinet, gutted corpse on table;
see giant man in fan corner of that chamber.

x corpse (street 3) take sheet {corpse hills to floor}
read it {To} Raymond Piers, Asst Dr, April 16, 1978 is upset & Corvra really out of sync; lead researched frankly,
but corp author seems everywhere the Secret Service agent; security

x filing cabinet (strong liquid leaks) x liquid (-)
x giant man (on chair, dressed only in navy sweatpants, tangled brown hair, he's feeling wretched, not empty enough,
has wavy y seeds.)
open cabinet (smell of stomach acid, sting; bottom & top drawers both.)
x stone (congealed, not ceramic) // N of Side Hall (no key to 324)
N of Hallway ⇒ no shadows his teeth. // take stone (hate idea of having it under fingernails)

// x post (of friend) - unknown paper. read it (Alina's Day 4/30/78 - He screams at night; Jim says he's had these nightmares
forever, but last few days are different. He screams says they. Eyes open but doesn't see no.
When asleep, he says "Teeth Darker. Coming to me")

"mint" → "concentrate" out concentrate on white (need meet. just see net, & you can calm down...)
Take corpse from Obs Room put corpse in chute ⇒ (y/n sure?) (teeth in chute vanish + paper goes to
enter chute → [laundry] (in kind slacks, wipers, dices, sink E, faucet missing both handles,
very large markings, open door S, hyperactive)

read it (Uniff log Apr 2, 8:00pm, Day One in Corvra! Team incl Dr Atwater (asst overused) & Miss Elaine Berkman
- Theo Yehuda) x sink (mud paper) - (for Raymond Piers, May 18
- struggle from McMonagle's room. Nurse Kim reports disrupts sleep & worse nightmares,
Yehuda may want a few meds in near future)

open machine (fleshy tube & cilium sphincter at bottom, skeleton in lab coat)
x coat (keypad) S → [Basement Hall] boiler room S, swollen corpse blocks elevator doors
E → [Basement Hall] "Autopsy Room/morgue" (10 digit keypad), door is dented forward you. (strains)
(stains unusable)

x autopsy door (paper) - (Uniff log Apr 15 - ~~new number~~ of team, "Simon Cross, Company Spide" - Theo)
x keypad (0-9, plus 2 unlit lights) maybe N, stain E

/ S of Hall → [Boiler Room] pipes, boiler, metal box & glass surface & axe.
x pipes (view of shoe, cell phone, bit cut on wall behind boiler)
x boiler - (paper) - /4/20/78 - Jan tasty better; Zeneimbover 50%; it should be a wk before's withdrawal
to the Symbiont. I have full, bit... No one's seen w/d it. EGS)

take pipe - it grows, outer eye close, inner eye open, body collapses.

vision of Leon Shaureasy, neurologist of Corona, report in Naegleria fowleri
- he runs + slams Bielek door shut. Overweight extent for i wide blades in unboxing,
loud buzz, door E must be barred somehow.

One by
Open p3

i { hit with security botz, cell phone, Leon knows

take pipe (the loose pipe) - fan blades, now loose, starts turning, the buzz leaves a hum.
humming resonates? Leon slides the pipe behind part of red pipes, ready at a pipe head + door handle.

x security botz (Corona now has a steel-legged spider) {Leon is not me!}

- eventually he is ground up by the fan as if I went you consciousness free.

(this can still be changed.) wake. x fan (not there) [saw: "Leon dead, saw"]