

verbs & go, look, unroll, move, sit, at, wear, help, get &
 - find PENLOPE & get her out!

Palace
 Adventure
 by John OLSON

[Outside the Palace Complex] { sign, gate } open gate. N.
 [The Main Palace Ctyd] { stairs, N, S, E, W } N [steps up to the Palace] { guards E, ^{check} GUARDIAN, S, E, W }
 open entrance { N } N [A large Enter Hall] { key, look, N, S, W } key (post) water & alleyway
 look book (SO gets to the Outside, by willy, robot) N [A Royal Meeting Reception Hall] { party, contain, N, S, W }
 look party (horror) open curtain (toy snake) N [The Throne Room !!!] there, N, S, W
 sit there [The Throne itself] (button) push button. S → [In a labyrinth Below the Palace] there, N, W.
 [A large Reception Room & Bar] { pinball machine, umbrella, tv monitor (to fire chutes) } open umbrella → DEAD.
 (civitate)

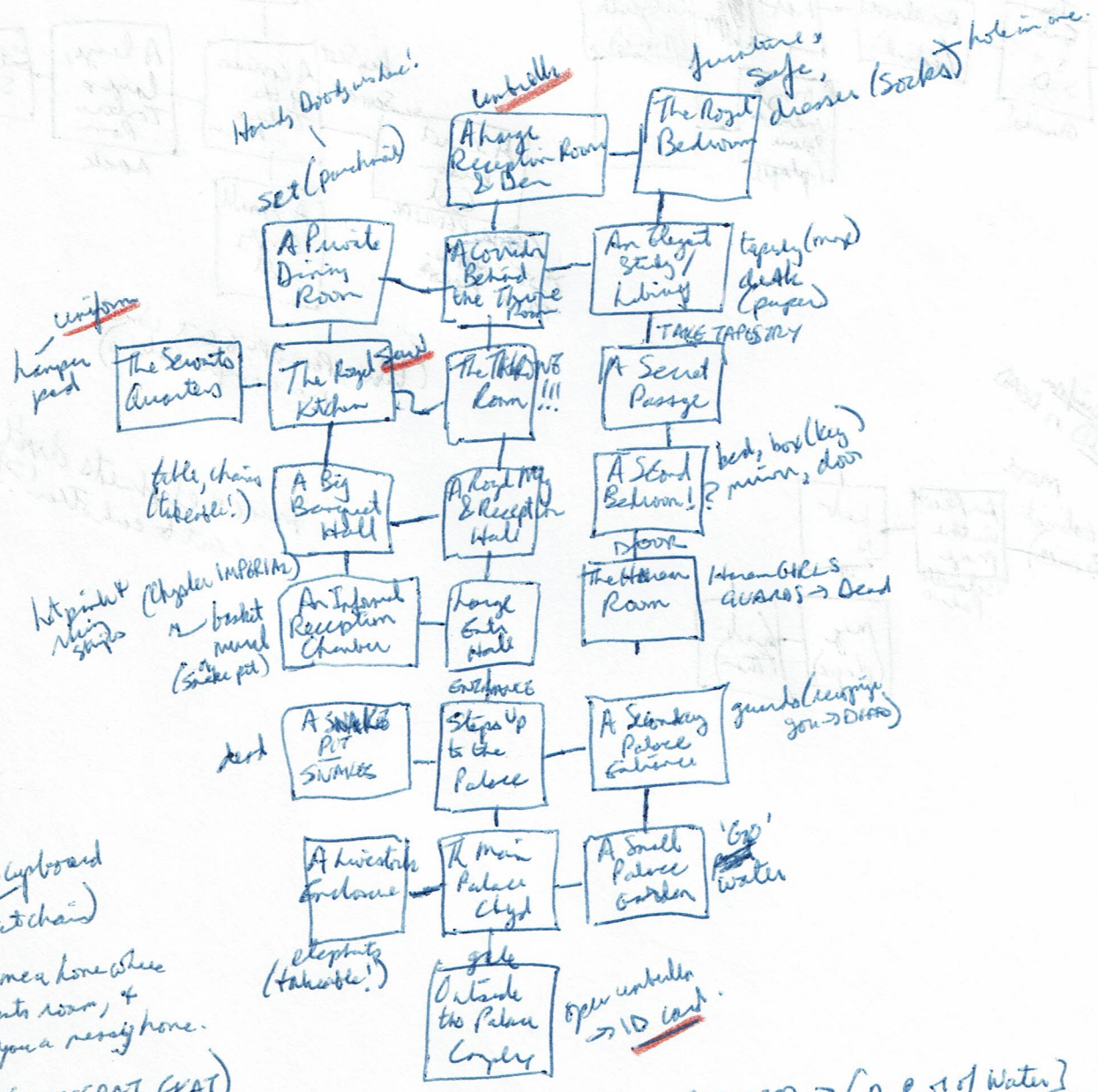

KITCHEN - counter, cupboard
 Saw (cut chain)
 part - Show me a home where
 the elephants roam, &
 Ill show you a messy home.

desk (YRTSGPAT KEAT)
 hole paper (Secret entrance behind
 a cabinet)
 2nd bed - bed, box, mirror, door
 (horror)
 WHY?
 key (INSERT before PULLING SCORSE)

GO WATER → [A Post of Water]
 eaten by alligators (DEAD)
 (ID & uniform aent enough vs guards)

INSERT KEY
PULL SCORCE (BOBES)

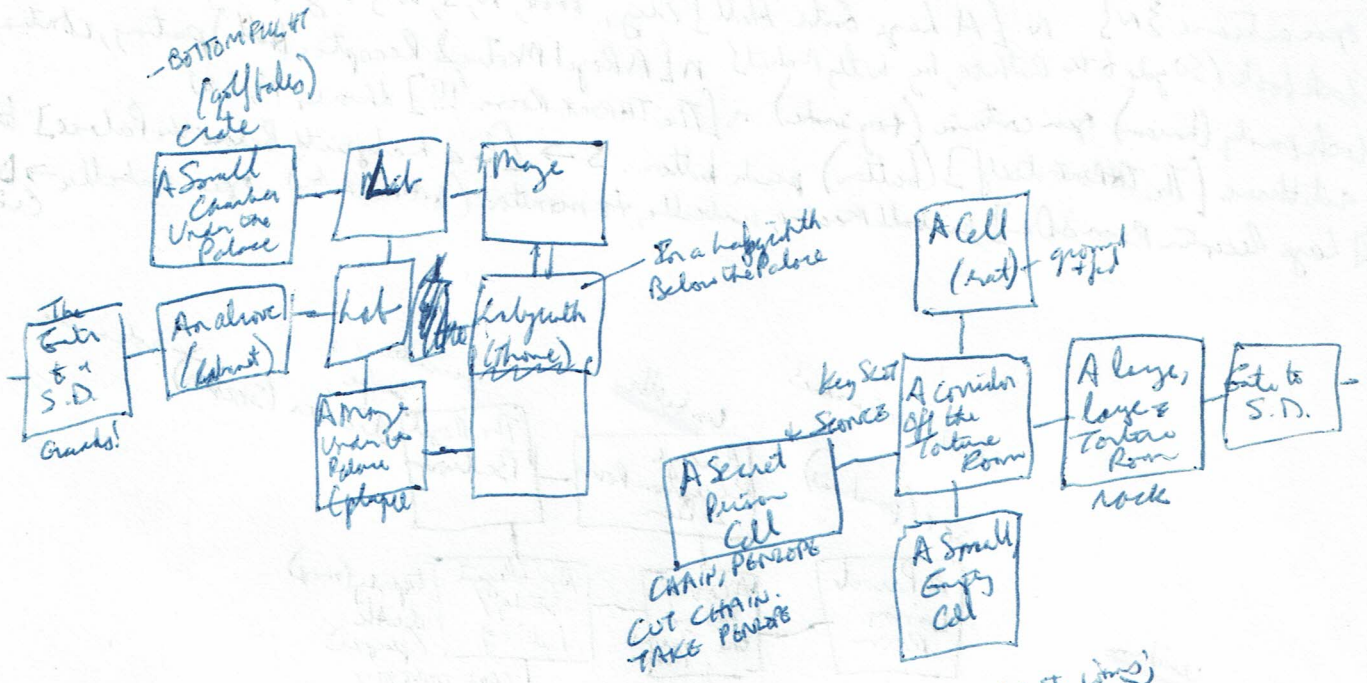

(taking PENSORS last time;
no complications)

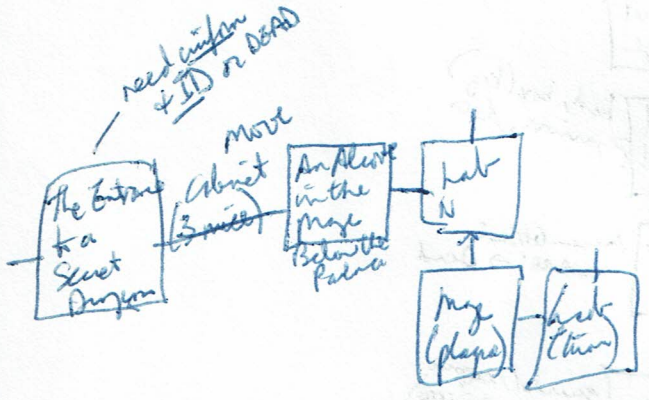

mice & elephants don't react to each other?!

Entrance [to A] = S.D. [to A]
[to A] [to A] [to A]
[to A] [to A] [to A]

[to A] [to A] [to A]