

PHANTOM;
 CAVERS OF
 THE KILLER

[Large field] w/ Semion (cty), rd N, forest E (fresh tracks).
 { } N [Entrance to town] (archway), rd N+S
 N [Town Square] street E, rd S, market N, hill W.
 E [Outside shack] porch, wall, broken windows, ~~fallen door~~
 in [Inside the shack] lantern (+13 pt) N [Market] stalls, rd N+S, stalls W+N
 take ring (+13) from ~~crack~~ Jewly stall. (can't wear it)

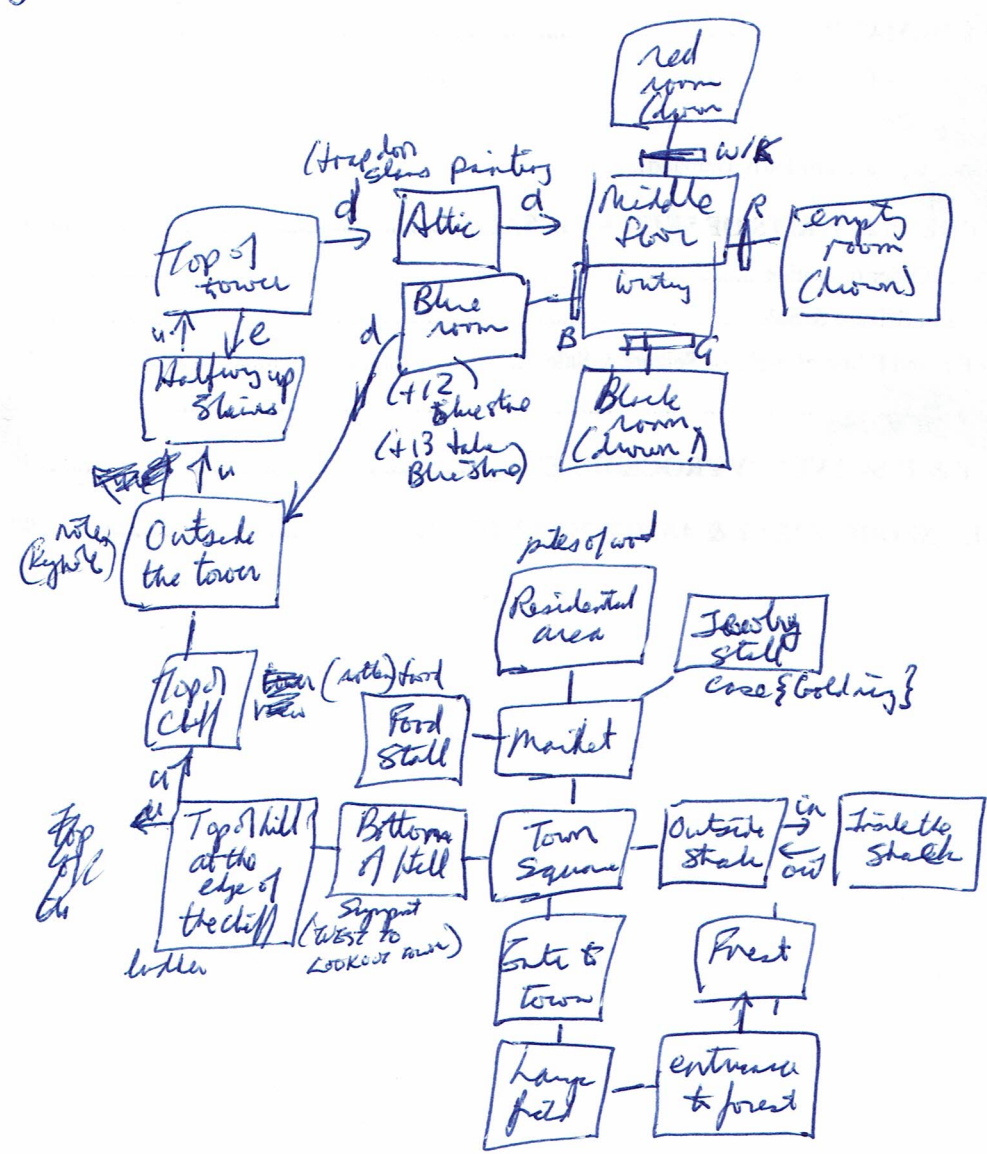

Underwriting the slow search by what they're doing & death leaves life.
 The earth allows, the fire extinguished. The hidden path lies in the mental energy of the path
 away from death.

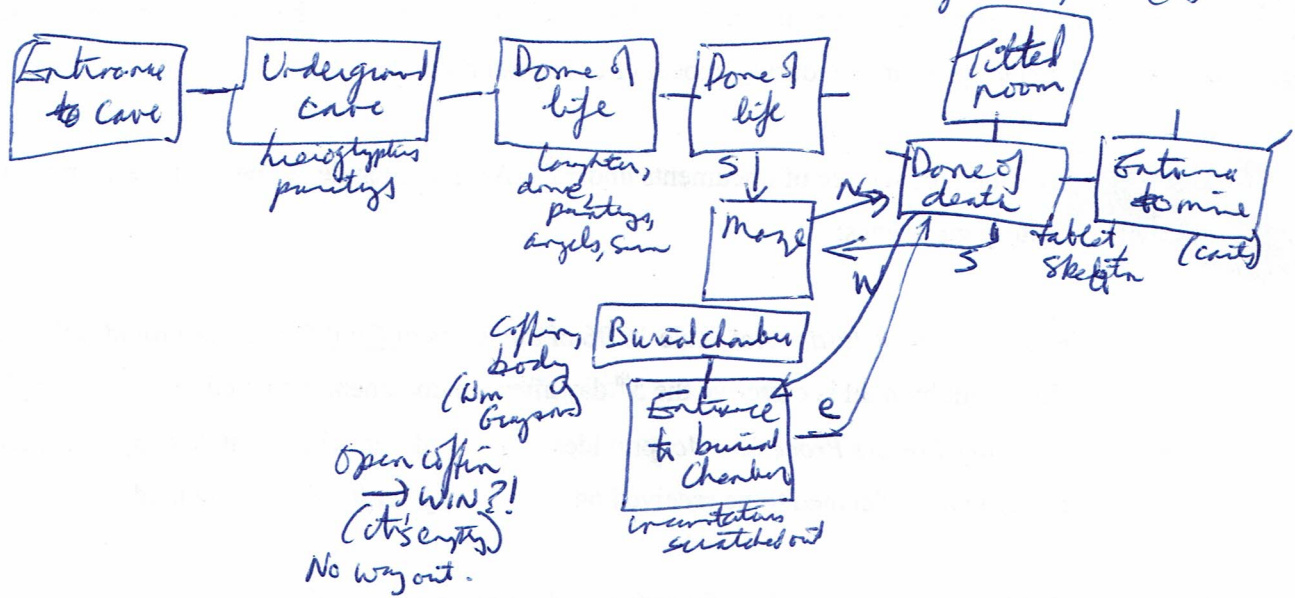
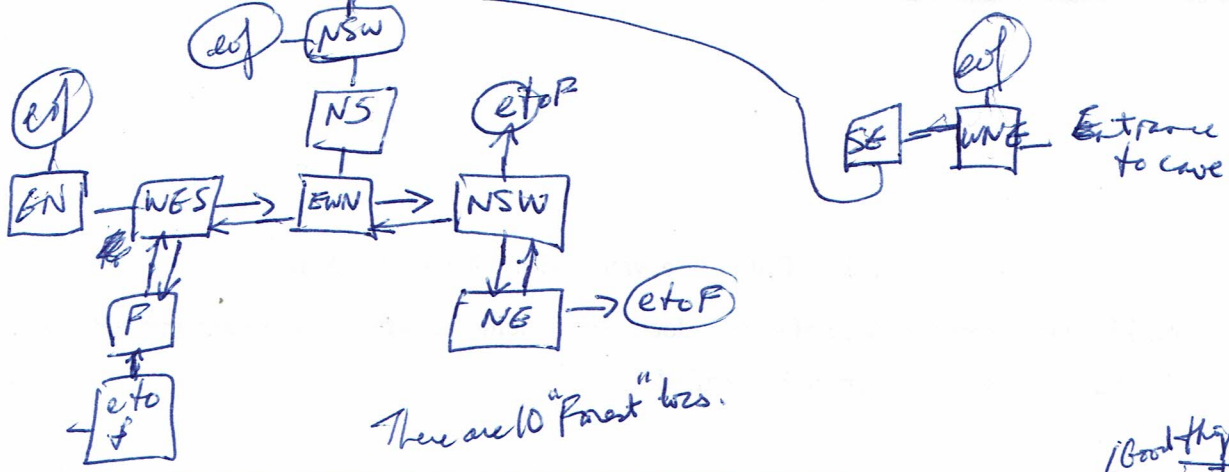

Pray at Tilted room → large emerald appears (take it: 13 pts)

