

(alt dream) (tonight's job: overnight sleep study)

[Waiting Rm] (on couch) table, magazines, loan N, desk w receptionist, exit S.

{ talk to NPC; topics; help; credits } x me (male, 19, Philadelphia student, broke)
i { jeans, bk shirt, bk sketches } x magazines. x receptionist (recept answers phone, don't buy us,
she tells y to go in) N → [Corridor] bath W, lab E ⇒ [Sleep lab] Dr. Lynch z clipboard,
dressing rm N, ? door E, window (obs. rm) E, an hour x doctor (beard, pocket protector, lab coat, smile)

talk to doctor { topics: Dr Lynch, MRI device, clipboard, sleep study }
ask doctor abt study. ask doctor abt doctor. (y = Benji Evans, volunteer or test subject)
ask doctor abt study. (study for new medication) ask doctor abt medication ("sueño"; it means "dream")

; study to focus on side effects) ask d abt side effects (D asks 'lucid dream?') no.
(if ready, get changed in dressing room.) ask D abt clipboard (study goes long; he takes it more)
ask doctor abt medicine (like an MRI; it measures + isn't invasive) N [Dressing Rm] toilet, sink, mirror,
hospital gown. close door. remove shirt. put shirt on peg. remove shoes. drop shoes.

remove jeans. put jeans on peg. (x mirror or look in mirror = no reaction to mention of nudity)
wear gown. i (still with socks + boxes on) remove shirt (not 'boxes') - writ.
(move socks (no - too cold) S. [Sleep lab] D gives cup + pill. ("It's chewable")
x pill (7178, peach-colored) eat it. get on bed. { give cup back w/d } g. (D turns off light + goes E.)

x wires. x medicine. (donut-shaped; has indicators + buttons). x indicators. (y sleep)
[Someone's Bedroom] (on cot) glow, posters, aquarium, TV, exit N.
x bed (A voice from brain - "Don't leave a trace!") x aquarium (brain in tank - Take care!)

i { chess + gown } stand. talk to brain. { T: brain, Dr Lynch, sueño }
ask b abt doctor. ask b abt sueño. turn on tv. (shows y in post office sitting a care package?)
x tv (machul non enter; tv goes to static) N. [Completed Junction] door E (hears shower),
CARPETED

window N, more S6. look through window (pine trees + light drizzle).
S6. [Cozy Study] chair, fireplace, bookshelf, bay window, NW + S.
x fireplace (small metal door in back) gen small metal door (kitch)

S [Dining Room] boxes. window. N.W. N → [Kitchen] cupboards, counter, dining porch NW.
open drawers (+ box after) cut boxes. (find a floppy disc "Read Me")

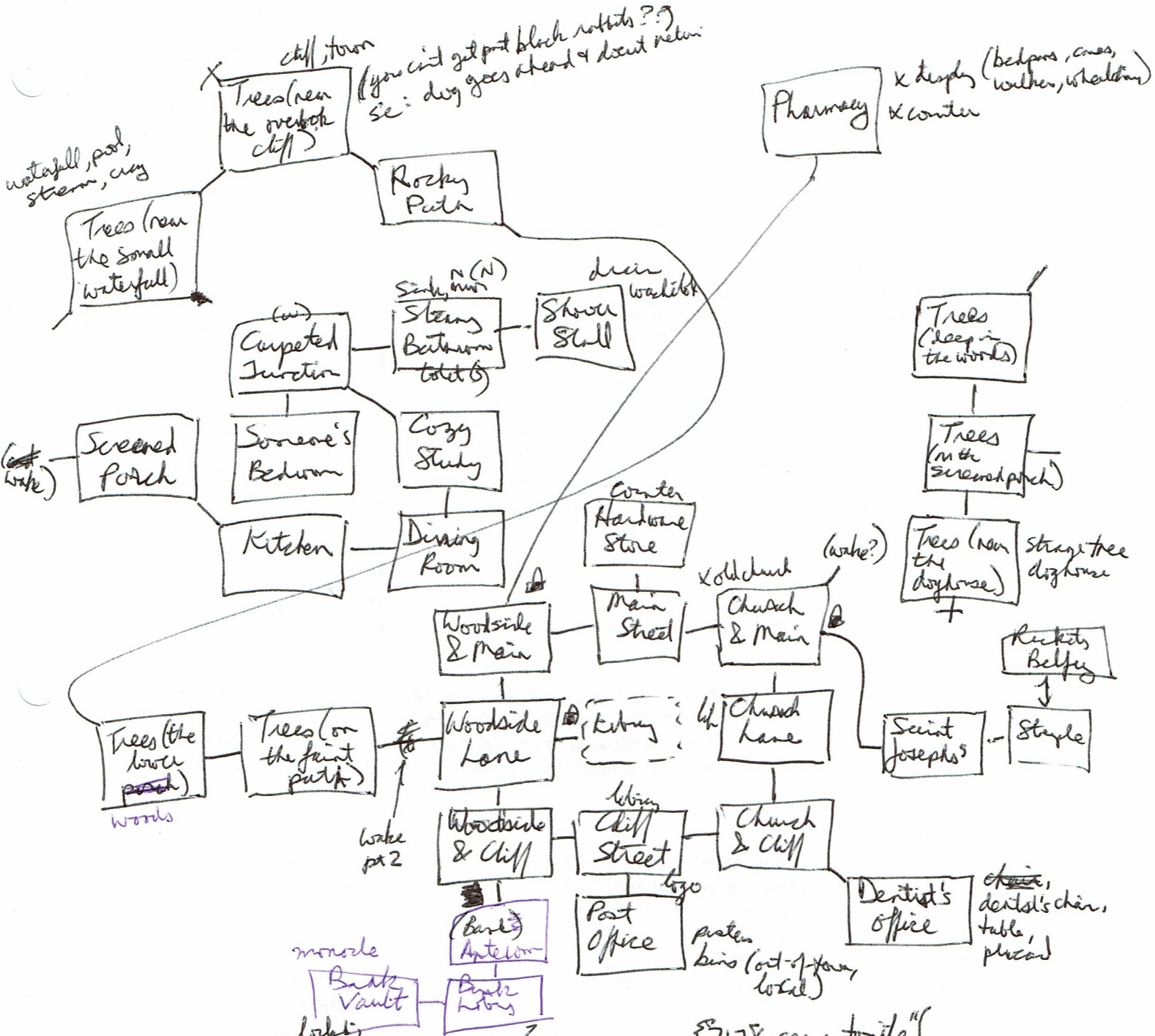

Open shower door {Man: J'll be out in a min} x minor: {7178, see a tonyle"}
 ask brain abt most toilet {b: flush the toilet} ask b abt disc: {b: computer in town library}
 take brain. @ Cozy Study: clean door with washcloth: {found dish, first to fourth, Q, 19}
 set first to 7. set second to 1. set third to 7. set fourth to 8. {safe open}
 'work in safe - take napkin. x it. {remember - you are DREAMING}. dream (what to dream?)
 dream more {y don't have enough power to do it yet} ask b abt napkin {The house is yours.}
 // look in doghouse (collar) x collar. water it. remove it. @ doghouse: DREAM DOG (+ dog, collar)

w. NW [Screened Porch] needles, chair, doors W+SE, backpack. ~~open~~ open, take backpack.
 @ Post Office: x posters. x wanted poster (pic of Dr. Richard Lynch, labelled
 "Dr. Wallace Josephs - Physician to The Philadelphia Mob") ask b abt wanted poster
 look in out-of-town (care package) take package. unwrap it. open it. look in it (old key)
 // unlock church door with old key. e [Saint Joseph's] x windows. x saints. x pews.
 x ceiling. x altar. x sign ('Saint Josephs the Innocent') e → [Steeple] u.s.w.
 u → [Rickety Belfry] bell, baseball bat. take bat. Hit bell with bat {library door slams - open?}
 / @ Church & Main = Wallace Josephs arrival. x josephs {batcheis gun, cleaver, syringe}
 if wif hits y with cleaver: ~~xxx~~ Y awake in a pinched sweat but Dr Lynch assumes y everything is fine.
 You are paid for volunteering in the sleep study & y go y merry way. Too bad y didn't unlock the mysteries
 that The Sueño had to offer. ~~xxx~~ // 'door to apothecary door looks smokable' according to brain.
 // [library lobby] desk. ^{new} comp. (fun on computer) // [Computer lab] turn on computer (not smiling y ca smiled)
 x computer (disk drive, keyboard, monitor) // @ W & M: hit door with bat.
 put disc in drive {hookup Wallace Josephs in the Reference section
 Then set your biological clock to wake up."}

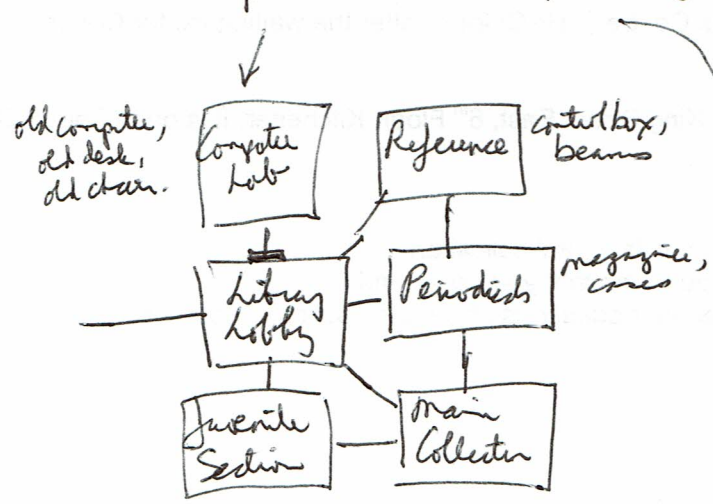

dream fogged-up mirror
 ⇒ teleported to Steady Kathleen!
 ask brain abt Wallace Josephs
 (Gowers Trees (near the final path))
 other telepit item = bell,
 dentist's chair, hoghouse, altar,
 waterfall, cot, message, drain
 atm, new computer, fern

sit in chair. (if you will, the probe enters your eye!) dream probe. (it vanishes, & y see a
 dentist's mouth mirror. take mirror // block beam with mirror. (✓)
 look up wallace josephs in books {print is too small!} dream glasses (no) dream magazine fern (no)
 // look dust @ Hardware Store: "my name is richard Lynch"
 work behind counter: y find a hammer! hit wallace with hammer. (he's stunned & lew!)
 he's at St Josephs? (attacks usually miss) ask brain abt hoty message (maybe not in your dream
 anymore)



@ Pharmacy: work behind counter (prescription pad + pencil)
x pad. x pencil. not pad with pencil ("Richard Lynch is someone else. You're no longer in your own head. Despair and be forgotten.") {Time has passed}

// s from W+C → [Bank Anteroom] interior door S, ATM (west), card-reading device S;
dead body. (free in zone) search body (+ credit card) x card ("Dr. Richard Lynch")
x atm (insert card, then type a PIN) ask brain abt body: ask brain abt pad.
ask brain abt dentist's chair. ask b abt laser beams. ask b abt bell (y aw the something)

// put card in atm. type 7178 in atm. (✓ + twenty-dollar bill)
put card in device. S [Bank lobby] ghosts, teller's window, kiosk, guard.
x guard. w (looked) x teller's window. x teller. give bill to guard (he opens the vault!)

w. [Bank Vault] body of child, monorole, boxes. x monorole.
ask b abt boy (Lynch as a boy) x ghosts (dead from robbery) wear monorole. look through it.
w/over backpack. dream receptionist (w's desk, w's computer, w's phone, w's chair, Fran Anderson or
cruiser reception desk?) // @ Reference: look up Wallace Joseph in books (while wearing
monorole): ~~Walter~~ He is schizophrenic, was a sleep lab, evidence at 30th Street Train Station,

'other 7178. // hit Wallace with bat (2nd hit, he disappears)
dream suenos (cut) dream Wallace (this brings him back)
hit Wallace with cutter (!) {he drops his apron} x apron. look in apron. (biological clock)
x clock. time (half past eleven) dream clock (y don't know what it represents)
set clock to wake (?!?) (Pomtuns later, y rule) ~~the~~ Thus ends The Sueño ~~the~~