

TIME: ALL THINGS
 COME TO AN END
 tatatae.28

Guatar Ernst III

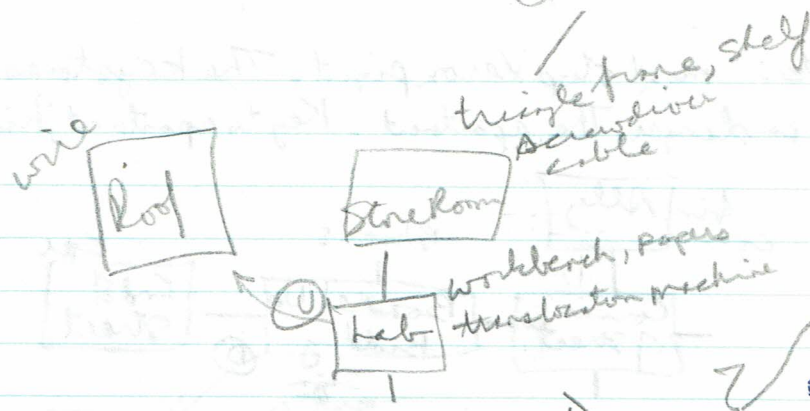

notebook subjects

- project
- power/source/panel
- exit/entry/gateway
- void
- translation/machine

- 14th June 1992 (project started)
- 4th Feb 1997 (no results up to this date)

- details of machine in notebook, panel, red button platform at base (screwdriver) (calculator)
- search papers to find notebook (consult notebook about <subject>)
- on panel "PowerSource" - way of storing charge at a quick rate machine - a time machine
- open panel & screwdriver, take source, connect cable to source
- Go roof, drop source, connect cable to wiring, lightning strikes source
- put source in panel, push button, step in hole (white dot becomes triangular in shape)

Chptr 1: The Xerox Project / Garbage Bin

look thru hole (see ally; man in fear)

a man named Carpenter few months use of Xerox Project

- killed by man in leather wears helmet, small tassel in bin (gun)
- newspaper July 20/2065 New horder Telegraph
- corpse's jacket has triangular badge



EXAMPT JJA: 2017
 (Date not of 2017)
 20. 10. 2017

1 in pockets: must stop Xeron piglet. The keystones.
 Time in danger. The apartment. Key to apartment, hidden down

maple notebook
 laptop
 laptop/usb drive
 promotion / notes / etc
 his
 e-mail

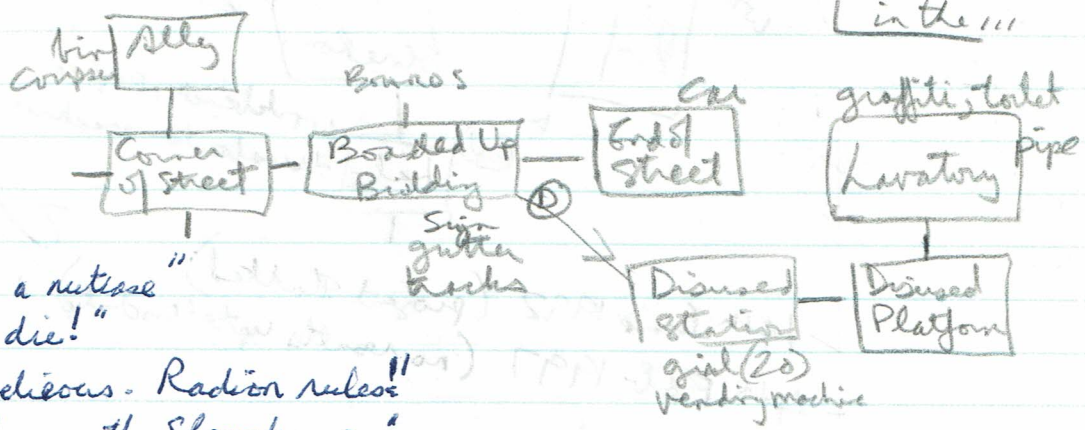

"Adam Jones is a nutcase"
 "Corpses must die!"
 "Death to Unbelievers. Radiation rules!"
 "Egypt '32. Praise the Slovaksarin"
 "Xeron Megacorp: The beginning of the end"

boards "Handels. Closed by order of Schmidt Electric Corp, 2034."

sign "BAK... S... ET"
 X gutter - steel button, with 'S' engraved on it.
 point gun at girl (2 pts)
 graffiti - "e knife" / "Adam Jones is a nutcase" | opened lid (of toilet) & take plastic bag.

bag { paper, ID card, metallic disc }
 Paper - signed K.D. Carpenter, if don't make meeting.
 All important stuff is in apartment.
 ID - address: Gerard's Heath Estate / Taron Institute

push machine - wire - wad of chewing gum
 car: knock on door, open door, in, close door.

"Driver, drive to [dest]" - 23 creds
 chew gum
 - give disc to driver → Housing Estate
 girl, drop knife (turn handle to make it work)
 take pipe, bend pipe, tie rope to pipe

TIME - "all this connection end"

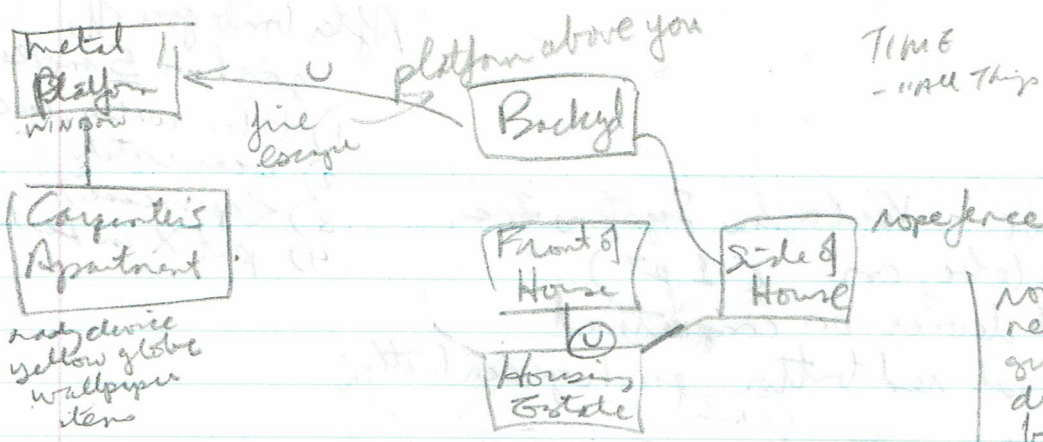

radio device
yellow glove
wallpaper
item

- rope X
- newspaper
- gun
- disc
- bag
- button
- ID
- piece
- knife
- gun
- me

- card in slot - mechanism is disabled
- cut fence? no suitable tool - with knife
cut fence AGAIN for rope
- device [green button, red button, ^{red} indicator light]
- push red button to turn it off
- closing duty window cuts off light
- holding gun causes police to fire on you; same is knife
- trying to leave also gets you shot
- tharg'd of ~~work~~ at Police Cell (combat) is taking
- taken to Interview Room (in chapter)
 - metal table, white circle on ceiling
 - cut wallpaper is knife, inside is compartment (cant open it) is knife
 - maybe you have to lose the ID card?
 - drop all before found
 - glass of liquid, arm is free
 - untie rope (2 pts)
 - you keep stat button
 - ~~you~~
- tell woman about carpenter/time
- put gun on wallpaper
- put ~~gun~~ wallpaper on small window
- you can cut the wallpaper with the dull knife

- (newspaper gone)
- gun gone
- disc gone
- bag (red paper) gone
- you can take wallpaper (gone)

should
kill u

Side of table (after seeing all screens on device)

- man (wearing 45 yrs), gives note (in your handwriting)
- iron sphere falls. ("Some things never change")

note: "I hope you get this my friend, as things will be in rather a mess. This sphere will explain everything. That's one of the great mysteries of time, the unmade coming into existence to remedy a paradox. There's something important I have to do, necessary else the divide will be sealed. Good luck, companion."

ion: you in lab-coat & Digicryptic.

"The keystone you seek is the cause of this nightmare. It must be recovered so time can resume its natural journey.

Information must be earned & not given. You must learn important things about the Earthian experiment. Goodbye, my friend."

push white button (at statue) - statue & medallion vanish

- Inside Statue (another time machine!

- glowing column, medallion here, long plastic rod

- turn rod - glows slightly (with handle)

+ dull ringing sound inside

- show medallion to man. Take badge

- soak cake in whisky (it takes it all)

- touch w wall of statue

box with yellow label

wire cutters

- InvisiShield Mk IV (Thin lens)
- scribble C_2H_5OH as a warning

- sit on chair in cafe, bearded man sez - we've been waiting for u, Python.
(Come to the usual place, later. (man spins room))

- newspaper is now under table (note in paper)

read note: Meeting in usual place. Make sure not followed.

Usual Identification Rules. Extreme care needed because of recent actions & increases in security. The word is about.

Take necessary precautions. There may be a leak.

[put note in ashtray. burn it. (with lighter)]

- papers will condemn you

- knock on door. say about

- Start to plan comp.
- The train will bear easy target. Briefing is in place.
- planned for months. Relying on you & expect no failures.
- that will be all.

- give papers to man (in hat) - new photo id.

- Cabinet open drawers
100s of files

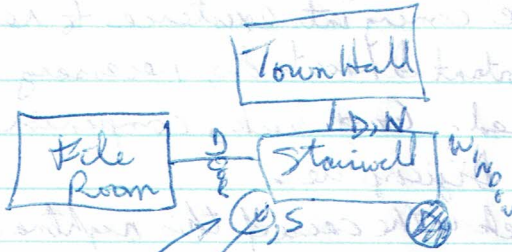

"Fran Director
Monika
Schmeist"

Point rod at keypad.
Turn rod.
Pull pad
out wire.

Door to file room is locked
UNLOCK it with pin
CONSULT FILES ABOUT BARTHAN
- device thought to work on principle of brainwave patterns. Tested at Schloss Winkham, Austria (3631)

pour whiskey on mouse
- cabinet appears!
- inside:
- weird adaptor thingy
- sinister black box

black box - red button
- funnel on side
adaptor - triangular plug with cable (?)

- throw open satchel at woman when she lifts veil
- run to Xerox with thingy & box
- ~~put plug~~ attach thingy to keypad. Type 3631.
put plug in hole. ⇒ Overload!

(Chptr 4: All In The Mind)
Featureless Corridor

Chpt 4

carrying nothing

swastika

Living Hell

Featureless
Corridor
people of all
ages

Brand In
Corridor

Infinite
Corridor
old man (pale)
walks north
then man in lambskin
wearing a gold clock
clock in Δ circle

degrees
Courtney

Courtyard
Guard Post

in car, laps on
Driveway
car
chauffeur

Edges
Forest

Dark
Forest
(dark)

Top of
Tree

(branch left, z,
z, z)

Xeron
Clearing
(day)
trees, vegetation

- point gun at chauffeur
- hit chauffeur

throw cake (soaked in whisky)
- dog becomes ill

car - 2 fly, headlights, door, window
under air - pipes, but it's too dark
- break window
- open door
inside - black pen
- turn on lamps

show key to chauffeur, he points to iron key

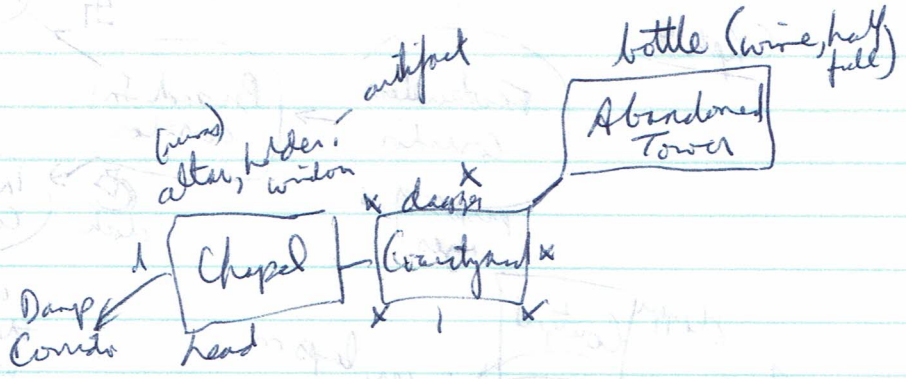

look under head-hole (small & thin)
 put dagger in hole (click)
 turn artifact - secret doorway in floor opens

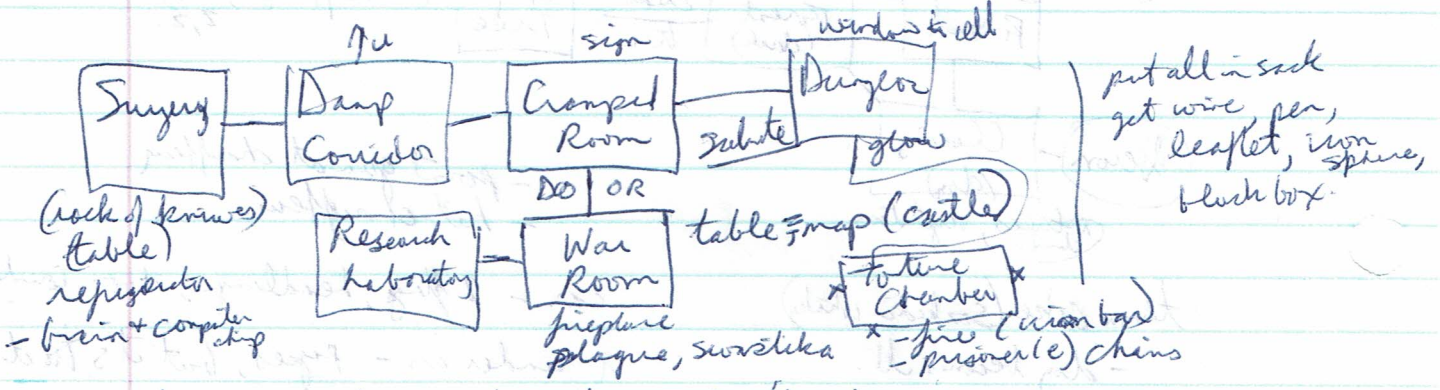

open fridge, 1 under fridge - tiny red capsule/tablet
 (head notel door closing), salute (in Crawped Room)
 turn castle, 1 under table [control box]
 control box is blocked, turn swastika (90 degrees at a time)
 pull it just

prisoner "They take minds, devour them, reduce them to bits & pieces"
 "They come, the demons come. They have eyes of doom. Red eyes. The demons."
 "It's too late. No time. None at all. They stole it, ate it away."

put wire in cell, rusty key given to you. take it
 write note on leaflet. - give leaflet to man
 - give iron sphere to man
 - push red button (prisoner escapes thru void)
 open box with rusty key: control box [black button, grey button]
 - black button has above it & is loose
 - door closes/opens | - point rod at black button, turn it
 - grey button sets off an alarm

put device on safe

2069
1997

- left hand - R
- right hand - Y very brightly
- 4000 - glow bright
- 5000 - dim
- 6000 - glow dim
- 9000 - very bright

5000 dim Y = 5200 - very dim dark Y
 5500 - dim O = 5300 - very dim orange
 6000 - mod glow Y

5200 { 5225 - Y dim — 5238 Y dark
 5250 - O practical dark
 5300

5241 - safe opens & killed by guess who? (green/dark)

L.M. misc 26 (first taking, not holding)

Safe { tetrahedral ruby (large + powerful) ≡ keystone
 beige folder ("Xerox project")
 metal pyramid (light on base (dark), square white button)

folder - diagram of cylindrical machine, equations + symbols.
 - interior { closet in west wall, maintenance hatch.

Pyramid is "Access Key"
 - note dated 10/3/64 refers to your machine in 1997.

point rod at head, push cap. take ruby.

Search woman (mask + glove (with pads))
 needles (gloath glove) - don't wear glove

put glove on scanner
 put photo on scanner

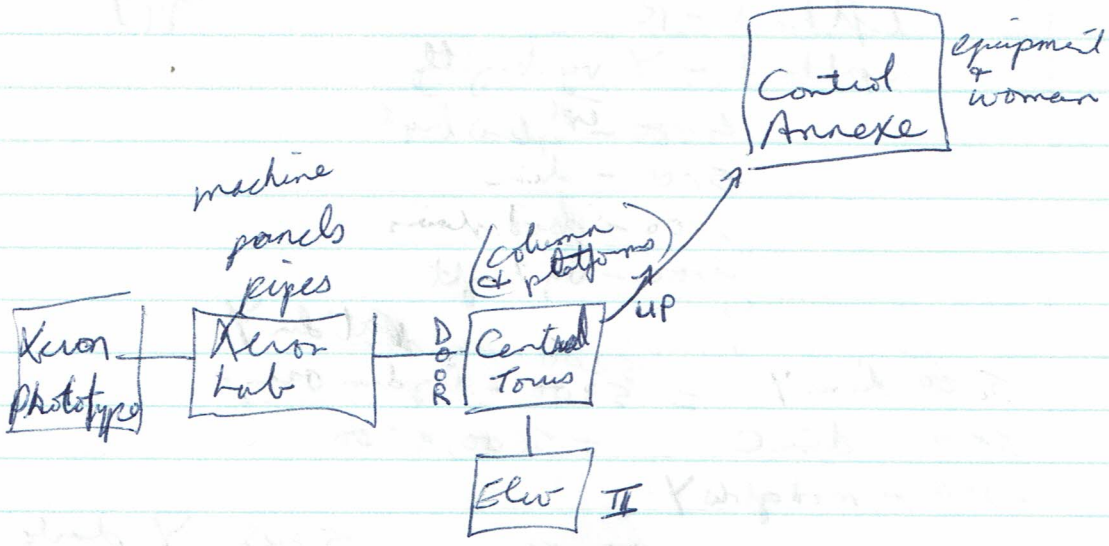

door - round & metal, scanner & circular pad

touch pad - scanned by laser beams

machine - access gate (push white button)

- some items can't go with you (?)

drop (glove, ~~photo~~, rod, device, folder)
~~(folder)~~

Prototype - panel, hatch of controls

Can carry photo, ruby, tray, pyramid, rucksack, bottles, spheres, lighter, button, pendant, watch

triangle hole
globe
readout "2065"

"Emergency hatch opens only in emergency situations"

put ruby in hole ⇒ CHAPTER 2: THE SANDS OF TIME
(desert SE of Cairo)
date: 1924

Sarcophagus: "The end of one lifetime is but a transition to the next"

- skeleton & gold sceptre
- sceptre heads: "All praise the beholder, Karimal."

Karimal (as magic word) when holding sceptre + sword \leftrightarrow topaz
 new plaque: The keystones must not fall into the hands of the demonic ones
 from which they be protected since the coming together of time.

- Put topaz in hole: "Insufficient power. Fuel rod must be recharged before transit
 - overhated (rod, orange) can be enabled."
 - enter office, pull lever to Communication Room

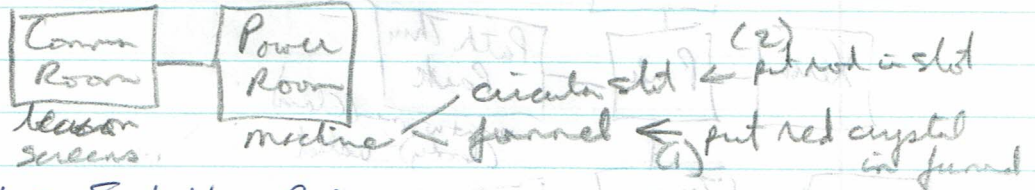

topaz \rightarrow Chptr 3: Forty Year Reign
 where: town in N. England
 when: 1985

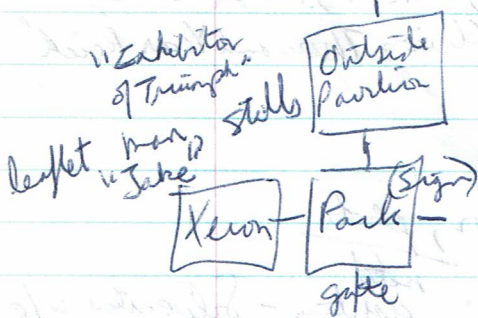

leaflet: Celebration of victory of '45, guest speaker: Karl Stoller
 Thresher Pk, 14th March 1985.

trinkets include: gold badge ("NRK" in silver, pin)

- ③ Luftwaffe (aircraft)
- ② Servants making gun. (west coast of France)
- ① (Churchill surrendering)

- ④ V2 rocket (green) in Silo used London 1944
- ⑤ lab in Austria, machine & diamond keystone

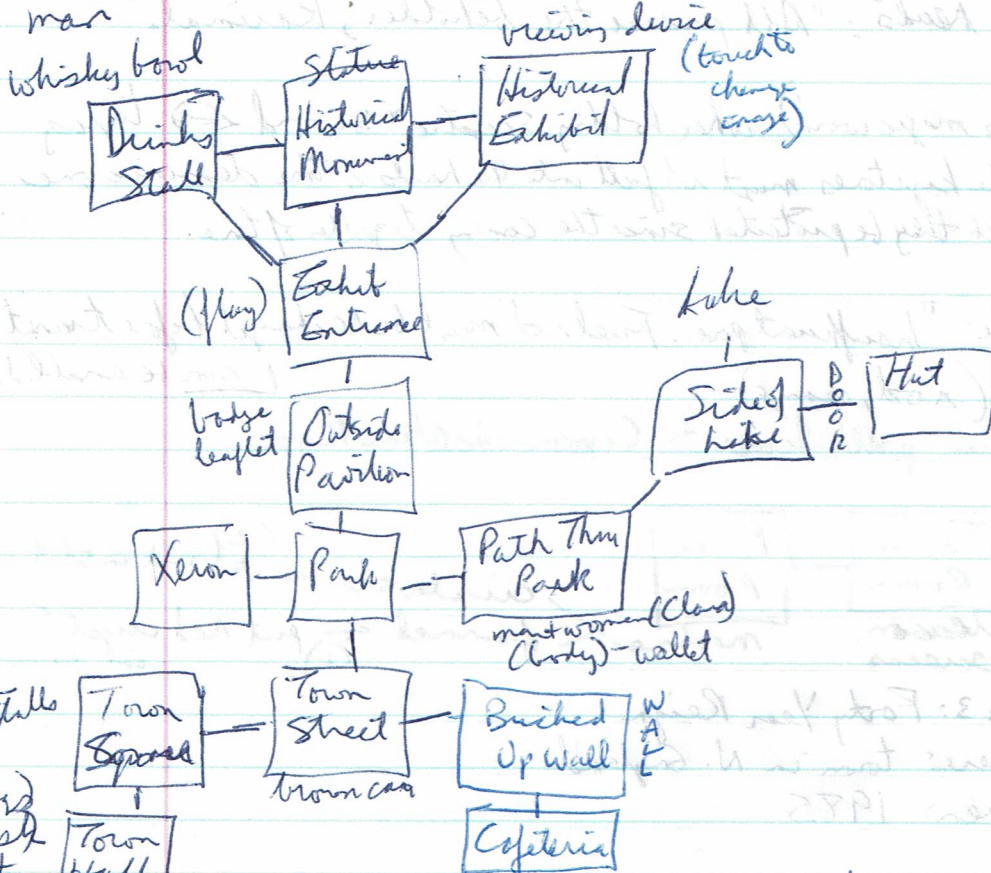

Show papers to whisky man & he flees.
 bottle appears empty, even with whisky in it.
 Jake doesn't drink.
 - look under stall (had something buddy?)

statue has octagonal silver medallion, of soldier, cam out, metal (helmet) rifle & (grenade), base: "Long live The glorious Thousand Year Reich"
 rifle is looser. - take rifle (no ammo)
 medallion out of reach

wallet { papers - Herr Klein, British Citizens Inspector, photo credit card "gold"

Cafeteria - (people), (counter) cakes, display (cans) table [ashtray, sacket] & chair
 grill in overalls

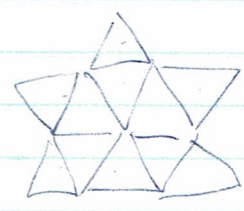

metal ashtray - Silverstone safe
 Sacket - pepper ✓
 cake - by cake with card ✓

JK

feel search

opening the case

- | | | | | | | | |
|---|------------------------------|---|---------------|---------------------|---|---------------|---------------|
| X | kick it, break it - throw it | X | unlock case i | pendant | X | unlock case i | watch |
| X | " | X | " | steel button | X | " | dirt window |
| X | " | X | " | newspaper | X | " | wallpaper |
| X | " | X | " | id card | X | " | door |
| X | " | X | " | note | X | " | globe |
| X | " | X | " | disc | X | " | me |
| X | " | X | " | item | X | " | gun |
| X | " | X | " | bag | X | " | knife (dull) |
| | | | | compartments closed | | | knife (sharp) |

- X turn lock, move it, push it, read case
- the wallpaper feels rough to the touch

- X top button
- X center button
- X bottom button
- X depth
- X eye

put things in compartment?

- X squeeze lock
- X rip lock - too hard just to break open.
- X swing lock - nothing sensible to swing here.
- X spin lock
- ? decode lock - You have nothing with which to perform any translations
- ? turn lock - nothing available to perform that action with.
- X kiss lock, hug lock
- X case, open - You can't talk to - strong briefcase
- X eat lock

Scuffles? Compass?

center/floor outside/inside

jam X with /

ask driver about London

driver, drive to town of London - closed in view of royal gun execution

Buckingham Palace - flattened by quake

Trinity Institute - place is restricted

Square - burned down in '34

Museum - flattened by quake, or so they say

Parliament - demolished by Volker Corp

Park - blew up

say Chelsea / say thief / say yes / say case

(Special Investigator Quinn) - pale blue eyes

knock bed / unscrew legs with steel button - g / push bed

kick gate / push bed / push bed / push top button / d - fuel

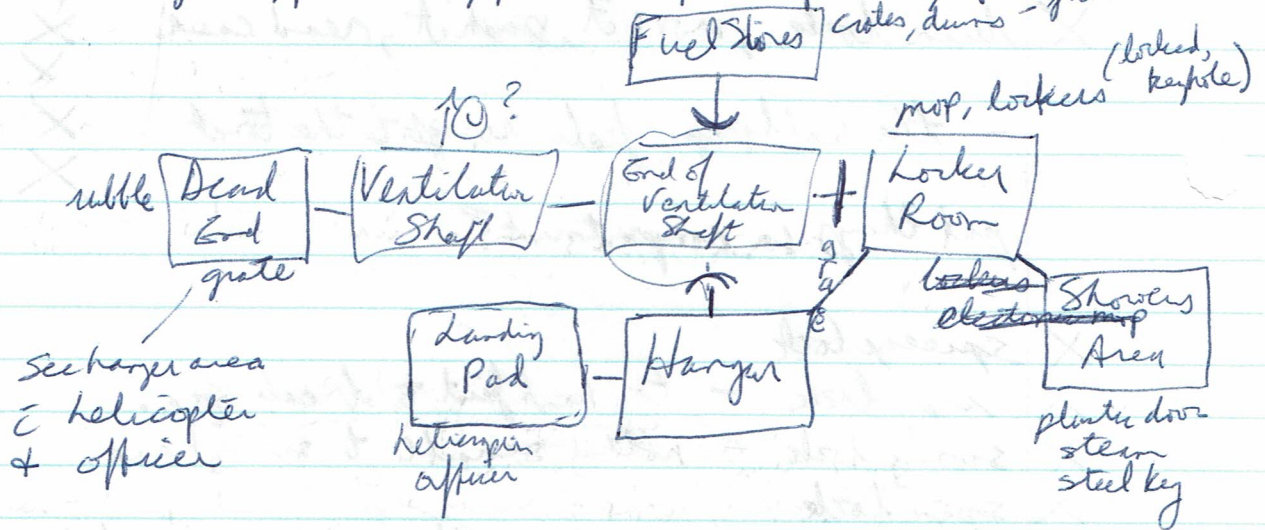

map - square of plastic on a pole
from plastic door with map

- put towel in fuel

Police Helicopter
helmet, controls
- screen + keypad

l under seat
→ marked

inside lockers:

"BENI - Holiday Resort

PYRA - Strange Egyptian structure

LOAN - City of Angels

flight uniform - blue, id badge, pocket & towel

l in pockets - austrian cigarette lighter.

"Happiness in a cigar"

read manual - engines, autopilot, eject
 push engines / type TRIO / push autopilot. / z / push eject
 (Field - brick bldg to NE, barn to S, shed to SE, seat

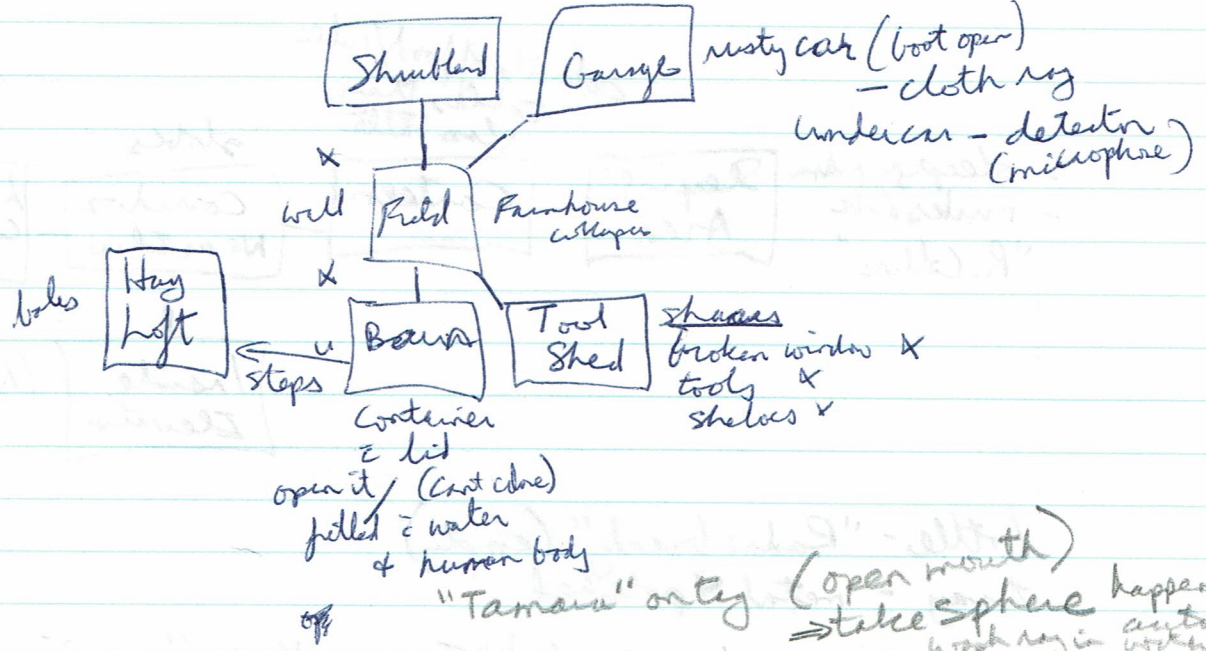

press sphere to view image of Tamara; somebody is intending to steal my identity to infiltrate the inst.
 Stop her. She intends to use the Keron Machine to open the keystones ... (she dies)
 cut plants (in Shrubland) [with shears] } u - throw away rag (muffles breathing?)
 - cover seat with branches
 - floor descends to Inst Gate } dry corpse to car - place it - put it in boot

SCANNERS IN OPERATION
 NO AUTHORIZED ITEMS
 NO flight inform
 NO helmet
 NO shears
 Scanner system

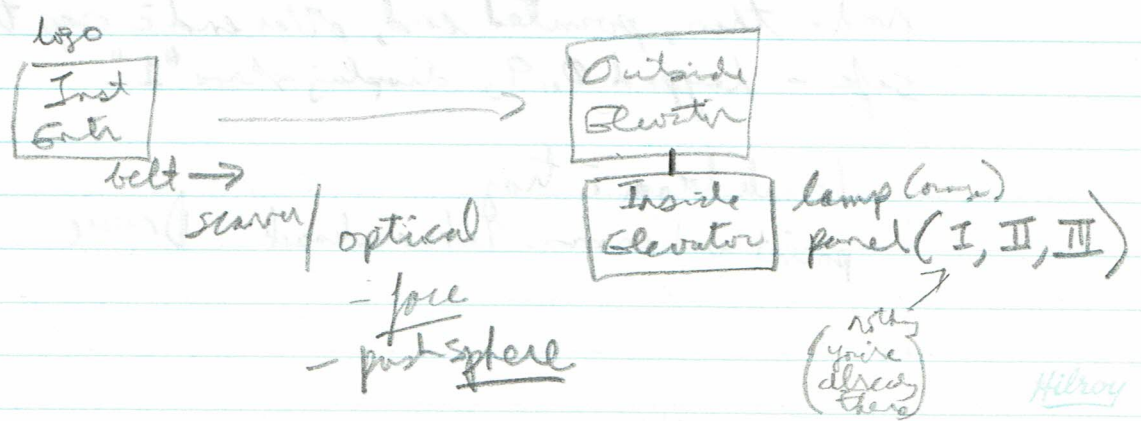

beige, telephone wires - brass head
type long / of telephone long / 315T eq / wire long
2000, 37' x 24", 2' x 24", 34' x 24" (level II)

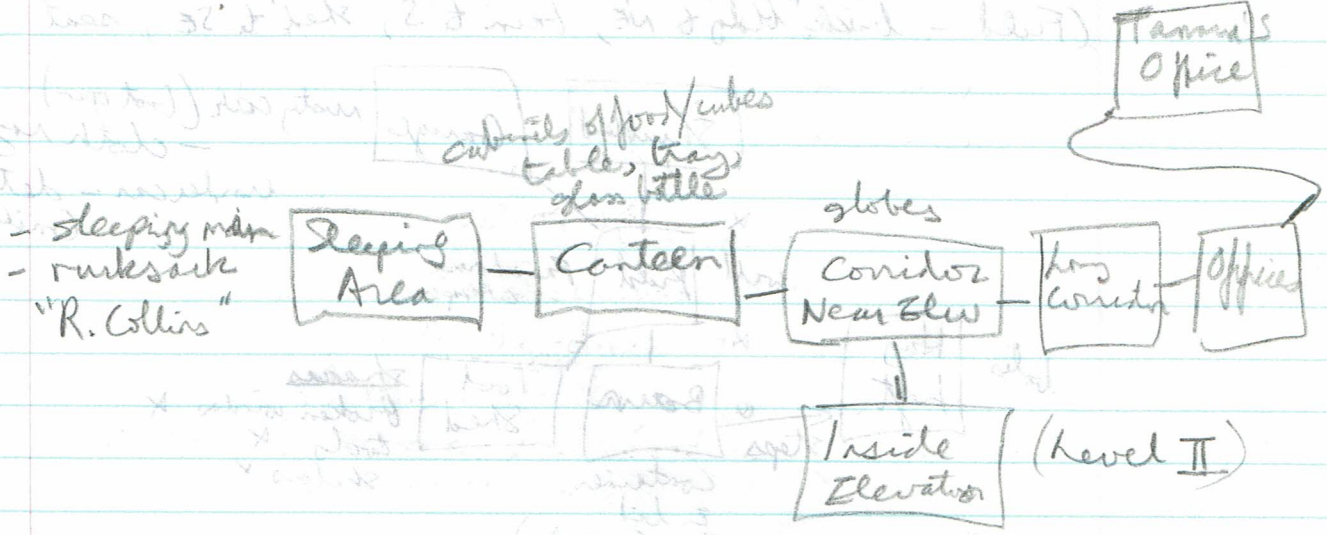

bottle - "Rada's brandy" (empty)
tray - metal & polished

Offices - NR door labeled "Tamara Krieg"

T's Off - items, safe, desk, photograph, briefcase (of Tamara) (papers) - base

pull base - revealing compartment (tiny sphere brass, thin rod)

news - Carpenter [meet i someone in New London. Someone is plan to use Xerox Machine to locate ancient keystones.

These stones are foundations of power. Institute has 1 of them. It will allow access to others & to city of the ancients where secret of time resides.

rod - thin, pointed end, other end i cap that can be pressed.

safe - keypad 0-9, display shows "1".

break beam i tray point rod across. Take mulesack. Device

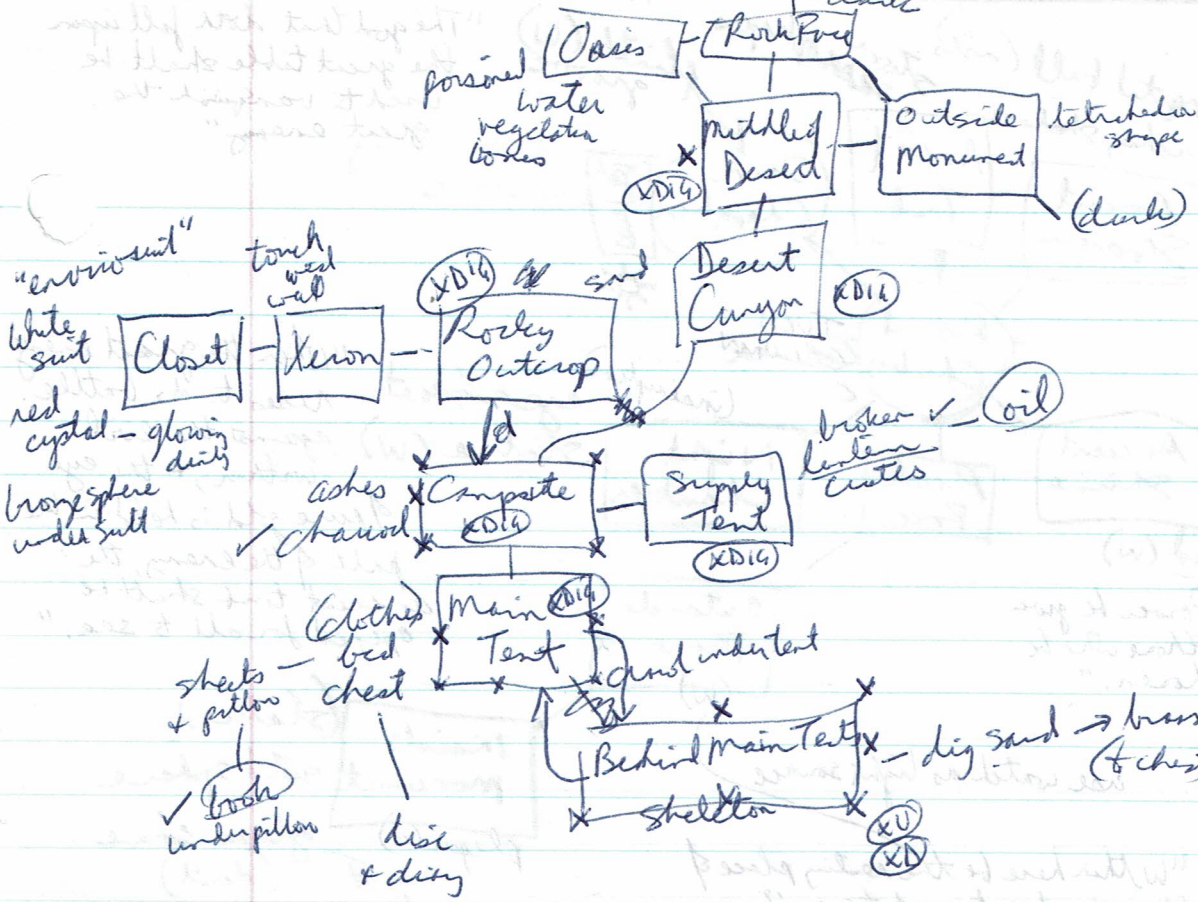

bronze sphere - ran on Keron device, contains standard & keystone variant navigational features.

Lock: "This is what I managed to discover abt. strange Egyptian script we found in shrine to north of camp. It is a language quite unlike any I have ever seen, & only adds more mystery to 'jid'" (dated 3rd April 1924 / Prof. H. Johnstone)

[Translate <whatever>] - for ancient script.

glass disc, 10cm diam. (lens) "Divider of that which provides us with our very existence"

- diary list: 1) Au 2) Ag 3) Unknown 4) Cu+Sn
5) Pt 6) Cu+Zn

- (1) gold 2) silver 3) ? 4) Brass 5) Platinum 6) Brass

"The god that doth fell upon the great table shall be used to vanquish the great enemy"

"When the opposing elements reside within me in unison, the need for war shall no longer be necessary."
(oil + water)

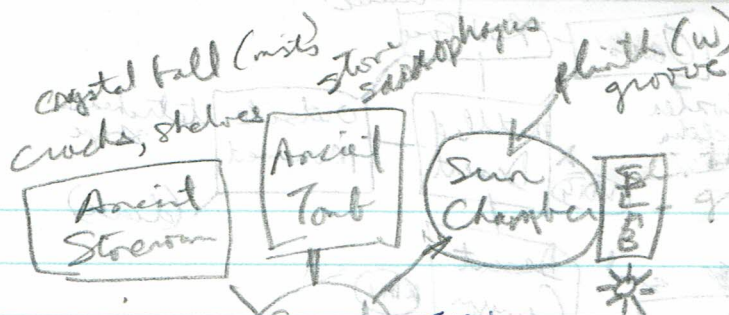

statue of bowl (W)
silver sword (W)
"Power be given to those who be chosen."

TURN column

(incomplete) eye socket
statue (W)

"When the great enemy rises to do battle within, & the eye of pure gold is held in the path of the enemy, the ancient tomb shall be opened for all to see."

use watch as light source

"Within here be the resting place of the yellow keystone of time."

(slab)
gold sphere
glass cone
plaque (W)
clan it (dust)
tetrahedral topaz

gold sphere may: man in jewelry, created 4 keystones; I must find them & "seek out the center". There, I must destroy a weapon that can destroy all of time.

crystal ball is size of eye socket
tray fits in plinth; so does disc
oil + water in bowl, burn oil c lighter (Fire + water)

plaque: "In the presence of power, & the symbol & word of authority, the eye shall be given to the champion of time."

draw [shape] on slab (not line, or triangle)
CIRCLE

- roof opens, light hits disc, 4 beams of color [red, yellow, green, blue]
- put ball in yellow beam. => yellow ball
- put yellow ball in eye socket [click]
- break disc, put tray in plinth (reflects to see)
- turn column (metal one underneath)

TIME: ALL THINGS
COME TO AN END
tatctae. 28

Prologue: Breakthrough

Release 7/
Serial # 970521
(C) 1996, Andy Phillips

stat. @ Laboratory {nil} panel, red button, platform
- workbench, papers, translocation machine

U: Roof / N: Storeroom / S: not leaving
move paper [+1] (find & take notebook) eg: CONSULT NOTEBOOK AOR

topics: "Time Translocation Project", "DigiCorp Technologies"

@ Storeroom: shelf (screwdriver, cable), triangular picture frame
3m, base of Gustav Brock III

@ Lab: unscrew panel & screwdriver
x source (round, has opening for a connector)
take source [+1]

@ Roof (wire)
Connect cable to source. drop source. connect cable to wire. [+1]
take source

@ Lab: fit source in depression. (don't bother closing panel)
push red button (hole appears)
enter hole [+1]

Chapter 1: The Xeron Project

- in Garbage Bin (possessions lost) hole in walls, rubbish
- man named Carpenter is fearful; another man threatens
- security of complex is foolproof
- high pitched whine, then silence (C dies). Figure in leather & helmet bends over him.
- Something is tossed into bin; you hear a motor fade away.
- (gun) take gun. Search garbage (find newspaper) take newspaper
- x newspaper (date is July 20, 2065)

Alley - corpse, jacket; triangular badge "T1"
search jacket - C speaks to you. (Stop project Xeron. The keystones.
Key to apartment, hidden down in the car.)

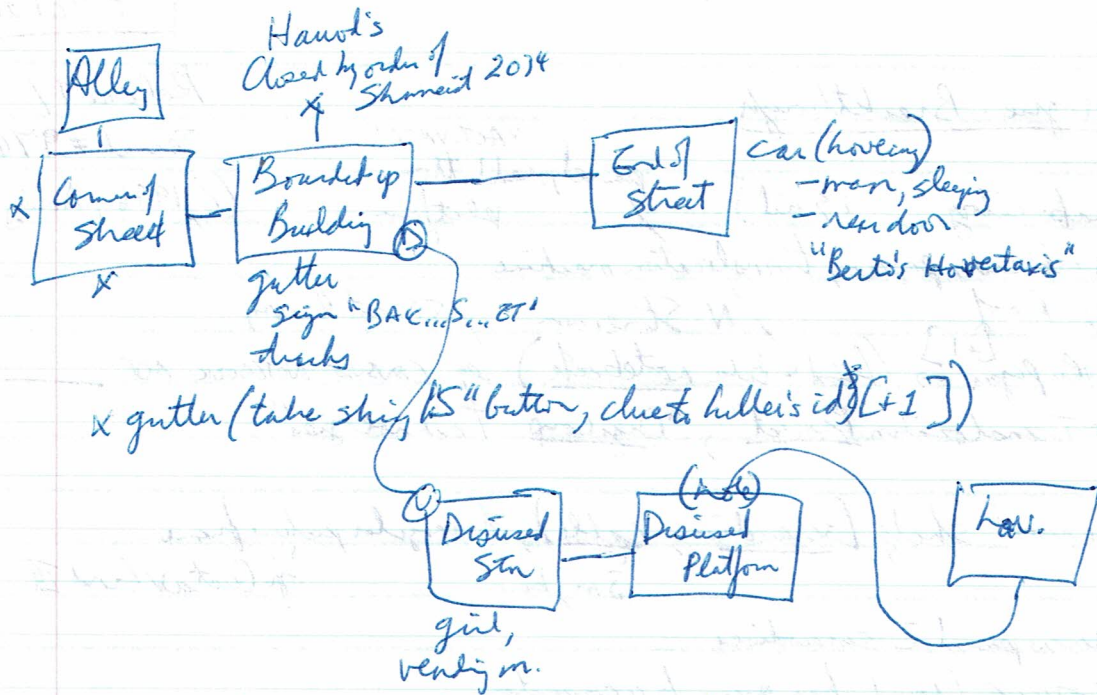

as enter lavatory, girl i glowing knife threatens you.

point gun at girl [+2]

girl, drop knife (she flees)

take knife [+1]

open toilet (taking plastic bag) "Olma's"

open bag - 10 card, metallic disc, pee of paper

← Carpenter, K.D., Address: Gerants Heath Estate, Place of Work: Trion Institute.

disc: "KDC" / paper - all important stuff is at apt.

x pipe. take pipe [+1]

x knife (dull, not glowing, handle)

@ D. Str. post machine twice

(drop newspaper.) take gun [+1]

@ items mix

take disc [+1]

@ End of Street knock on door. open door. enter car [+1]

close door. driver, drive to gerants.

give disc to driver [+1]

Housing Gate) U/W: Front of Hse
NE: Side of Hse

Front of Hse: door, slit, window (door mechanism disabled)

Side of Hse: rope fence & wire top
then handle (of knife)

cut fence & knife; cut fence & knife (taking rope)

W → Backyd (platform high abv you)

[tie rope to pipe. throw pipe at platform] fails to work

kick pipe.. tie rope to pipe. throw pipe at platform. U. [+1]

take rope [+2] open window. S.

→ Carpenter's Apt

device/bomb, globe, wallpaper, tens, door

x device (green + red bttns, red legs)

close duty window. (searchlight on; but it's pitch dark!)