

Windhall Chronicles

People: Mayor Mielon, Sir Gunther, Borther (smith), Denzil (wood elf), Kytan (thief), Idah (Mielon's wife), Midnight (fighter), Baerzil (baker), Creston (cleric), Nostrophidius (wizard), Kaeda (N's stepdaughter), and you (Aerin)

Other topics: Lord Osrich, dragon Kitzith. i {shovel (from D to dig treasure)} push (rod)
Midnight wants to rest in forest SE of town.

The path to Fortune
Whose one of "The Windfall Chronicle?"

Time advances ~3 min per turn?
no ABOUT
i - limit
rub stone with _ ?

dig with shovel
→ it breaks.
take head.
ask borther abt head
(he asks for piece of wood to repair it into)

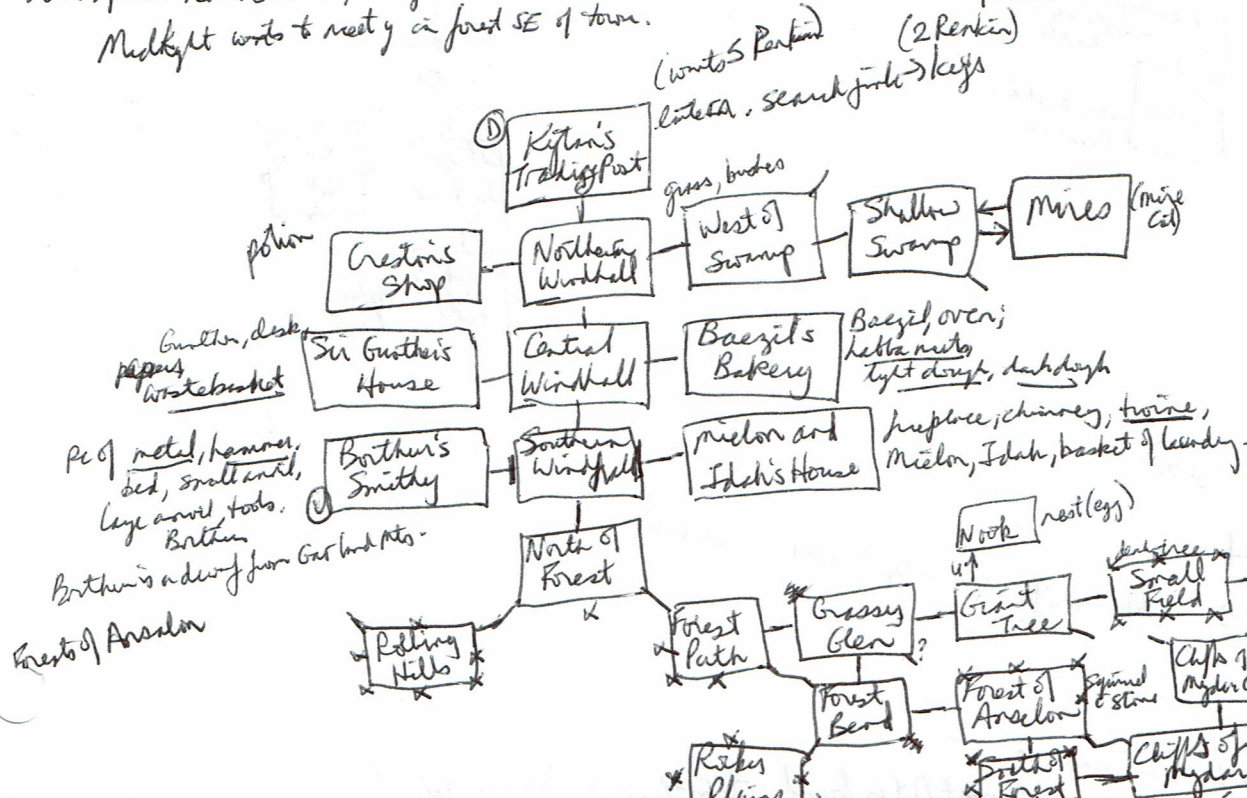

ask Baerzil abt (oven, light dough) mold light dough into roll (+1), mold dark dough into tube (+1), take nuts (+1).
ask Kaeda (she has a sweet tooth) abt Idah (has stories) // ask G abt Gunther, Ryzsch // ask B abt realm (Mercedal Empire, Anselith) {Windhall is a town in Ryzsch realm, northwest in Mercedal Empire, on eastern border of Anselith Continent}
abt metal (a plate? thin like metal just) abt Garland Mts (NW, opposite of Tyria range) // ask Idah abt realm (1 of 2 ways around Tyria)
abt swamps (ghosts, creatures, snakes, flight) // give nuts to squirrel, take stone (+1) {ants eat ~1pm}
// Cliffs of Mydar east of S of F? [Kaskapada Mts] {Mydar Ocean}

black arrows with head

monst:
Sclaria
& Lupatia
(night is 13 hrs long)

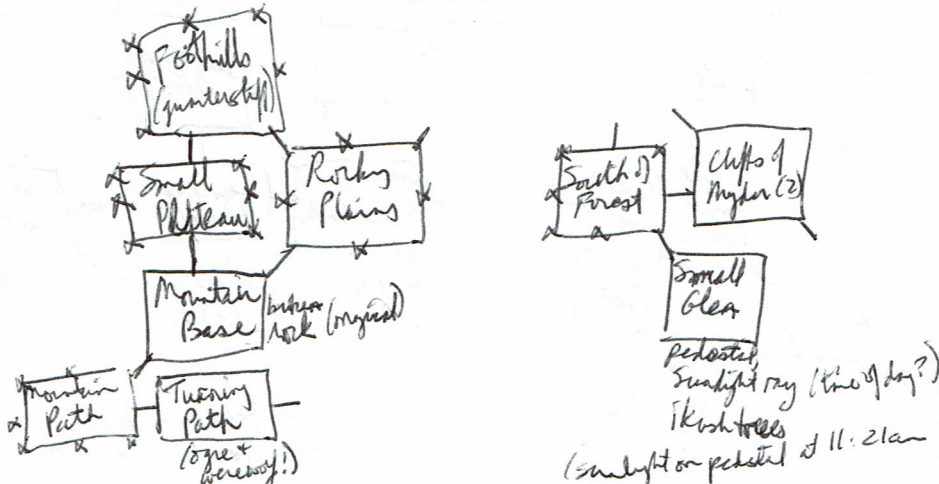

tie twine to staff (it slides off; wood is too smooth; encourage to keep it at)

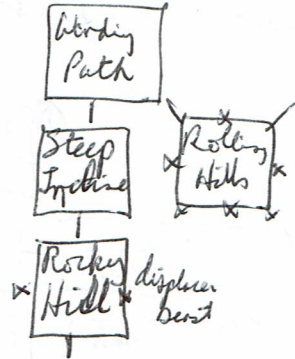
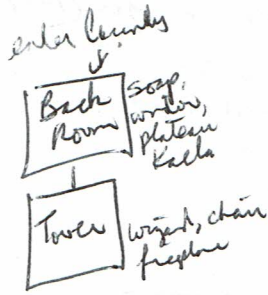

ask wizard abt rope (Text >>)

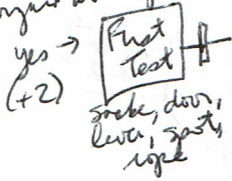

take rope. put rope in spot. (on the end to lever)

Mine Cat offers gold for riddle answer.

"Lots of human beings ponder this thought / It is found within the center of each leaf. / For an inquiry 'tis infinite yet simple / Except if questioned is a double-bladed knife" say if ✓ (+6)

ask cat abt gold (architect i light) take gold nugget. ask cat abt swamp pits cat

is (new riddle; answer or blank!) "Tis between Salvation's zenith & the fiery Seven Hells, / E'er feeding off the incandescent sun, / Yet the unique view of it / Is that, while one dome is lit, / The glow upon the other's not begun." say word (+4; path rises out cat) "Adventure is inevitable."

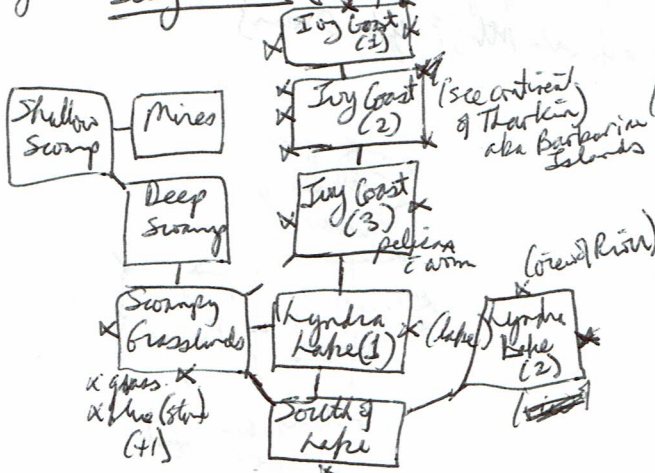
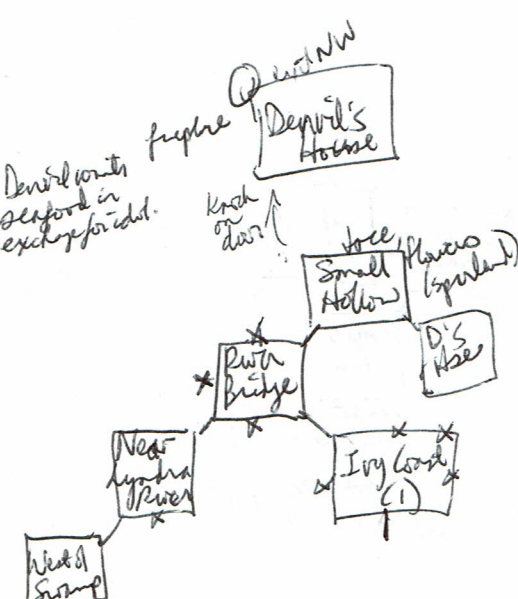

(do we need about? to go last)

DON'T climb any @ Ivy Coast (1) there's a skeleton. Search vines → boneway. (+1)

Lyndra lake has a fable abt lovers of and quite romantic.

ask Devil abt Lyndra River (fisher clothes there) ask elf abt Blea (suspicious using a lens)

