

Crystal skull
map

- 20 1 trunk
- 2 emerald (in bag)
- 3 trident
- 4 bird's egg
- 5 ceram
- 6 (bottle)
- 7 scorb
- 8 necklace (pend)
- 9 art
- 10 crystal ball
- 11 chalice
- 12 torch
- 13 diamond
- 14 bag of coins
- 15 coffin
- 16 pot of gold
- 17 platinum bar
- 18 sceptre
- 19 jade figurine
- 20 sapphire bracelet

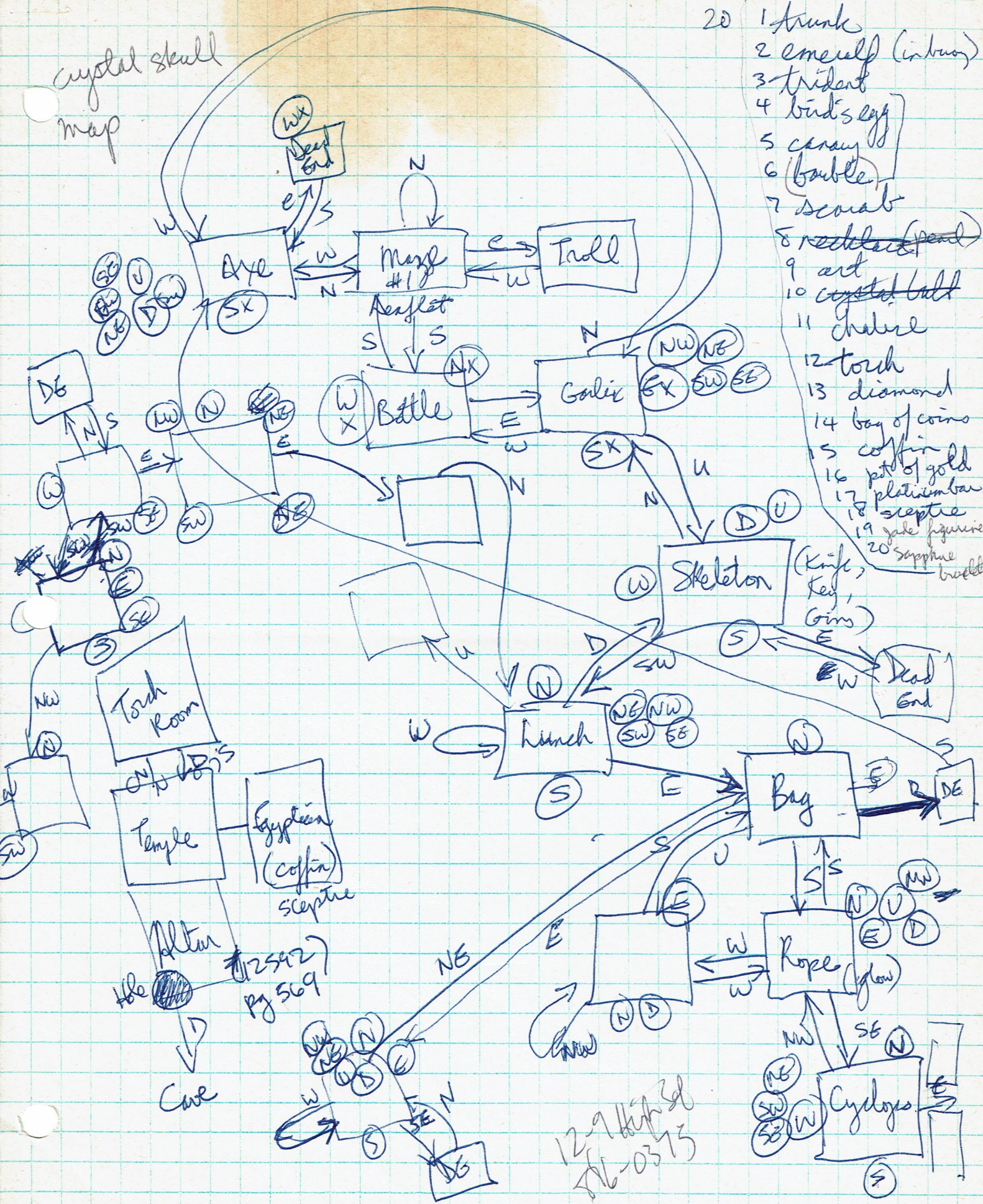

12-9-88
76-0375

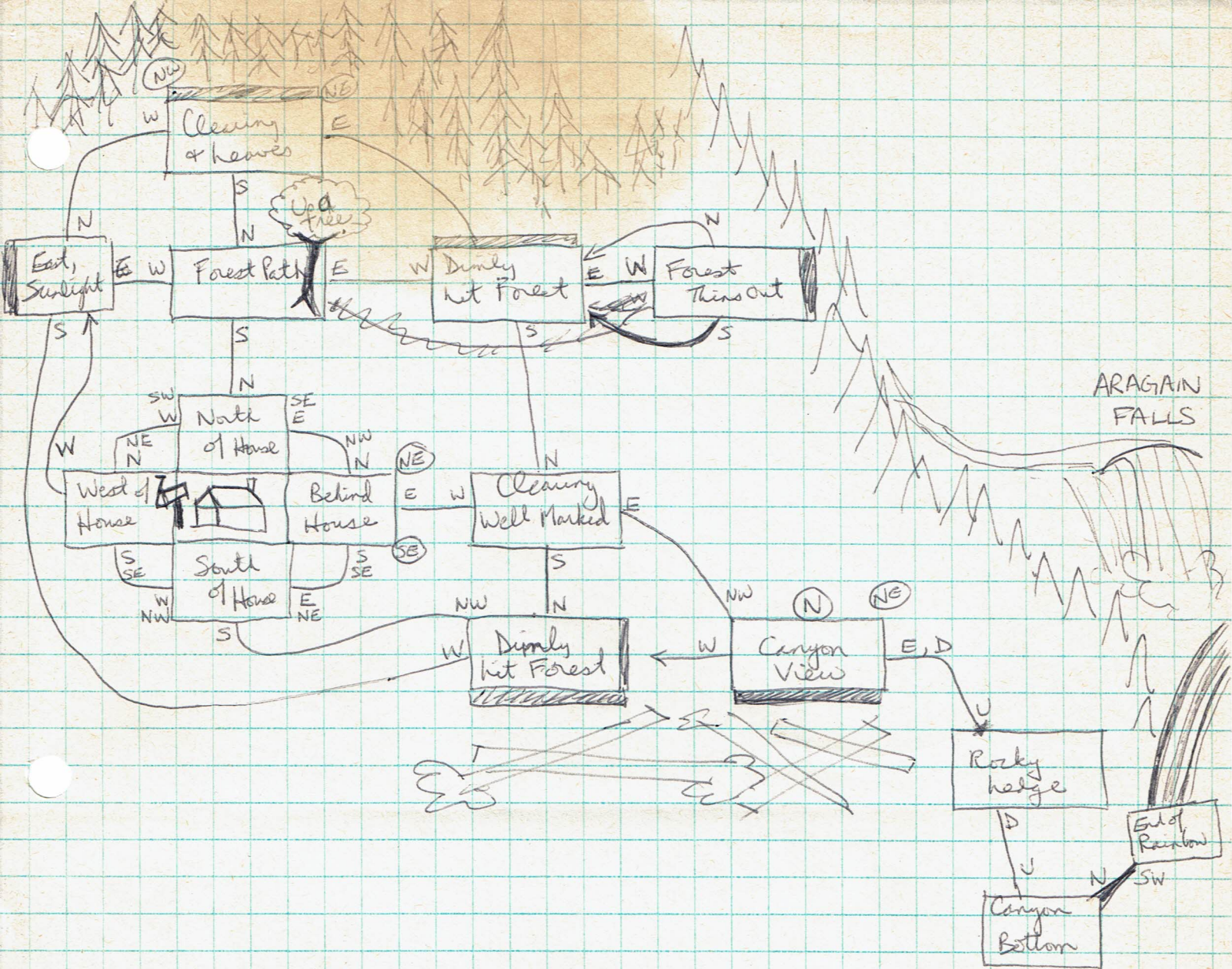

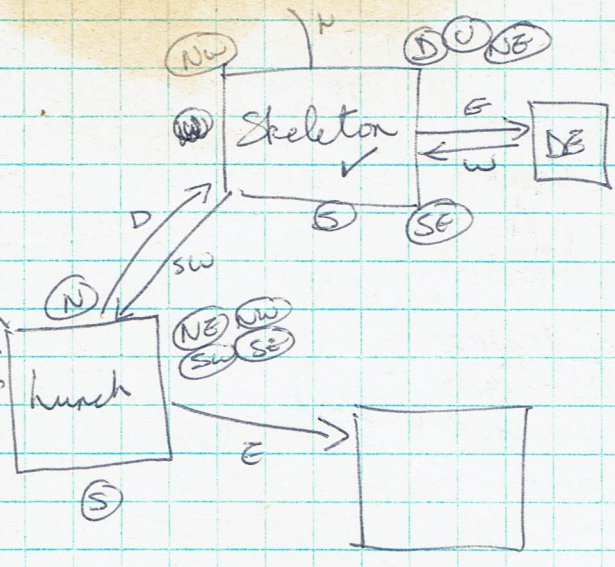
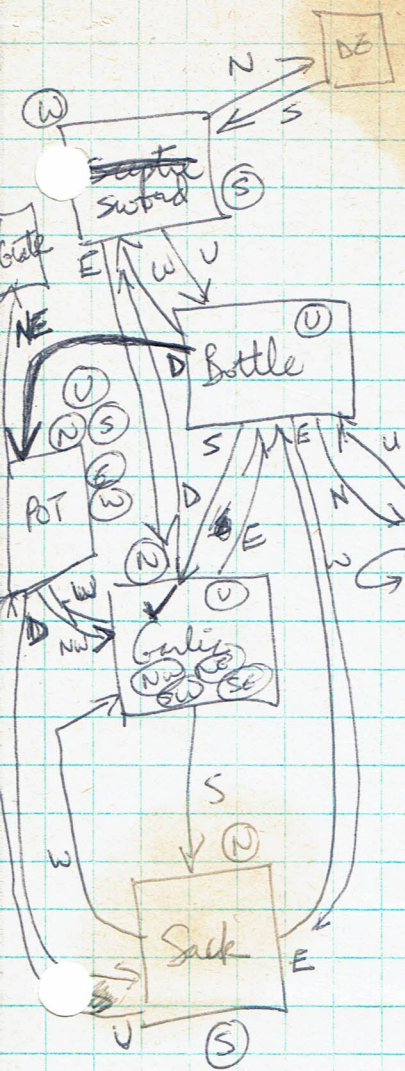

~~LEAF~~
~~SWORD~~
 REPE → ~~FORCE~~
~~SCYTHRE~~
~~POT~~
~~SCARAB~~

sword
 in egg
 sword

- ~~ART~~
- ~~CONDS~~
- ~~EGG~~
- ART ✓
- BAR ✓
- COINS ✓
- ~~LOW~~ water ✓
- ~~EX~~ course spirits

(thief has egg & torch)

- TRIDENT ✓
- TRUNK ✓
- EGG ✓
- CANARY ✓
- 11 BRUBLE ✓
- 12 CHARICE ✓
- 13 COFFIN ✓
- 14 JADE
- 15 DIAM
- 16 TORCH
- 17 BRACE ✓
- 18 EMERALD
- 19 Crystal skull
- 20 MAP

gaulis
 torch
 long
 sword
 coal → jade
 bracelet
 diamond
 emerald
 coffin
 torch

256 pts
 313 pts
 330 pts

boat pump (glue)

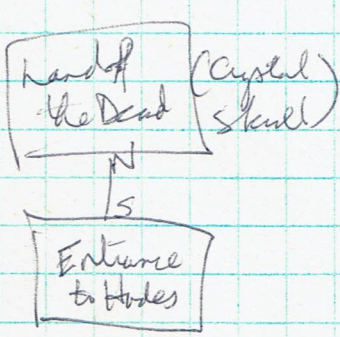

"Look to your treasures for the final secret"

(509 moves)

Front
of
House

SW (SECRET
PATH
TO
STONE BARROW)



(2000-1991)

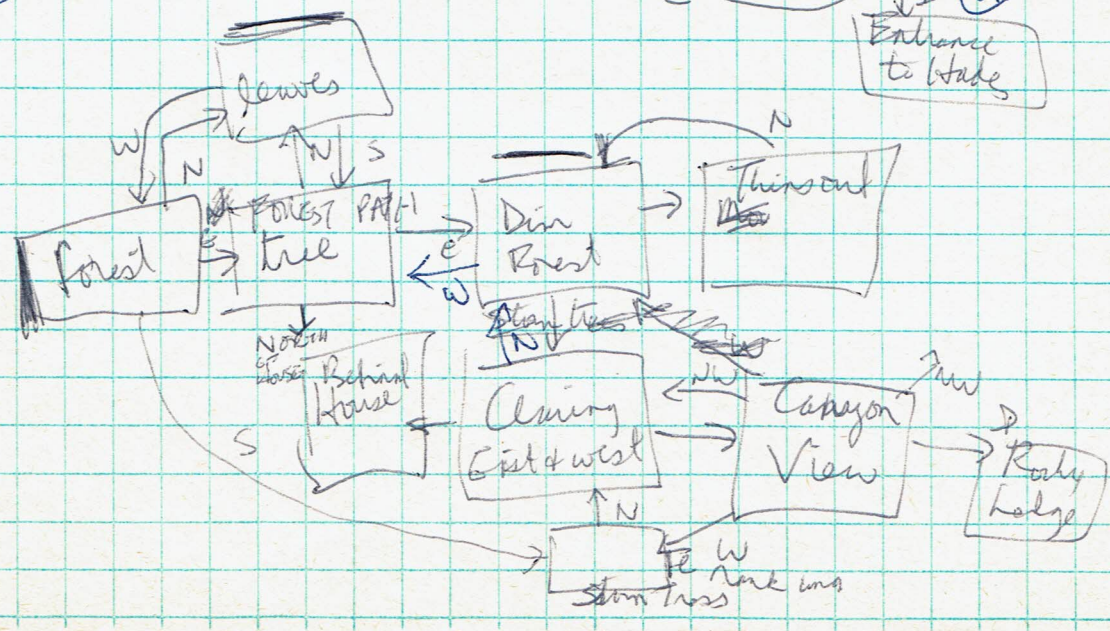
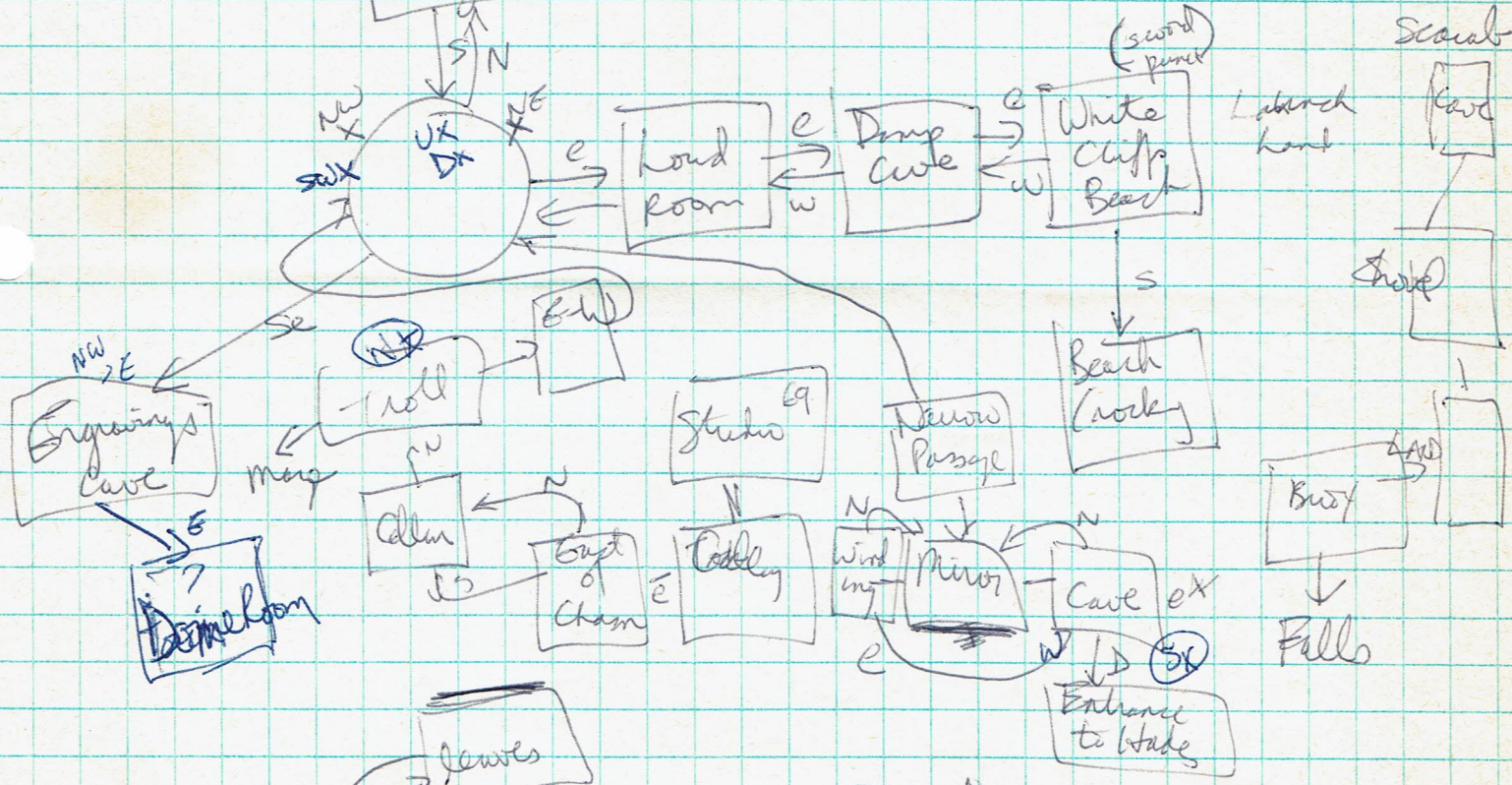
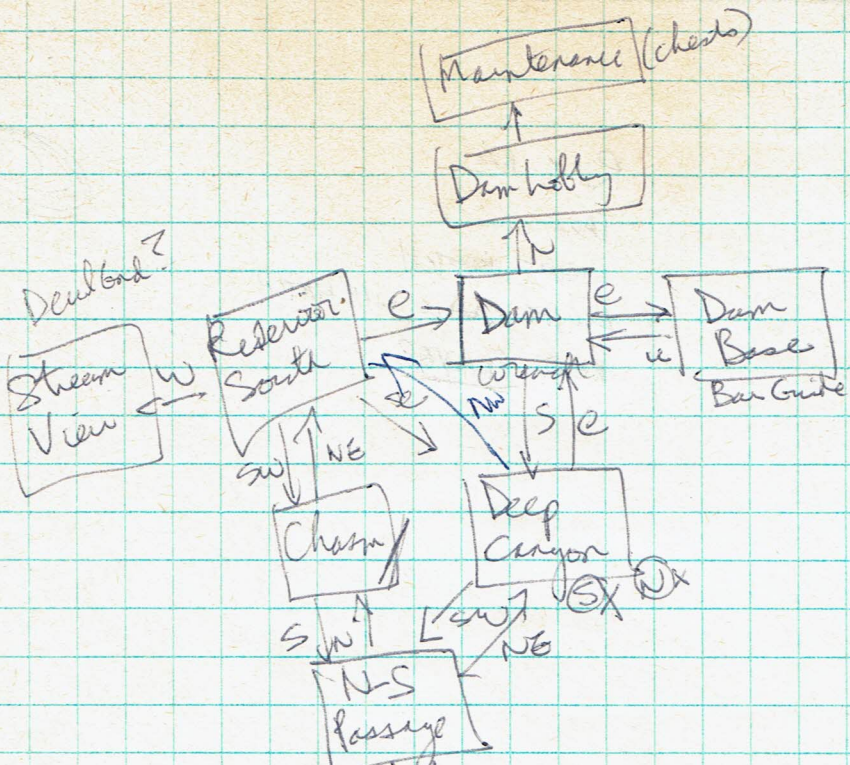
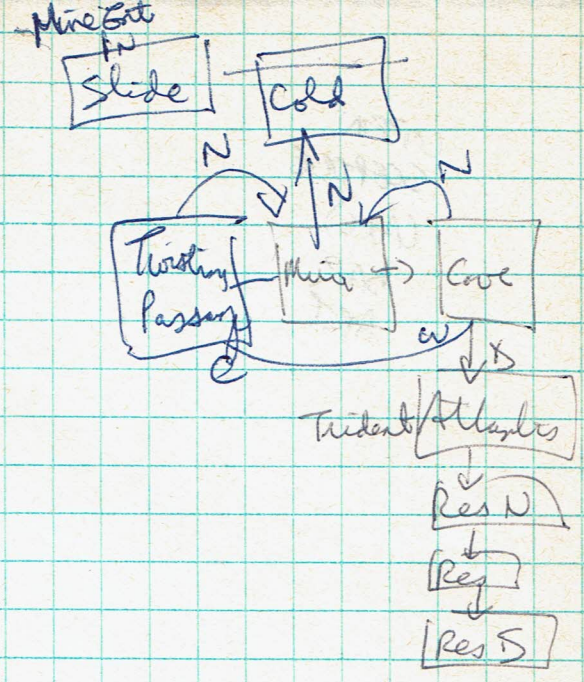

COPPIN
SCEPTRE
(AXE)
BAR
ART

RING BELL
TAKE CANDLE
LIGHT MATCH
LIGHT CANDLE WITH MATCH
READ PRAYER



Green	Blue	Yellow	Red	Orange
H	G	L	I	N
E	P	D	O	C
R	E	S	A	T

LINER
DINER
PLATE
RINGS
SINGE

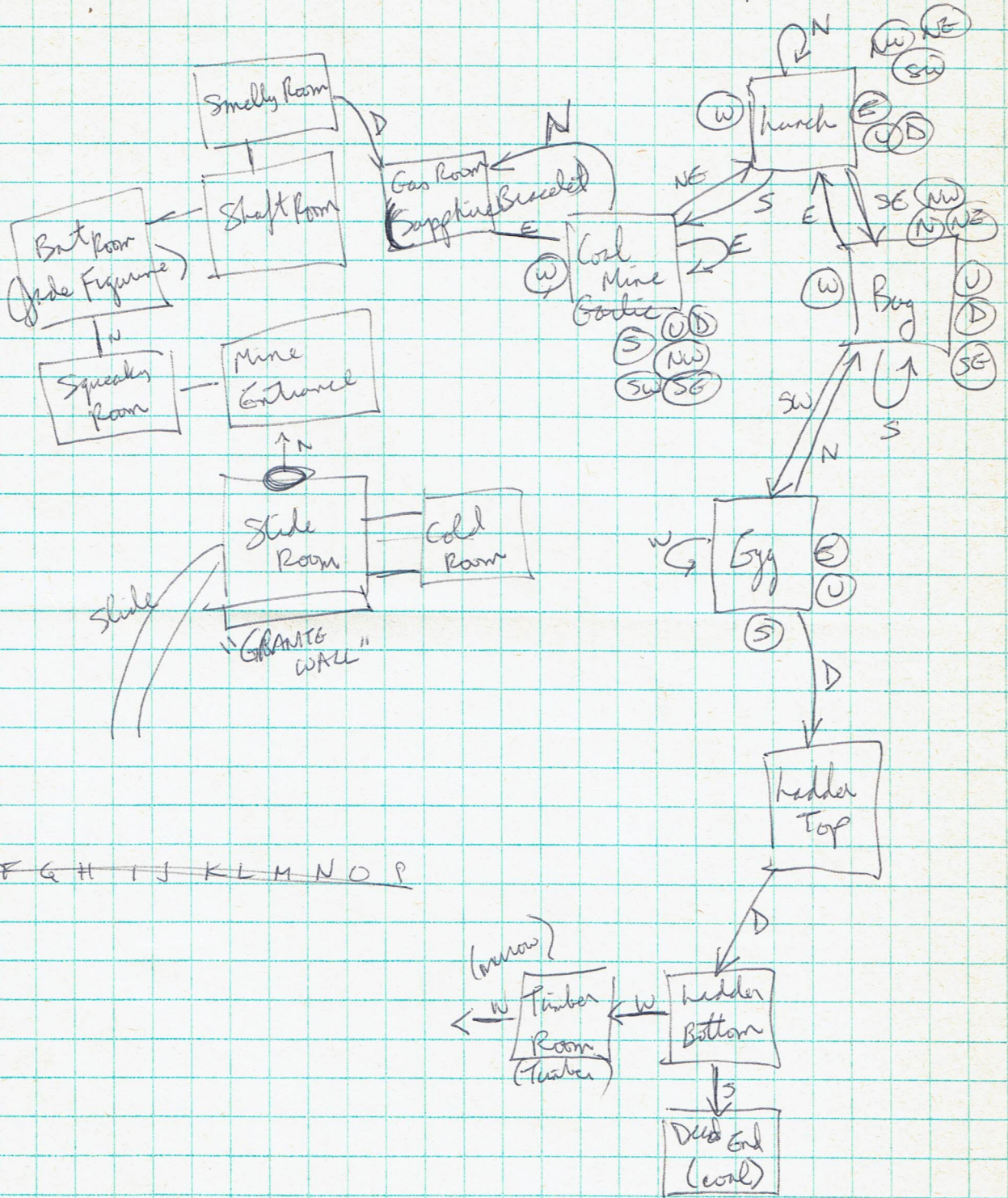

~~A B C D E F G H I J K L M N O P~~